

AS-BUILT LOCATION

BUILDING PERMIT PLAT

UNIT 5
SOUTH SHORE CLUB ON LAKE GENEVA
A CONDOMINIUM
REC. IN CAB. A, SLIDE 394, DOC. NO. 500527

LOCATED IN CERTIFIED SURVEY MAP 2631
RECORDED IN VOL. 13 OF CERTIFIED SURVEYS
ON PAGE 171, AS DOCUMENT NUMBER 311927
BEING IN ALL 1/4'S OF NE 1/4 OF
SECTION 18, TOWN 1 NORTH, RANGE 17 EAST
WALWORTH COUNTY, WISCONSIN

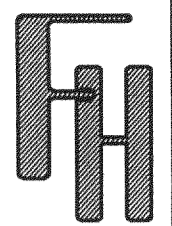
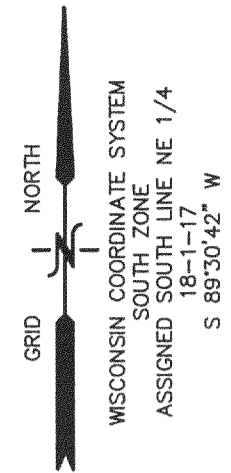

WORK ORDERED BY -
KEVIN BATZ - ORREN PICKELL
200 TRI-STATE INTERNATIONAL, SUITE 200
LINCOLNSHIRE, WI 60069

FARRIS, HANSEN & ASSOCIATES, INC.
ENGINEERING - ARCHITECTURE - SURVEYING
7 RIDGWAY COURT P.O. BOX 437
ELKHORN, WISCONSIN 53121
OFFICE: (262) 723-2098 FAX: (262) 723-5886

REVISIONS
11/23/2004
TO SHOW SIZE
& LOCATION OF
AS-BUILT
FOUNDATION

PROJECT NO.
4161.05
DATE:
09/17/04
SHEET NO.
1 OF 1

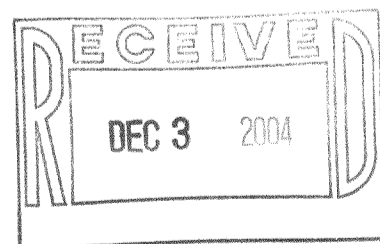

NOTE: COPIES OF THIS MAP TO WHICH THE FOLLOWING CERTIFICATE WILL APPLY SHOW
SURVEYOR'S ORIGINAL SEAL AND SIGNATURE IN RED INK. COPIES BY ANY OTHER MEANS
MAY HAVE ALTERATIONS WHICH DO NOT REPRESENT THE SURVEYOR'S WORK PRODUCT.

I HEREBY CERTIFY THAT THE ABOVE DESCRIBED PROPERTY HAS BEEN SURVEYED UNDER MY
DIRECTION AND THAT THE ABOVE MAP IS A TRUE REPRESENTATION THEREOF AND SHOWS THE
SIZE AND LOCATION OF THE PROPERTY AND ITS EXTERIOR BOUNDARIES. THIS SURVEY IS
MADE FOR THE USE OF THE PRESENT OWNERS OF THE PROPERTY, AND ALSO THOSE WHO
PURCHASE, MORTGAGE, OR GUARANTEE THE TITLE THERETO WITHIN ONE YEAR FROM THE DATE
HEREOF.

DATED: SEPTEMBER 17, 2004

Peter S. Gordon
PETER S. GORDON R.L.S. 2101

*Revised 11/23/2004
To show AS-BUILT
Foundation*

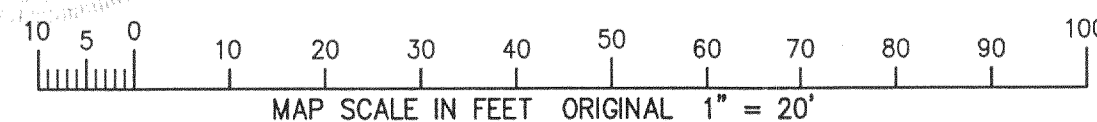
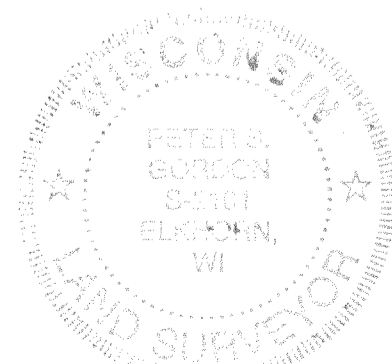

11/23/2004 X:\Projects\4161\ASBLI_05

NOV 23 2004

ISSC 00005

117-2494