

ABELL
SURVEYING & MAPPING

1140 SEQUOIA STREET • DELAVAN, WISCONSIN 53115
262-728-6737

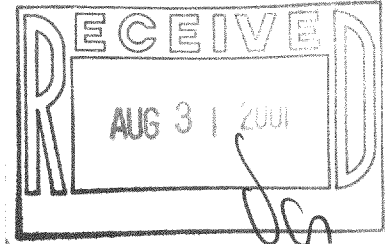

PLAT OF SURVEY OF

LOT 2, CERTIFIED SURVEY MAP NO. 1803, LOCATED
IN THE NORTHEAST 1/4 OF SECTION 18, T1N. R17E,
WALWORTH COUNTY, WISCONSIN.



SCALE 1"=50'

LEGEND

- Ø - IRON PIPE FOUND
- ⊗ - IRON ROD FOUND
- △ - UTILITY POLE
- WP - WOOD PORCH
- () - RECORDED AS

NOTE: BEARINGS ARE REFERENCED TO
CERTIFIED SURVEY MAP NO. 1803.

DETAIL SCALE 1"=30'

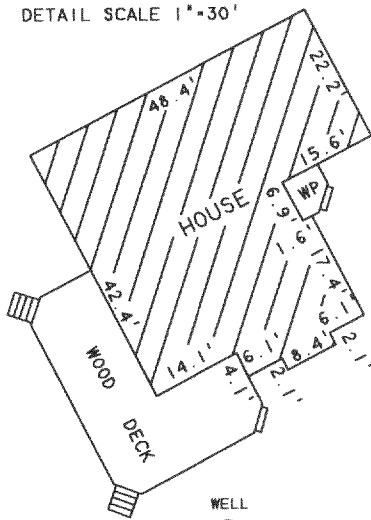

SEE DETAIL ABOVE FOR
HOUSE DIMENSIONS

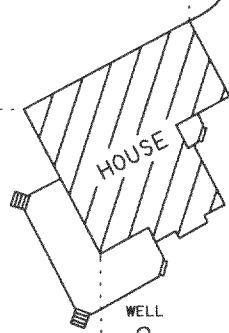

LOT 2
2.40 ACRES

BLACKTOP
DRIVE

BASSWOOD DRIVE

I HEREBY CERTIFY THAT I HAVE SURVEYED THE ABOVE DESCRIBED PROPERTY AND THAT THE
ABOVE MAP IS A TRUE REPRESENTATION THEREOF AND SHOWS THE SIZE AND LOCATION OF
THE PROPERTY, ITS EXTERIOR BOUNDARIES, THE LOCATION OF ALL VISIBLE STRUCTURES
AND DIMENSIONS OF ALL PRINCIPAL BUILDINGS THEREON, BOUNDARY FENCES, APPARENT
EASEMENTS, ROADWAYS AND VISIBLE ENCROACHMENTS, IF ANY, TO THE BEST OF MY
KNOWLEDGE AND BELIEF.

THIS SURVEY IS MADE FOR THE USE OF THE PRESENT OWNERS OF THE PROPERTY, AND ALSO
THOSE WHO PURCHASE, MORTGAGE, OR GUARANTEE THE TITLE THERETO WITHIN ONE (1) YEAR
FROM DATE HEREON.

David F. Abell

DAVID F. ABELL
WISCONSIN REGISTERED LAND SURVEYOR, S-1596

May 9, 2001

DATE JOB NUMBER - 01042
NOTE: THIS IS NOT A CERTIFIED COPY UNLESS SEALED.

ORDERED BY: RE/MAX GENEVA REALTY, LTD.
101 BROAD STREET
LAKE GENEVA, WI 53147

IA-1803-2

117-2026