

Plat of Survey

of Lot 3 of Certified Survey Map No. 675,

recorded in Vol. 3 of Certified Survey Maps of Walworth County on Page 164, located in the Northeast 1/4 of Section 5, Town 1 North, Range 17 East, Town of Linn, Walworth County, Wisconsin.

Surveyed for: **Paul J. Proteau**
115 South Marion Street
Oak Park, Illinois 60302

Note: The proposed garage is shown as instructed by the owner. All setbacks must be approved by the building inspector PRIOR to construction.

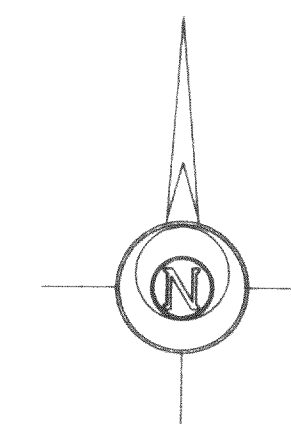

Bearings referenced to Certified
Survey Map No. 675.

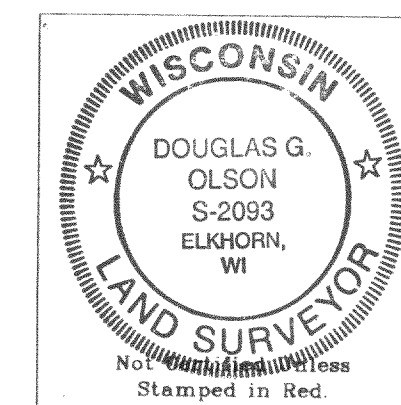

- Notes: 1) This survey plat is not certified unless signed and sealed in red ink.
- 2) This survey is subject to Wisconsin lien laws. This Plat of Survey is the notice of intent to file lien. Lien waiver required.

Copyright © 2000 by Jensen & Olson Land Surveying, LLC.

All rights reserved. No part of this survey plat may be reproduced or transmitted in any form by any means - graphic, electronic, or mechanical, including photocopying, tracing, or information storage and retrieval systems - without permission in writing from Douglas G. Olson, Jensen & Olson Land Surveying, LLC.

I, Douglas G. Olson, Wisconsin Registered Land Surveyor, do hereby certify that this survey was performed by me or under my direction in full compliance with the owner's/agent's instructions and Chapter A-E 7 of the Wisconsin Administrative Code "Minimum Standards for Property Surveys", and that this map is an accurate representation thereof to the best of my knowledge and belief.

Douglas G. Olson
Wisconsin Registered Land Surveyor - 2093

Survey Date: April 25, 2000.
Revisions:

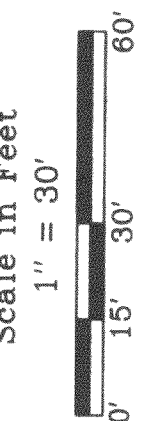

Jensen & Olson Land Surveying, LLC
45 South Wisconsin Street P.O. Box 322
Elkhorn, Wisconsin 53121
Telephone (262) 723-3434
Facsimile (262) 723-8044

Legend

- Found Concrete Monument
- Set Iron Rod, 3/4" dia.
- Recorded Information
- Utility Pedestal
- Concrete Cover
- Asphalt Surface
- Set Wood Stake

Sheet 1 of 1 Sheets
Job Reference Number
2000.040

2000.040

IA-675-3

117-1881