

ABERNATHY and ASSOCIATES

Kenneth B. Abernathy Jr.

Wisconsin Registered Land Surveyor S-1594

Rt. 3, Box 273
Elkhorn, Wisconsin 53121
Phone: (414) 723-4260 (office)
(414) 723-7209 (FAX)

PLAT OF SURVEY

LOT 1 OF CERTIFIED SURVEY MAP
NO. 2027 AND A LOT LINE
ADJUSTMENT LOCATED IN SECTION
14, TOWN 1 NORTH, RANGE 17
EAST, WALWORTH COUNTY,
WISCONSIN.

ORDERED BY: SCHAUDER BUILDING, INC.
4115 HIGHWAY 51 NORTH
JANESVILLE, WISCONSIN
53545-9674

OWNERS: DAVID and AMANDA GEILS
1206 3RD. ST.
MCHENRY, IL. 60050

REFERENCE DEED:

VOL. 517 P. 471
DOC. NO. 210103

LOT LINE ADJUSTMENT 1.65 ACRES

(B.W. SURVEYING DATED DEC. 18,
1997)

LOT 1 C.S.M. # 2027

VOL. 9 PAGE 333
DOC. NO. 209744

(WALWORTH COUNTY SURVEYING AND
MAPPING DATED APRIL 9, 1991.)

THE GRAIN BINS SHOWN ON THE
ORIGINAL CERTIFIED SURVEY MAP
WERE NOT LOCATED DURING THE
COURSE OF THIS SURVEY BY
AGREEMENT WITH THE CLIENT.

(N 89°34'35"W ON LEGAL)

(131.80')

S 89°35'22" W 530.26'

(S 89°34'35"W 530.07')

W I L L O W

N 89°34'35"E 530.07'

R O A D

SECTION LINE PER FOUND WALWORTH COUNTY MONUMENTS
N 89°29'30"E 2646.96'

CENTER OF SECTION 14

W. 1/4 CORNER
SEC. 14-1-17

(N 89°31'35"E AS PER LEGAL)
N 89°34'35"E 1655.00'

131.80'

(530.07')
530.08'

SECTION LINE AS PER C.S.M. # 2027

EXISTING
RESIDENCE

(FOUNDATION COMPLETED)

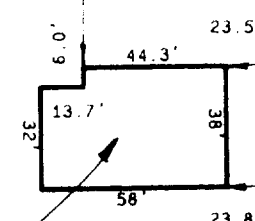

FOUND IRON PIPE IS S 28°54'32"E
4.48' FROM SECTION CORNER

40.1 P. 15.052'
N 62°03'40" OF
TRUE CORNER

(S 1°21'25" E 547.09')
506.00'

SCALE 1" = 60 FEET

Legend

- (X) FOUND IRON PIPE
- (●) FOUND IRON ROD
- (□) FOUND BRASS CAPPED MONUMENT
- (●) FOUND CONCRETE MONUMENT
- (+) CHISEL CUT IN CONCRETE
- (●) SET IRON ROD, 24" LONG, WEIGHING
1.5 LBS./LINEAL FT., 3/4" DIA.
- (●) SET IRON ROD, 30" LONG, WEIGHING
4.5 LBS./LINEAL FT., 1-11/16" DIA.
- (XX) RECORDED AS DIMENSION
- X--- EXISTING FENCE

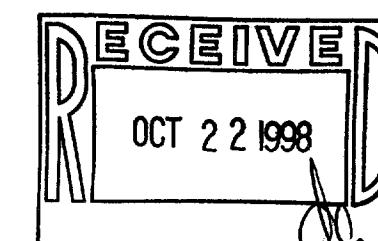

SCALE: 1" = 60 FEET

"I hereby certify that the above described property has been surveyed
by me or under my direction and that the above map is a true
representation thereof and shows the size and location of the property, its
exterior boundaries, the location of all visible structures and dimensions of
all principal buildings thereon, boundary fences, apparent easements,
roadways and visible encroachments, if any."
"This survey is made for the use of the present owners of the property,
and also those who purchase, mortgage, or guarantee the title thereto within
one year from date hereof."

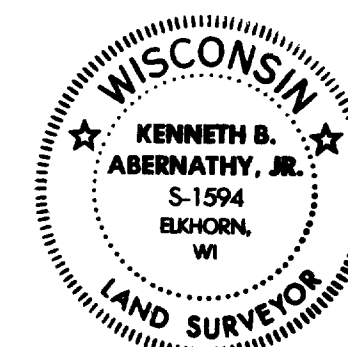

Kenneth B. Abernathy, Jr.
KENNETH B. ABERNATHY, JR.
WISCONSIN REGISTERED LAND SURVEYOR,
S-1594
Date: OCT. 5, 1998 Job No. 98.1001

117-1753
JA-2027-1