

ABERNATHY and ASSOCIATES

Kenneth B. Abernathy Jr.

Wisconsin Registered Land Surveyor S-1594

Rt. 3, Box 273

Elkhorn, Wisconsin 53121

Phone: (414) 723-4260 (office)

(414) 723-4813 (residence)

## PLAT OF SURVEY

THE WEST LINE OF LOT 10, LORAMOR SUBDIVISION, WALWORTH COUNTY, WISCONSIN.

GENEVA LAKE



F.I.P. is 0.18' EAST of true line  
1' deep

### NOTES:

- 1) Underground Utility Lines along Property Line.
- 2) Downed Wire Fence along Property Line.

F.I.P. is 0.16' WEST of true line

LOT 10

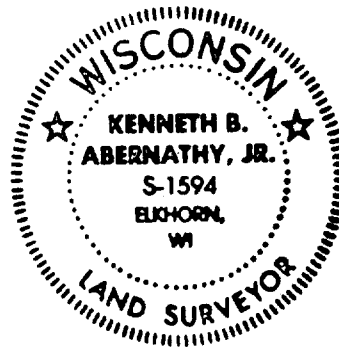
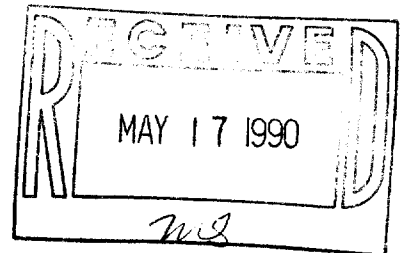

### Legend

- FOUND IRON PIPE
- FOUND IRON ROD
- FOUND BRASS CAPPED MONUMENT
- FOUND CONCRETE MONUMENT
- CHISEL CUT IN CONCRETE
- SET IRON ROD, 24" LONG, WEIGHING 1.5 LBS./LINEAL FT., 3/4" DIA.
- SET IRON ROD, 30" LONG, WEIGHING 4.5 LBS./LINEAL FT., 1-11/16" DIA.
- (xx) RECORDED AS DIMENSION
- x-x- EXISTING FENCE

F.I.P. is 0.37' WEST of true line

F.I.P. is 0.55' WEST of true line  
(BENT)

SCALE: 1"=60' FEET

"I hereby certify that I have surveyed the above described property and that the above map is a true representation thereof and shows the size and location of the property, its exterior boundaries, the location of all visible structures and dimensions of all principal buildings thereon, boundary fences, apparent easements, roadways and visible encroachments, if any."

"This survey is made for the use of the present owners of the property, and also those who purchase, mortgage, or guarantee the title thereto within one year from date hereof."

*Kenneth B. Abernathy Jr.*

KENNETH B. ABERNATHY, JR.  
WISCONSIN REGISTERED LAND SURVEYOR,  
S-1594

Date: SEPT. 5, 1989 Job No. 89803

Tax # ILWL - 10

117-1007