

CEIVE
APR 18 1997

WALWORTH COUNTY
SURVEYING & MAPPING
P. O. BOX 1115
LAKE GENEVA, WISCONSIN
414-248-0505

MAIN ROADWAY

(N0°06'E 153.22')
153.49'

12' WIDE UTILITY EASEMENT

(S81°53'E 8.75')
8.51'

(N117°02'25"
115.3530')

19

(N81°00'E 176.62')
176.53'

103°26'30"

(N22°52'16"W 161.53')
161.53'

GENEVA
OAKS TRAIL

BLACKTOP DRIVEWAY

104°36'15"

65.8'

20

233.94'
(N53°18'E 233.34')

OUT-LOT 4

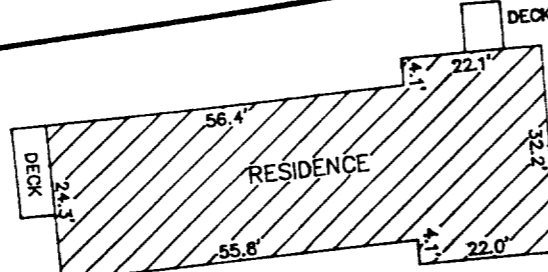

GRAPHIC SCALE



(IN FEET)

1 inch = 30 ft.

- ⊘-IRON PIPE FOUND
- ∅-IRON ROD FOUND
- CONCRETE MONUMENT FOUND
- IRON PIPE PLACED
- ()-RECORDED AS

PLAT OF SURVEY OF
LOT 20 OF GENEVA OAKS, A SUBDIVISION
LOCATED IN SECTION 4, T 1 N, R 17 E,
WALWORTH COUNTY, WISCONSIN.

ORDERED BY: KEEFE REAL ESTATE
704 MAIN STREET
LAKE GENEVA, WISCONSIN
53147

I HEREBY CERTIFY THAT I HAVE SURVEYED THE ABOVE DESCRIBED PROPERTY AND THAT THE ABOVE MAP IS A TRUE REPRESENTATION THEREOF AND SHOWS THE SIZE AND LOCATION OF THE PROPERTY, ITS EXTERIOR BOUNDARIES, THE LOCATION OF ALL VISIBLE STRUCTURES AND DIMENSIONS OF ALL PRINCIPAL BUILDINGS THEREON, BOUNDARY FENCES, APPARENT EASEMENTS, ROADWAYS AND VISIBLE ENCROACHMENTS, IF ANY, TO THE BEST OF MY KNOWLEDGE AND BELIEF.

THIS SURVEY IS MADE FOR THE USE OF THE PRESENT OWNERS OF THE PROPERTY AND ALSO THOSE WHO PURCHASE, MORTGAGE OR GUARANTEE THE TITLE THERETO WITHIN ONE (1) YEAR FROM DATE HEREOF.

Robert M. Baerenwald
ROBERT M. BAERENWALD
WISCONSIN REGISTERED LAND SURVEYOR, S-1508

Feb. 2, 1996
DATE JOB NO. 4903

NOTE: THIS IS NOT A CERTIFIED COPY UNLESS SEALED.

160-20

117-1635