

TOPOGRAPHIC MAP
-OF-

A PORTION OF THE PATRICK G. RYAN &
SHIRLEY ANN RYAN PROPERTY LOCATED IN THE
WEST 1/2 OF SECTION 3, TOWN 1 NORTH,
RANGE 17 EAST, TOWN OF LINN, WALWORTH
COUNTY, WISCONSIN.

ORDERED BY: WAYNE R. BRUNZELL, P.E.
BRUNZELL ASSOCIATES LTD.
WESTMORELAND BUILDING
9933 NORTH LAWLER AVE.
SKOKIE, ILL. 60077

CONCRETE DRIVEWAY AREA

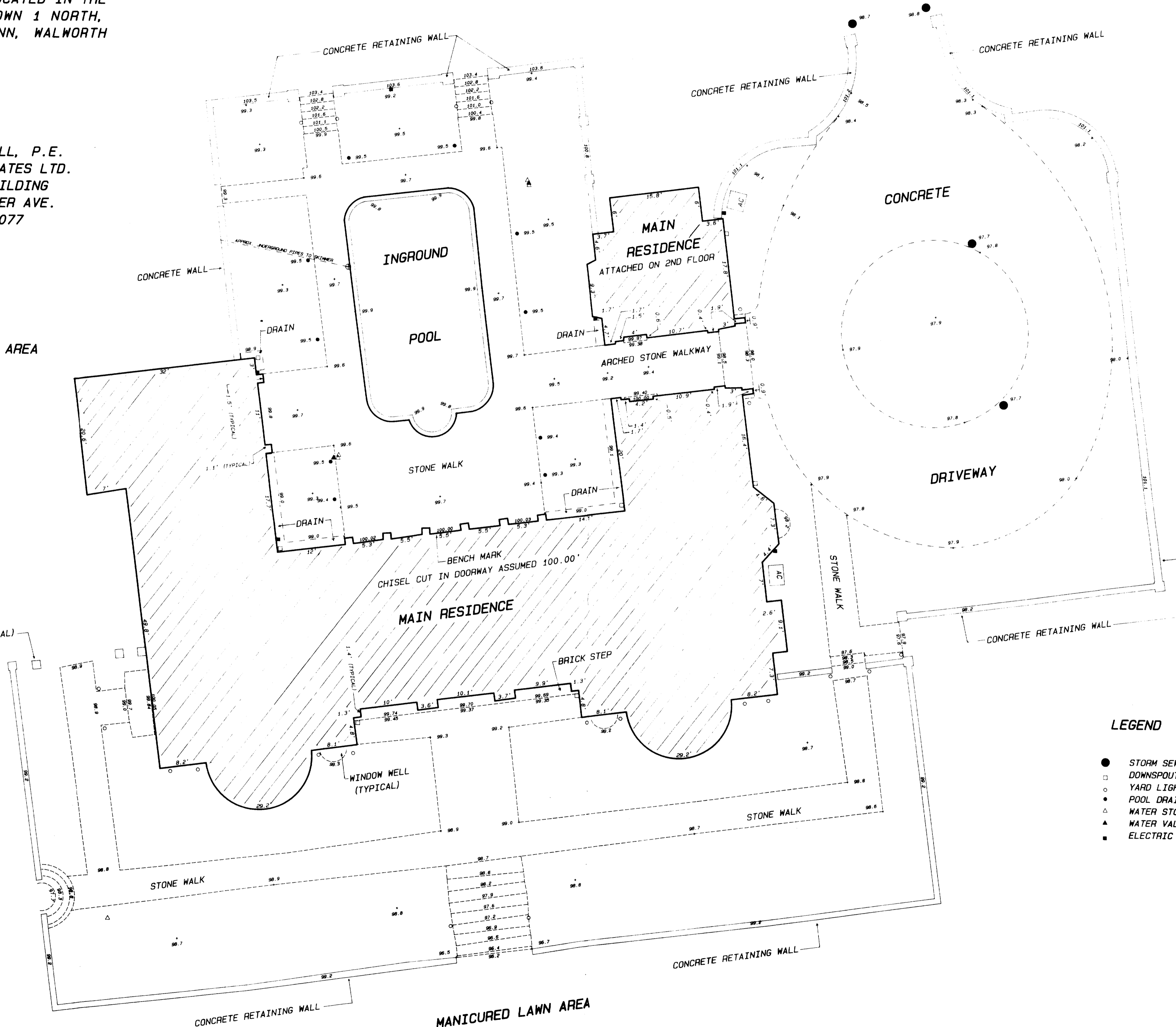

SCALE: 1 IN = 10 FEET

NOTE: ELEVATIONS ARE REFERENCED TO LOCAL DATUM WHICH ASSUMES THE FIRST FLOOR OF THE MAIN RESIDENCE AT A CHISEL CUT AS ELEVATION 100.00'.

LEGEND

- STORM SEWERS
- DOWNSPOUT
- YARD LIGHTS
- POOL DRAINS
- △ WATER STOP BOX
- ▲ WATER VALVE
- ELECTRIC BOX

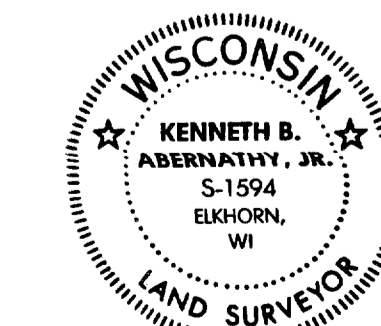
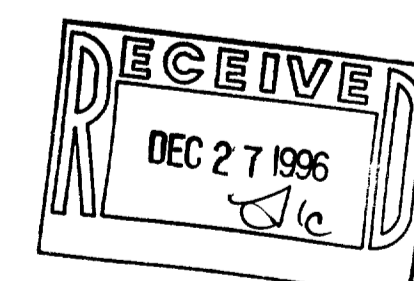

SCALE: 1" = 10 FEET

Kenneth B. Abernathy, Jr.
KENNETH B. ABERNATHY, JR.
WISCONSIN REGISTERED LAND SURVEYOR,
S-1594

Date: NOVEMBER 19, 1996 Job No. 96-1104

IF-5
IF-5A
1MA-1
1BB-1B