

of

recorded in Vol. 7 of Certified Survey Maps of Walworth County on Page 198 and located in the Southeast 1/4 of Section 7, Town 1 North, Range 16 East, Town of Walworth, Walworth County, Wisconsin.

As shown on Certified Survey Map No. 1560 dated December 8, 1986.	
Barn*	10,495 sq.ft.
Barn**	5,286 sq.ft.
Shed*	1,659 sq.ft.
Silo**	322 sq.ft.
Silo*	179 sq.ft.
Total	17,941 sq.ft.

Additional structures added after 1986.	
Milking Parlor	1,385 sq.ft.
"Breezeway"	1,186 sq.ft.
Lean to	2,772 sq.ft.
Movable "Barn"	387 sq.ft.
Movable Shed**	101 sq.ft.
Total	5,831 sq.ft.

Total area of all accessory structures currently on the property.	
Total	23,772 sq.ft.

Maximum total area of all accessory structures allowed on C-2 zoned parcel by zoning ordinance.
1-1/2% of net parcel area or 6,189 sq.ft.

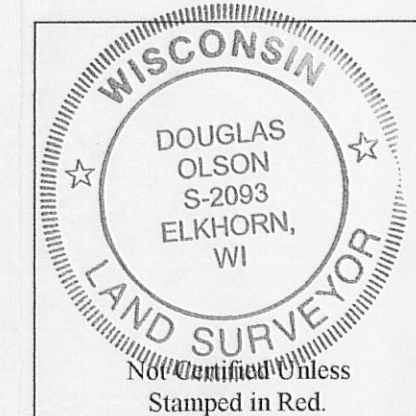
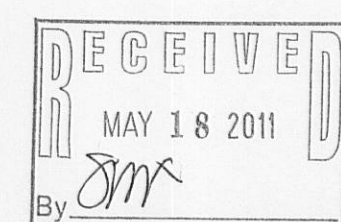

- 1) This survey plat is not certified unless signed and sealed in red ink.
- 2) This survey is subject to Wisconsin lien laws. This Plat of Survey is the notice of intent to file lien. Lien waiver required.

All rights reserved. No part of this survey plat may be reproduced or transmitted in any form by any means - graphic, electronic, or mechanical, including photocopying, tracing, or information storage and retrieval systems - without permission in writing from Douglas G. Olson, Jensen & Olson Land Surveying, LLC.

I, Douglas G. Olson, Wisconsin Registered Land Surveyor, do hereby certify that this survey was performed by me, or under my direction in full compliance with the owner's/agent's instructions and Chapter A-E 7 of the Wisconsin Administrative Code "Minimum Standards for Property Surveys"; and that this map is an accurate representation thereof to the best of my knowledge and belief.

Douglas G. Olson
Wisconsin Registered Land Surveyor - 2093

Scale in Feet

45 South Wisconsin Street * P.O. Box 322 * Elkhorn, Wisconsin. 53121

262) 723-3434 * Facsimile: (262) 723-8044
Email: jensen.olson@elknet.net

262) 723-3434 * Facsimile: (262) 723-3434
Email: jensen.olson@elknet.net

Legend

Legend

■	Found County Section Corner
⊗	Found Iron Pipe
()	Recorded Information
○	Concrete Cover
○	PVC Vent
⊗	Utility Pole
⊗	Utility Pedestal
▨	Asphalt Surface
▨	Concrete Surface
▨	Gravel Surface

Sheet 1 of 1 Sheets

Drawing Name: tlnr16e-2010114-2010114 Plat.scj

Job Reference Number

2010.114