

ABERNATHY and ASSOCIATES

Kenneth B. Abernathy Jr.

Wisconsin Registered Land Surveyor

S-1594

W4056 BRAY RD.
ELKHORN, WI. 53121
PHONE: (262) 723-4260 (OFFICE)
(262) 723-7209 (FAX)
Email: abernathy@elknet.net

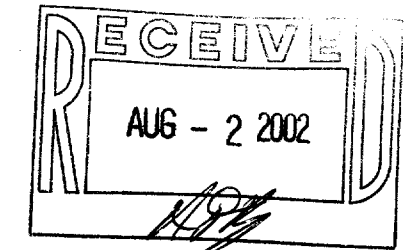

PLAT OF SURVEY

Lots 37, 38, 43 and 44 of Hillside Subdivision

LOCATED IN SECTION 5, TOWN 1 NORTH,
RANGE 16 EAST, WALWORTH COUNTY, WISCONSIN.

Owners: Lydia Bockholt and Karla Bockholt
N2448 Laura St.
Delavan, Wi. 53115

Legend

- FOUND IRON PIPE
- FOUND IRON ROD
- ⊠ FOUND BRASS CAPPED MONUMENT
- FOUND CONCRETE MONUMENT
- + CHISEL CUT IN CONCRETE
- SET IRON ROD, 24" LONG, WEIGHING 1.5 LBS./LINEAL FT., 3/4" DIA.
- SET IRON ROD, 30" LONG, WEIGHING 4.5 LBS./LINEAL FT., 1-11/16" DIA.
- (x x) RECORDED AS DIMENSION
- x-x- EXISTING FENCE
- g-g- GAS LINE

Basis for Bearings

North Line of Lots 37 and 38 was
assumed to bear N 89°50'22"W.

SCALE: 1" = 30 FEET

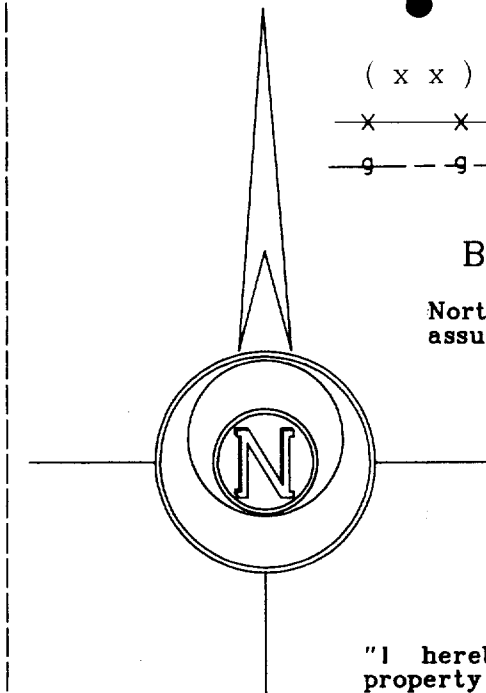

"I hereby certify that the above described property has been surveyed by me or under my direction and that the above map is a true representation thereof and shows the size and location of the property, its exterior boundaries, the location of all visible structures and dimensions of all principal buildings thereon, boundary fences, apparent easements, roadways and visible encroachments, if any."
"This survey is made for the use of the present owners of the property, and also those who purchase, mortgage, or guarantee the title thereto within one year from the date hereof."

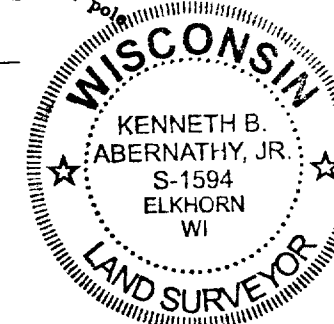

Kenneth B. Abernathy, Jr.
KENNETH B. ABERNATHY, JR.
WISCONSIN REGISTERED LAND SURVEYOR,
S-1594
Date: July 4, 2002 Job No. 02.701

