

# PLAT OF SURVEY

January 28, 2002

Survey No. 020041  
Trustway Homes, Inc.  
James and Jennifer O'Dierno

LOCATION: \_\_\_\_\_ Angels Lane, Walworth, Wisconsin

## LEGAL DESCRIPTION:

Lot 1 in **ANGELS FLIGHT SUBDIVISION**, A redivision of Lot 4 of Mogg's Subdivision and Lots 2 and 3 of Edward Uihlein's Subdivision, Located in part of Government Lot 1, Section 11, Township 1 North, Range 16 East, in the Town of Walworth, Walworth County, Wisconsin.

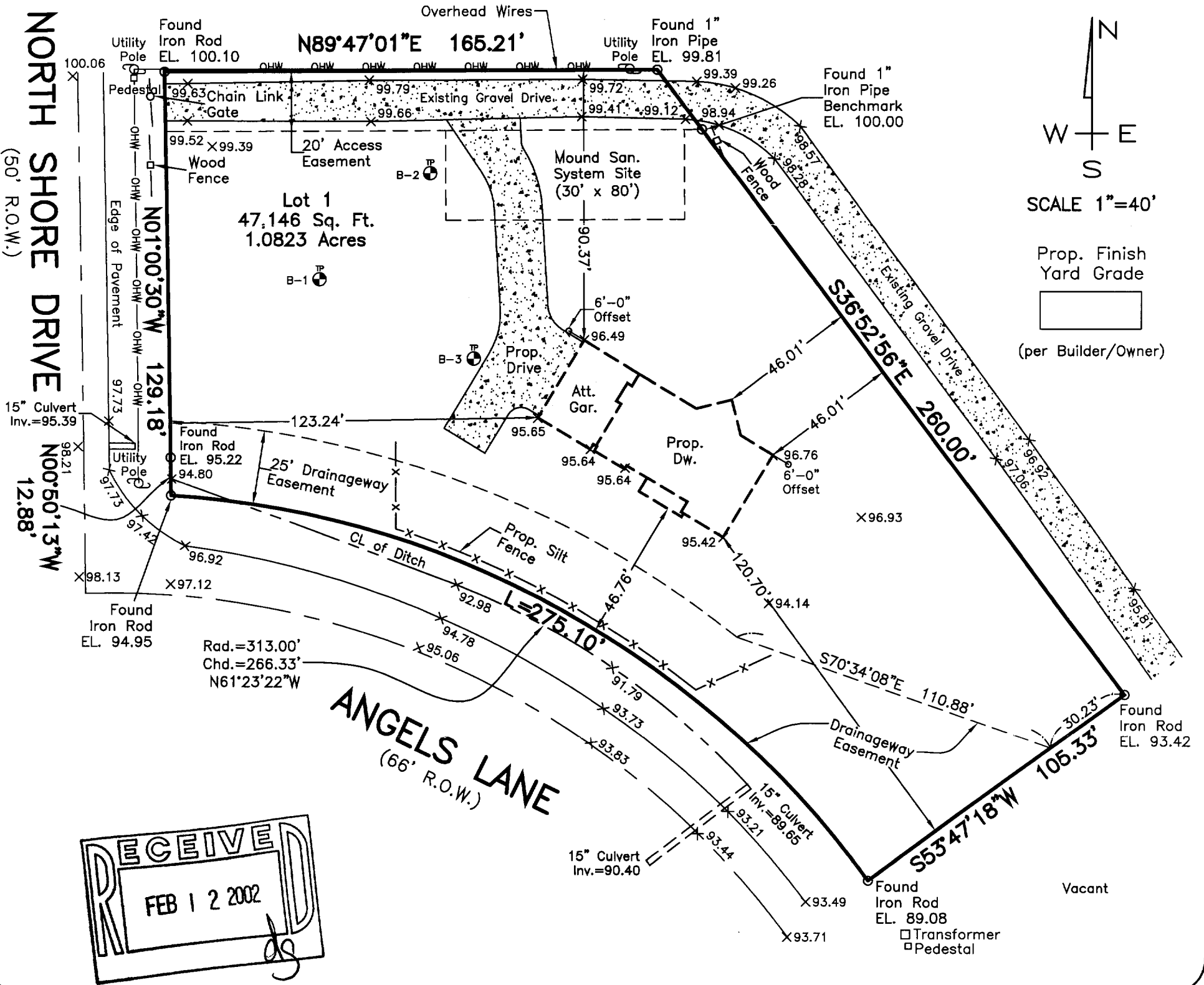
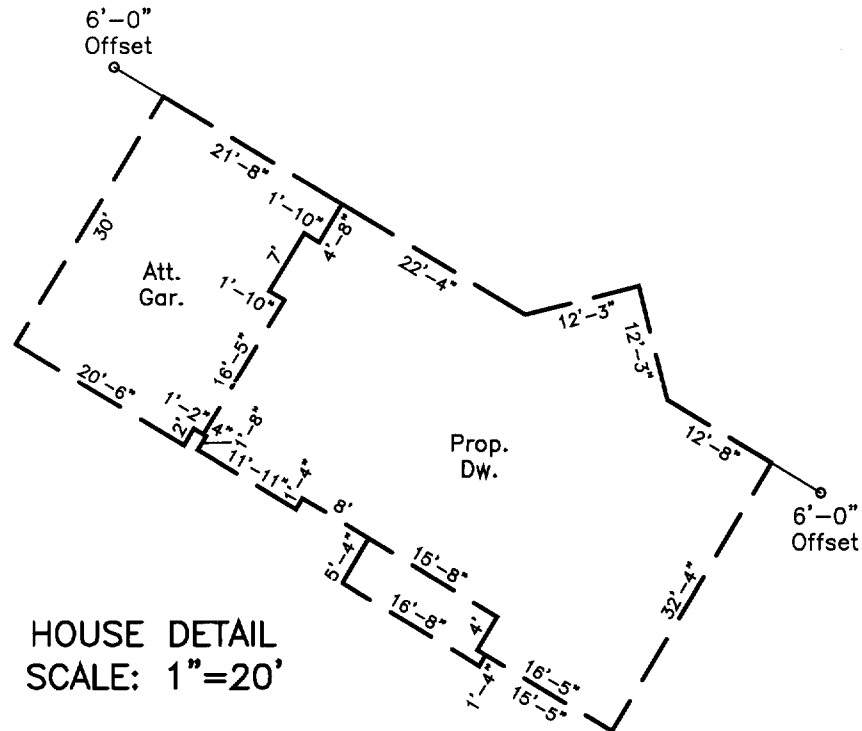

## LANDCRAFT SURVEY AND ENGINEERING, INC.

REGISTERED LAND SURVEYORS AND CIVIL ENGINEERS  
2077 South 116th Street, West Allis, WI 53227  
PH. (414) 604-0674 FAX (414) 604-0677  
LANDCRAFT@EXECPC.COM

NOTE: Proposed finished yard as shown on this drawing is a suggested grade and should be verified by the owner and/or the builder and approved by the building inspector. Erosion control measures are suggested and must be verified/adjusted by the builder and/or building inspector based on site conditions.

I HEREBY CERTIFY THAT I HAVE SURVEYED THE ABOVE DESCRIBED PROPERTY AND THAT THE ABOVE MAP IS A TRUE REPRESENTATION THEREOF AND SHOWS THE SIZE AND LOCATION OF THE PROPERTY, ITS EXTERIOR BOUNDARIES, THE LOCATION OF ALL VISIBLE STRUCTURES AND DIMENSIONS OF ALL PRINCIPAL BUILDINGS THEREON, BOUNDARY FENCES, APPARENT EASEMENTS AND ROADWAYS AND VISIBLE ENCROACHMENT, IF ANY.

THIS SURVEY IS MADE FOR THE EXCLUSIVE USE OF THE PRESENT OWNERS OF THE PROPERTY, AND ALSO THOSE WHO PURCHASE, MORTGAGE, OR GUARANTEE THE TITLE THERETO WITHIN ONE (1) YEAR FROM THE DATE HEREOF.

SIGNED *William R. Henrichs*  
William R. Henrichs, Registered Land Surveyor S-2419

116-606  
EANG-1