

# PLAN OF SURVEY

WORK ORDERED BY  
BERNARD KAUFMANN  
P.O. BOX 409  
FONTANA, W. 53125

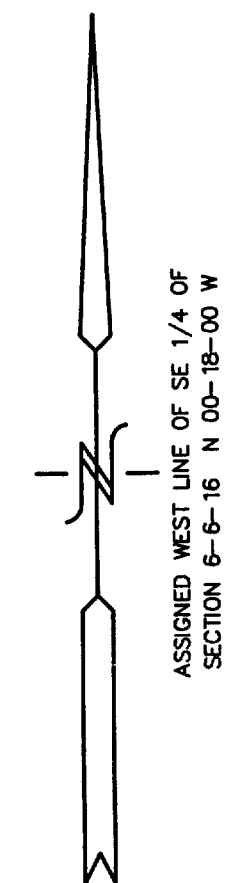

- = FOUND IRON PIPE STAKE, 1" DIA.
- = FOUND IRON REBAR STAKE, 3/4" DIA.
- ▣ = FOUND CONCRETE COUNTY MONUMENT W/ BRASS CAP
- = FOUND SOLID ROUND IRON BAR STAKE  
1 5/16" X 30" X 4.60 LBS./FT.
- (xxx) = RECORDED AS

I HEREBY CERTIFY THAT THE ABOVE DESCRIBED PROPERTY HAS BEEN SURVEYED UNDER MY DIRECTION AND THAT THE ABOVE MAP IS A TRUE REPRESENTATION THEREOF AND SHOWS THE SIZE AND LOCATION OF THE PROPERTY AND ITS EXTERIOR BOUNDARIES. THIS SURVEY IS MADE FOR THE USE OF THE PRESENT OWNERS OF THE PROPERTY, AND ALSO THOSE WHO PURCHASE, MORTGAGE, OR GUARANTEE THE TITLE THERETO WITHIN ONE YEAR FROM THE DATE HEREOF.

  
PETER S. GORDON R.L.S. 2101

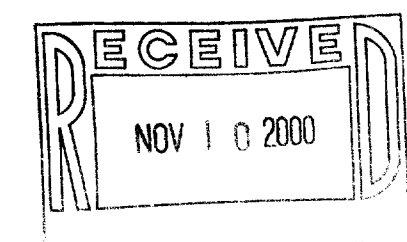

## REVISIONS

EDPE-7

OCT 18 2000