

Plat of Survey

of

Lot 8 of Addition No. 1 to Robbins Subdivision,

located in the Northwest 1/4 of the Northwest 1/4 of Section 5, Town 1 North, Range 16 East, Town of Walworth, Walworth County, Wisconsin.

Surveyed for: **JC Land Developers, LLC**
610 East Roosevelt Road, Suite 100
Wheaton, Illinois. 60187

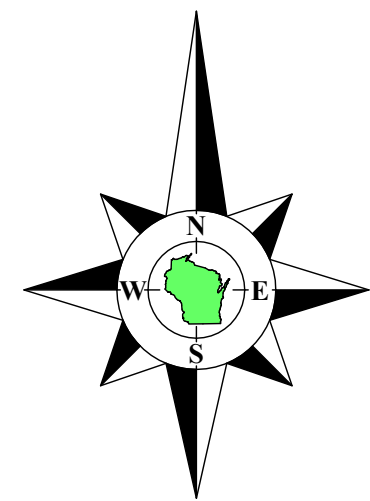

Bearings referenced to the North line of the Northwest 1/4 of Section 5-1-16, recorded as N88°28'56"E in the Wisconsin State Plane Coordinate System, South Zone, (NAD-27).

Coordinates are referenced to the Wisconsin State Plane Coordinate System, South Zone, (NAD-27).

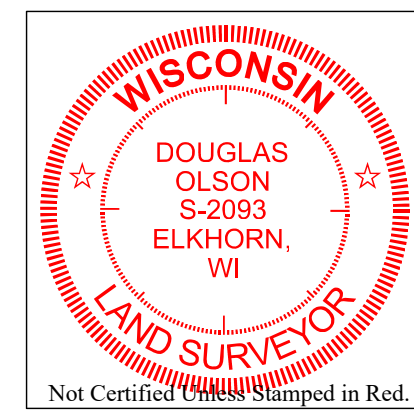

Notes:

- 1) This Plat of Survey is not certified unless signed and sealed in red ink.
- 2) This survey is subject to Wisconsin lien laws. This Plat of Survey is the notice of intent to file lien. Lien waiver required.
- 3) The Survey Date shown on this Plat of Survey is the completion date of the field work.

Copyright ©2023 by Olson Land Surveying, LLC.

All rights reserved. No part of this survey plat may be reproduced or transmitted in any form by any means - graphic, electronic, or mechanical, including photocopying, tracing, or information storage and retrieval systems - without permission in writing from Douglas G. Olson, Olson Land Surveying, LLC.

I hereby certify that I have surveyed the above described property in compliance with Chapter A-E 7 of the Wisconsin Administrative Code and that the map hereon is correct to the best of my professional knowledge and belief and shows the size and location of the property, its exterior boundaries, the location and dimensions of all visible structures thereon, boundary fences, apparent easements and roadways and visible encroachments, if any.

This survey is made for the exclusive use of the present owners of the property, and also those who purchase, mortgage or guarantee title thereto, within one year from the date hereof.

Douglas G. Olson
Wisconsin Professional Land Surveyor - 2093

Survey Date: October 24, 2023.
Revisions: No. 1 – Proposed

Scale in Feet
1" = 20'
0' 10' 20' 40' 60'

45 South Wisconsin Street | P.O. Box 322
Elkhorn, Wisconsin. 53121
Telephone: (262) 723-3434
Facsimile: (262) 723-8044
Email: doug@olsonsurveying.com
Website: www.olsonsurveying.com

OLSON

LAND SURVEYING, LLC

Rural | Residential | Commercial

Legend of Symbols & Abbreviations

Found County Section Corner	N	North
Found Iron Pipe	S	South
Set Iron Pipe	E	East
Set Iron Pipe 1" dia.	W	West
Recorded Information	In	Inches
Utility Pole	De	Decades
Utility Pedestal	Min	Minutes
Concrete Cover	Feet	Feet
Asphalt Surface	In	Inches

Sheet 1 of 1 Sheets

Drawing Name:

Job Reference Number
2023.098

2023.098