

Plat of Survey

of

Lot 1 of Certified Survey Map No. 161,

recorded August 2, 1972 in Vol. 1 of Certified Survey Maps of Walworth County on Page 161 as Document Number 652973 and located in the Northwest 1/4 of the Northwest 1/4 of Section 5, Town 1 North, Range 15 East, Town of Sharon, Walworth County, Wisconsin.

Surveyed for: **Susan Buss**
1120 11th Avenue E
Menomonie, Wisconsin. 54751

County Trunk Highway X

S & D Townline Road

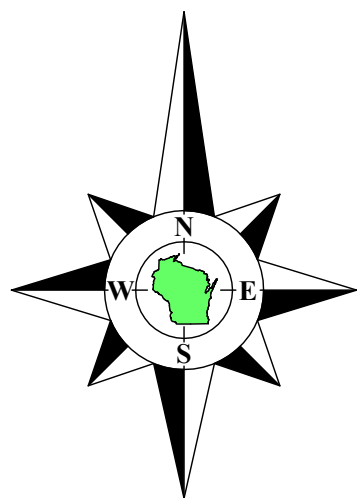

Bearings referenced to the North line of the Northwest 1/4 of Section 5-1-15, recorded as N87°36'27"E in the Wisconsin State Plane Coordinate System, South Zone, (NAD-27).

Coordinates are referenced to the Wisconsin State Plane Coordinate System, South Zone, (NAD-27).

Tax Parcel
AS 500002

Lot 1
Tax Parcel
AA 16100001

1.019 Acres
44,400 Sq.Ft.
0.861 Acre
37,518 Sq.Ft.
Exclusive of R.O.W.

Lot 2
C.S.M. 161

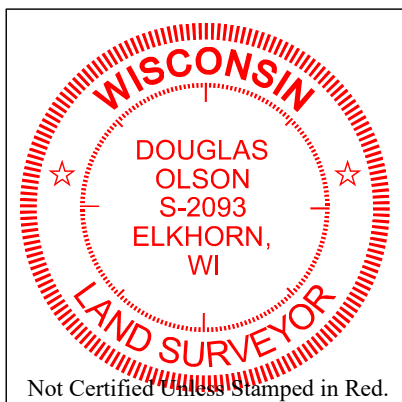

Notes:

- This Plat of Survey is not certified unless signed and sealed in red ink.
- This survey is subject to Wisconsin lien laws. This Plat of Survey is the notice of intent to file lien. Lien waiver required.
- The Survey Date shown on this Plat of Survey is the completion date of the field work.

Copyright ©2024 by Olson Land Surveying, LLC.

All rights reserved. No part of this survey plat may be reproduced or transmitted in any form by any means - graphic, electronic, or mechanical, including photocopying, tracing, or information storage and retrieval systems - without permission in writing from Douglas G. Olson, Olson Land Surveying, LLC.

I hereby certify that I have surveyed the above described property in compliance with Chapter A-E 7 of the Wisconsin Administrative Code and that the map hereon is correct to the best of my professional knowledge and belief and shows the size and location of the property, its exterior boundaries, the location and dimensions of all visible structures thereon, boundary fences, apparent easements and roadways and visible encroachments, if any.

This survey is made for the exclusive use of the present owners of the property, and also those who purchase, mortgage or guarantee title thereto, within one year from the date hereof.

Douglas G. Olson
Wisconsin Professional Land Surveyor - 2093

Sheet 1 of 1 Sheets

Drawing Name:

Job Reference Number
2024.005

Legend of Symbols & Abbreviations

- | | |
|-----------------------------|--------------|
| Found County Section Corner | N North |
| Found Iron Pipe | S South |
| Set 60d Spike | E East |
| Set Wood Lath | W West |
| Recorded Information | In Bearings |
| Utility Pole | Degrees |
| Utility Pedestal | Minutes |
| Concrete Cover | Seconds |
| Septic Vent | In Distances |
| Asphalt Surface | Feet |
| Concrete Surface | Inches |



45 South Wisconsin Street | P.O. Box 322
Elkhorn, Wisconsin. 53121
Telephone: (262) 723-3434
Facsimile: (262) 723-8044
Email: doug@olsonsurveying.com
Website: www.olsonsurveying.com

Scale in Feet
1" = 20'



Survey Date: April 8, 2024.

Revisions:

2024.005