

Plat of Survey

of

Lots 1 & 2 of Certified Survey Map No. 5160,

recorded June 14, 2024 as Document Number 1096081 and located in the Southwest 1/4 of the Southeast 1/4 of Section 27, Town 1 North, Range 15 East, Town of Sharon, Walworth County, Wisconsin.

Surveyed for: **Eva Peterson**
W8274 State Road 67
Sharon, Wisconsin. 53585

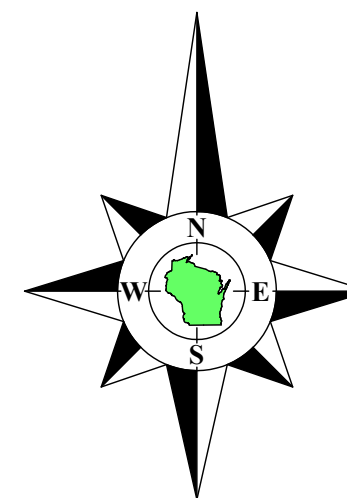

Bearings referenced to the South line of the Southeast 1/4 of Section 27-1-15, recorded as N87°13'08"E in the Wisconsin State Plane Coordinate System, South Zone. (NAD-27).

Coordinates are referenced to the Wisconsin State Plane Coordinate System, South Zone, (NAD-27).

Tax Parcel
AS 2700010
Approx. 51.67 Acres
Zoned A-2

Tax Parcel
AS 27000015
Approx. 10.13 Acres
Zoned C-2

Tax Parcel
AA516000001
1.006 Acres
43,793 Sq.Ft.

Tax Parcel
AA516000002
1.011 Acres
44,052 Sq.Ft.

Tax Parcel
AS 27000013A
Approx. 0.67 Acres
Zoned A-1

Tax Parcel
AS 27000016
Approx. 14.65 Acres
Zoned A-1

Tax Parcel
AS 27000013B
Approx. 0.83 Acres
Zoned A-1

Tax Parcel
AS 3400002A
Approx. 2.6 Acres
Zoned A-1

I hereby certify that I have surveyed the above described property in compliance with Chapter A-E 7 of the Wisconsin Administrative Code and that the map hereon is correct to the best of my professional knowledge and belief and shows the size and

Copyright ©2023 by Olson Land Surveying, LLC.

All rights reserved. No part of this survey plat may be reproduced or transmitted in any form by any means - graphic, electronic, or mechanical, including photocopying, tracing, or information storage and retrieval systems - without permission in writing from Douglas G. Olson, Olson Land Surveying, LLC.

I hereby certify that I have surveyed the above described property in compliance with Chapter A-E 7 of the Wisconsin Administrative Code and that the map hereon is correct to the best of my professional knowledge and belief and shows the size and location of the property, its exterior boundaries, the location and dimensions of all visible structures thereon, boundary fences, apparent easements and roadways and visible encroachments, if any.

This survey is made for the exclusive use of the present owners of the property, and also those who purchase, mortgage or guarantee title thereto, within one year from the date hereof.

Douglas G. Olson
Wisconsin Professional Land Surveyor - 2093

Notes:

- 1) This Plat of Survey is not certified unless signed and sealed in red ink.
- 2) This survey is subject to Wisconsin lien laws. This Plat of Survey is the notice of intent to file lien. Lien waiver required.
- 3) The Survey Date shown on this Plat of Survey is the completion date of the field work.

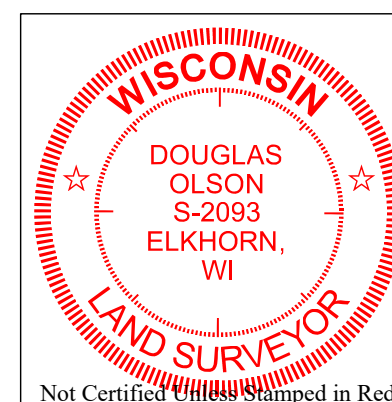

Mapping Date: April 11, 2024.
Revisions: No. 1 – Recorded CSM

Scale in Feet
1" = 40'

45 South Wisconsin Street | P.O. Box 322
Elkhorn, Wisconsin. 53121
Telephone: (262) 723-3434
Facsimile: (262) 723-8044
Email: doug@olsonsurveying.com
Website: www.olsonsurveying.com



OLSON
LAND SURVEYING, LLC

Rural | Residential | Commercial

Legend

Found County Section Corner	N	North
Found Iron Pipe	S	South
Found Iron Rod	E	East
Set Iron Pipe, 1" dia.	W	West
Recorded Information	In	In Bearings
Utility Pole	Minutes	Minutes
Concrete Cover	"	" Seconds
Concrete Core	°	° Sextants
Asphalt Surface	Feet	Feet
Gravel Surface		

Sheet 1 of 1 Sheets

Drawing Name:
Job Reference Number
2023.002

2023.002