

County Trunk Highway K

West line of the Southwest 1/4 of Section 12-1-15  
recorded as N0°37'21"W 2844.37'  
N 206,822.41  
E 2,356,137.00

(66' Wide)

West 1/4 Corner  
Section 12-1-15  
N 206,822.41  
E 2,356,137.00

Set 1/4" Pipe 1.56'  
at 1/4" of Found  
Pipe on Line  
N of line

Overhead Wires

Overhead Wires

Overhead Wires

Overhead Wires

Overhead Wires

Overhead Wires

Overhead Wires

Overhead Wires

# Plat of Survey

## Lot 1 of Certified Survey Map No. 5174,

recorded September 18, 2024 as Document Number 1100442 and located in the Northwest 1/4 and the Northeast 1/4 of the Southwest 1/4 of Section 12, Town 1 North, Range 15 East, Town of Sharon, Walworth County, Wisconsin.

Surveyed for: **Keith Rithamel**  
W8229 Town Hall Road  
Sharon, Wisconsin, 53505

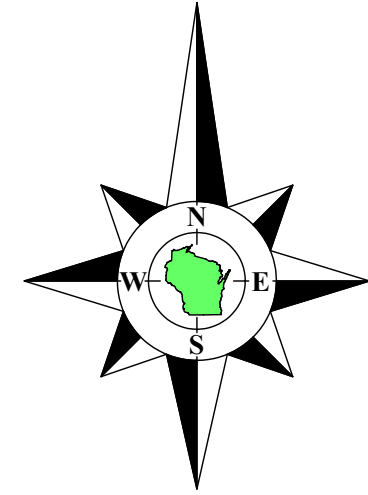

Bearings referenced to the North line of the Southwest 1/4 of Section 12-1-15, recorded as N86°59'40"E in the Wisconsin State Plane Coordinate System, South Zone, (NAD-27).

Coordinates are referenced to the Wisconsin State Plane Coordinate System, South Zone, (NAD-27).

Copyright © 2024 by Olson Land Surveying, LLC.

All rights reserved. No part of this survey plat may be reproduced or transmitted in any form by any means - graphic, electronic, or mechanical, including photocopying, tracing, or information storage and retrieval systems - without permission in writing from Douglas G. Olson, Olson Land Surveying, LLC.

I hereby certify that I have surveyed the above described property in compliance with Chapter A-E 7 of the Wisconsin Administrative Code and that the map hereon is correct to the best of my professional knowledge and belief and shows the size and location of the property, its exterior boundaries, the location and dimensions of all visible structures thereon, boundary fences, apparent easements and roadways and visible encroachments, if any.

This survey is made for the exclusive use of the present owners of the property, and also those who purchase, mortgage or guarantee title thereto, within one year from the date hereof.

Douglas G. Olson  
Wisconsin Professional Land Surveyor - 2093

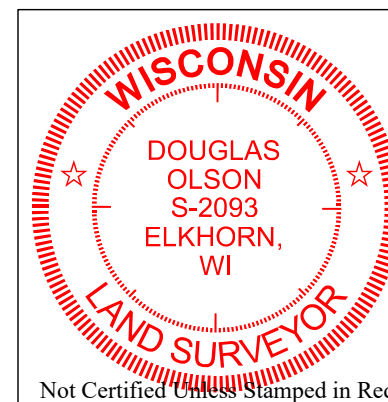

### Notes:

- 1) This Plat of Survey is not certified unless signed and sealed in red ink.
- 2) This survey is subject to Wisconsin lien laws. This Plat of Survey is the notice of intent to file lien. Lien waiver required.
- 3) The Survey Date shown on this Plat of Survey is the completion date of the field work.

Southwest Corner  
Section 12-1-15  
N 204,178.13  
E 2,356,163.70

Tax Parcel  
AS 1200004A

Tax Parcel  
AS 1200005

Tax Parcel  
AS 1200005

Tax Parcel  
AS 1200005

Tax Parcel  
AS 1200003

Tax Parcel  
AS 1200005

Tax Parcel  
AS 1200005

**Lot 1  
Tax Parcel  
AA517400001**  
5.006 Acres  
218,043 Sq.Ft.

Shed  
Remnant of C-2  
0.498 Acre  
21,709 Sq.Ft.

Railroad Right of Way  
Centerline

Vol. 319, Page 645  
Doc. No. 100536

Center 1/4 Corner  
Section 12-1-15  
N 206,962.50  
E 2,358,805.08

Sheet 1 of 1 Sheets

Job Reference Number  
2024-037

2024.037

**OLSON**  
LAND SURVEYING, LLC  
Rural | Residential | Commercial

45 South Wisconsin Street | P.O. Box 322  
Elkhorn, Wisconsin, 53121  
Telephone: (262) 723-3434  
Facsimile: (262) 723-8044  
Email: doug@olsonsurveying.com  
Website: www.olsonsurveying.com

Scale in Feet  
1" = 50'  
0' 25' 50' 100' 150'

Survey date: April 11, 2024.  
Revisions: No. 1 - Proposed Lot 1 & Edge of Farm Field Proposed Easement  
No. 2 - Edge of Farm Field Proposed Easement  
No. 3 - Benchmark, Soil Boring, Soil Test, & Easement  
No. 4 - Easement

### Description of Proposed 50' Wide Ingress, Egress & Utility Easement

A 50' Wide Ingress, Egress & Utility Easement on a portion of Lot 1 of Certified Survey Map No. 5174, recorded September 18, 2024 as Document Number 1100442 and located in the Northwest 1/4 of the Southwest 1/4 of Section 12, Town 1 North, Range 15 East, Town of Sharon, Walworth County, Wisconsin, described as follows: Commence at the West 1/4 corner of said Section 12; thence North 86°59'40" East, along the North line of said Southwest 1/4 of Section 12, 1014.49 feet to an iron pipe on the Southerly line of a railroad right of way; thence South 67°44'35" East, along said Southerly line, 117.14 feet to an iron pipe and the Point of Beginning; thence continue South 67°44'35" East, along said Southerly line, 266.08 feet to an iron pipe; thence South 0°21'25" East, 54.16 feet, thence North 67°44'35" West, 268.79 feet; thence North 2°20'27" East, 53.18 feet to the Point of Beginning.

Legend of Symbols & Abbreviations  
Found County Section Corner  
Found Iron Rod  
Bearing  
Monument  
Utility Pole  
Concrete Cover  
Alphabet Surface  
Gravel Surface  
Brick Pavement  
Section of Soil Boring  
Bearing no longer visible  
Bearing no longer visible