

# Plat of Survey

of

**Lots 1 through 12 and the vacated Alley in Block 4 and the West 1/2 of vacated William Street lying East of said Block 4 all in the Plat of The Village of Allens Grove,**

located in the Northwest 1/4 of the Northeast 1/4 of Section 6, Town 1 North, Range 15 East, Town of Sharon, Walworth County, Wisconsin.

Surveyed for: **Michael & Christine Moore**  
W9475 Clinton Street  
Darien, Wisconsin, 53114

Bearings referenced to the North line of the Northeast 1/4 of Section 6-1-15, recorded as N88°28'26"E in the Wisconsin State Plane Coordinate System, South Zone, (NAD-27).

Coordinates are referenced to the Wisconsin State Plane Coordinate System, South Zone, (NAD-27).

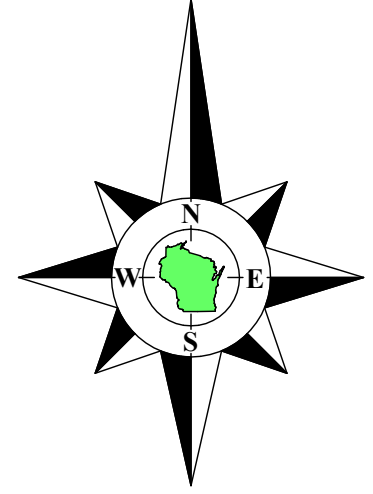

Survey date: May 11, 2023.  
Revisions:

Scale in Feet  
1" = 20'



45 South Wisconsin Street | P.O. Box 322  
Elkhorn, Wisconsin, 53121  
Telephone: (262) 723-3434  
Facsimile: (262) 723-8044  
Email: doug@olsonsurveying.com  
Website: www.olsonsurveying.com



**Legend of Symbols & Abbreviations**

- Found County Section Corner
- Found Iron Pipe
- Found Concrete Monument
- Set Iron Pipe, 1" dia.
- Utility Pole
- Concrete Monument
- Concrete Pole
- Septic Vent
- NW Corner
- NE Corner
- SW Corner
- SE Corner
- Brick Pavers

Sheet 1 of 1 Sheets

Job Reference Number

2023.003

Drawing Name:

2023.003

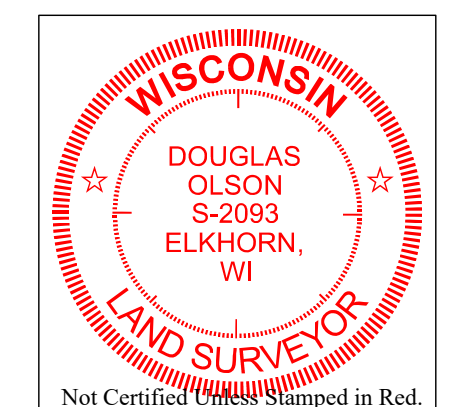

**Note \***  
The Alley through Block 4 is shown as 24' wide on the Plat of The Village of Allens Grove and appears to be slightly wider than all of the other alleys shown on the Plat which are shown as 20' wide. However, when comparing the lot dimensions shown on the Plat for lots in Blocks 3, 4 and 5 the width of the Alley in Block 4 would have to be 20' wide. The width of the Alley in Block 4 is shown as 20' wide on this Plat of Survey. At this point the width of the Alley in Block 4 has little consequence since the Alley has been vacated and all 12 lots in Block 4 have the same owner.

Copyright © 2023 by Olson Land Surveying, LLC.  
All rights reserved. No part of this survey plat may be reproduced or transmitted in any form by any means - graphic, electronic, or mechanical, including photocopying, tracing, or information storage and retrieval systems - without permission in writing from Douglas G. Olson, Olson Land Surveying, LLC.

I hereby certify that I have surveyed the above described property in compliance with Chapter A-E 7 of the Wisconsin Administrative Code and that the map hereon is correct to the best of my professional knowledge and belief and shows the size and location of the property, its exterior boundaries, the location and dimensions of all visible structures thereon, boundary fences, apparent easements and roadways and visible encroachments, if any.  
This survey is made for the exclusive use of the present owners of the property, and also those who purchase, mortgage or guarantee title thereto, within one year from the date hereof.

Douglas G. Olson  
Wisconsin Professional Land Surveyor - 2093

- Notes:**
- 1) This Plat of Survey is not certified unless signed and sealed in red ink.
  - 2) This survey is subject to Wisconsin lien laws. This Plat of Survey is the notice of intent to file lien. Lien waiver required.
  - 3) The Survey Date shown on this Plat of Survey is the completion date of the field work.