

North 1/4 Corner
Section 5-1-15
(N. 214,078.24)
(E. 2,337,498.79)

Plat of Survey

of

Lot 1 of Certified Survey Map No. 1298,

recorded in Vol. 6 of Certified Survey Maps of Walworth County on Page 94
and located in the Northwest 1/4 of the Northeast 1/4 of Section 5, Town 1
North, Range 15 East, Town of Sharon, Walworth County, Wisconsin.

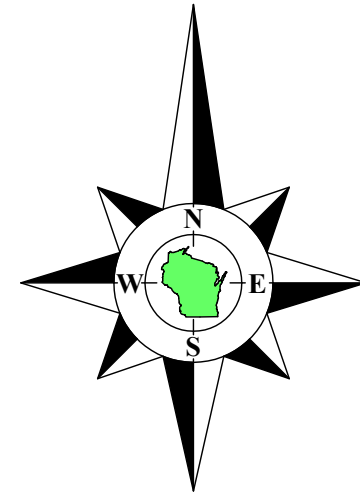

Surveyed for: **Martin Small**
N2412 Salt Box Road
Darien, Wisconsin. 53114

Tax Parcel
A S 500001

Bearings referenced to the West line of the Northeast 1/4 of Section 5-1-15,
recorded as North on Certified Survey Map No. 1298. A rotation of 0°49'13"
from the Wisconsin State Plane Coordinate System, South Zone, (NAD-27).

Coordinates are referenced to the Wisconsin State
Plane Coordinate System, South Zone, (NAD-27).

Edge of Farm Field recorded as(East 428.78')
S89°59'24"E 428.73'
395.69'
(395.78')

33.04'
(33.00')

118.9'

Shed
30.4'

46.1'

45.5'

100.8'

140.1'

Lean to Silo Silo
14.0'

Barn
68.0'

54.4'

Lot 1
Tax Parcel
AA129800001
3.651 Acres
159,041 Sq.Ft.
3.370 Acres
146,794 Sq.Ft.
Exclusive of R.O.W.

Tank

House
N2412

Poured
Concrete
Foundation

Well

Shed
14.4'

Old
Foundation

Edge of Farm Field recorded as(West 428.78')
S89°58'31"W 428.75'
395.78'
(395.78')

Tax Parcel
A S 500001

Copyright ©2022 by Olson Land Surveying, LLC.

All rights reserved. No part of this survey plat may be reproduced or transmitted in
any form by any means - graphic, electronic, or mechanical, including photocopying,
tracing, or information storage and retrieval systems - without permission in writing
from Douglas G. Olson, Olson Land Surveying, LLC.

I hereby certify that I have surveyed the above described property in compliance
with Chapter A-E 7 of the Wisconsin Administrative Code and that the map hereon is
correct to the best of my professional knowledge and belief and shows the size and
location of the property, its exterior boundaries, the location and dimensions of all
visible structures thereon, boundary fences, apparent easements and roadways and
visible encroachments, if any.

This survey is made for the exclusive use of the present owners of the property,
and also those who purchase, mortgage or guarantee title thereto, within one year from
the date hereof.

Douglas G. Olson
Wisconsin Professional Land Surveyor - 2093

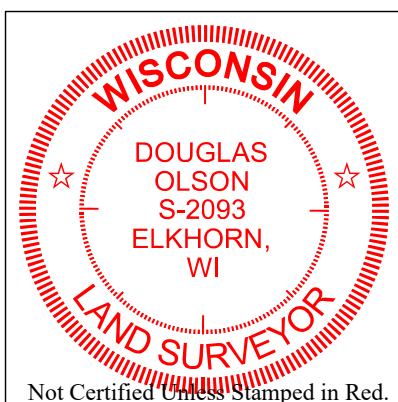

Notes:

- 1) This Plat of Survey is not certified unless signed and sealed in red ink.
- 2) This survey is subject to Wisconsin lien laws. This Plat of Survey is the notice of intent to file lien. Lien waiver required.
- 3) The Survey Date shown on this Plat of Survey is the completion date of the field work.

Not Certified unless Stamped in Red.

Salt Box Road

recorded as(North 371.08')
North 371.08'

South 966.30'
recorded as(South 966.08')

recorded as(North 371.00')
North 371.08'

recorded as(N0°49'13"W 2831.22')State Plane
North 2831.22'
West line of the Northeast 1/4 of Section 5-1-15.
North 1593.84'

(33.00')
32.97'

Edge of Farm Field

Edge of Farm Field

Center 1/4 Corner
Section 5-1-15
(N. 211,147.32)
(E. 2,337,540.76)

Sheet 1 of 1 Sheets

Drawing Name:

Job Reference Number
2022.126

Legend of Symbols & Abbreviations

- Found County Section Corner
 - Found Iron Pipe
 - Recorded Information
 - Utility Pole
 - Utility Pedestal
 - Concrete Cover
 - Septic Vent
 - Asphalt Surface
 - Concrete Surface
 - Gravel Surface
- N North
S South
E East
W West
In Bearings
Degrees
Minutes
Seconds
In Distances
Feet
Inches



45 South Wisconsin Street | P.O. Box 322
Elkhorn, Wisconsin. 53121
Telephone: (262) 723-3434
Facsimile: (262) 723-8044
Email: doug@olsonsurveying.com
Website: www.olsonsurveying.com

Scale in Feet
1" = 30'



Survey Date: October 15, 2022.

- Revisions:
- No. 1 - Proposed Garage
 - No. 2 - Proposed Garage Moved
 - No. 3 - Poured Concrete Foundation

2022.126