

RECEIVED
JUL 15 2021
By smf

Plat of Survey

of Tax Parcel AAG 00011A

located in the Northeast 1/4 of the Northwest 1/4 of Section 6-1-15,
North, Range 15 East, Town of Sharon, Walworth County, Wisconsin.

Legal Description

Lots 1 through 13 in Block 7, ALSO the vacated alley* in said Block 7, ALSO that portion of the South 1/2 of vacated John Street lying North of said Lots 1 through 9, ALSO, that portion of vacated Allen Street lying West of said Block 7 and lying West of said South 1/2 of vacated John Street, all in the Original Plat of the Village of Allen's Grove, located in the Northeast 1/4 of the Northwest 1/4 of Section 6, Town 1 North, Range 15 East, Town of Sharon, Walworth County, Wisconsin.

Copyright ©2020 by Olson Land Surveying, LLC.

All rights reserved. No part of this survey plat may be reproduced or transmitted in any form by any means - graphic, electronic, or mechanical, including photocopying, tracing, or information storage and retrieval systems - without permission in writing from Douglas G. Olson, Olson Land Surveying, LLC.

I hereby certify that I have surveyed the above described property in compliance with Chapter A-E 7 of the Wisconsin Administrative Code and that the map hereon is correct to the best of my professional knowledge and belief and shows the size and location of the property, its exterior boundaries, the location and dimensions of all visible structures thereon, boundary fences, apparent easements and roadways and visible encroachments, if any.

This survey is made for the exclusive use of the present owners of the property, and also those who purchase, mortgage or guarantee title thereto, within one year from the date hereof.

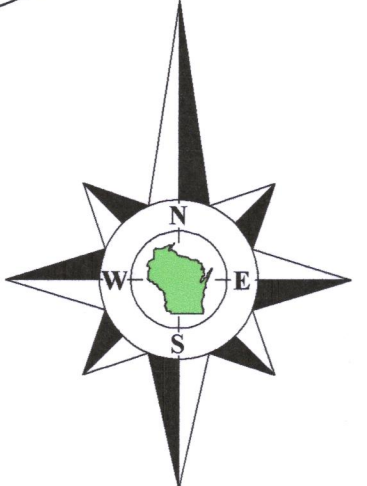

Bearings referenced to the North line of the Northwest 1/4 of Section 6-1-15, recorded as N89°03'32"E in the Wisconsin State Plane Coordinate System, South Zone, (NAD-27).

Coordinates are referenced to the Wisconsin State Plane Coordinate System, South Zone, (NAD-27).

Notes:

- A) A concrete monument was set to mark this section corner in November of 1984. The monument was moved 1.81, South onto the township line in December of 1995. Record dimensions shown on surveys done between 1984 and 1995 are different that dimensions measured to the current monument location.
- * B) There are some deeds and prior surveys that refer to the Alley in Block 6 as vacated. The Walworth County GIS appears to show the Alleys in both Block 6 & Block 7 as vacated. We were unable to verify with recorded docs.
- C) Allen Street vacated by Doc. No. 1025515 and John Street vacated by Doc. No. 1025514.

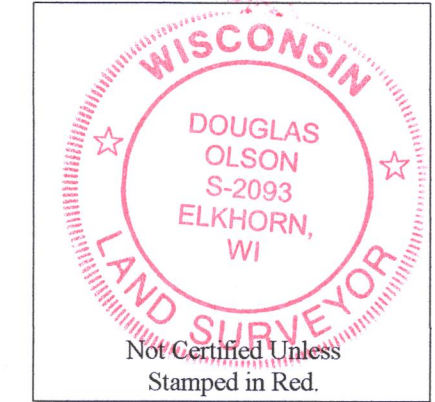

Notes:

- 1) This Plat of Survey is not certified unless signed and sealed in red ink.
- 2) This survey is subject to Wisconsin lien laws. This Plat of Survey is the notice of intent to file lien. Lien waiver required.
- 3) The Survey Date shown on this Plat of Survey is the completion date of the field work.

Center 1/4 Corner Section 6-1-15
N. 210,916.32
E. 2,332,244.78

115-496

Survey Date: October 8, 2020.
Revisions:
No. 1 - Parcels after Street
No. 2 - Proposed Lot Line
No. 3 - Adjustment 00011, after
No. 4 - Recorded Street Vacation
No. 5a - Wetland Reassessment

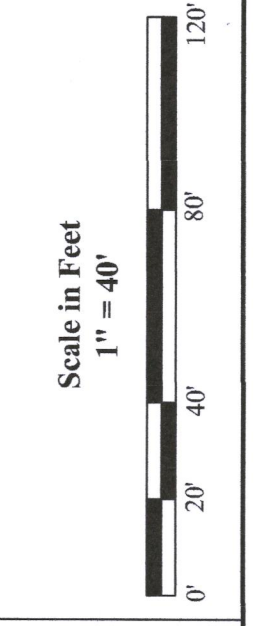

45 South Wisconsin Street | P.O. Box 322
Elkhorn, Wisconsin 53121
Telephone: 262.723.3434
Facsimile: 262.723.8044
Email: doug@olsonsurveying.com
Website: www.olsonsurveying.com

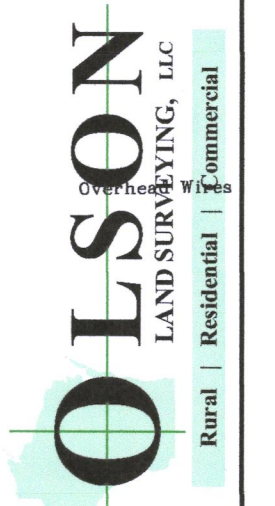

Legend of Symbols & Abbreviations

N	North
S	South
E	East
W	West
in	Bearings
°	Degrees
'	Minutes
''	Seconds
in	Feet
ft	Feet
in	Inches

Sheet 1 of 1 Sheets
Drawing Name:
Job Reference Number
2020.099
2020.099

AAG-11A