

North 1/4 Corner
Section 1-1-15
(N 214,932.80)
(E 2,358,669.87)

recorded as(N87°36'59"E 2674.30')State Plane
East 2674.25'

Town of Darien
Town of Sharon

S & D Townline Road

East 365.98'

(66' Wide)

Town of Delavan

Northeast Corner
Section 1-1-15
(N 215,044.03)
(E 2,361,341.63)

Plat of Survey

of

Certified Survey Map No. 404,

recorded in Vol. 2 of Certified Survey Maps of Walworth County
on Page 201 and located in the Northeast 1/4 of the Northeast 1/4
of Section 1, Town 1 North, Range 15 East, Town of Sharon,
Walworth County, Wisconsin.

Surveyed for: **Tony Citro**
1908 South Maple Avenue
Berwyn, Illinois 60402

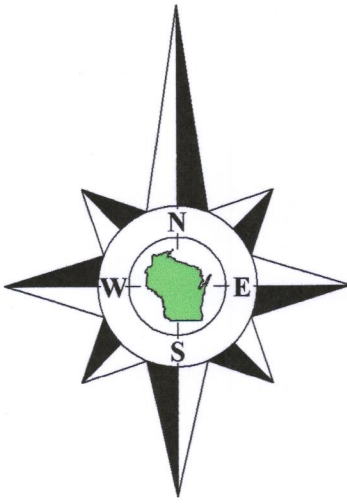

Bearings referenced to the North line of Certified Survey Map No. 404,
recorded as West, which is also the North line of the Northeast 1/4 of
Section 1-1-15. A rotation of 2°23'01" from the Wisconsin State Plane
Coordinate System, South Zone, (NAD-27).

Coordinates are referenced to the Wisconsin State
Plane Coordinate System, South Zone, (NAD-27).

Tax Parcel
AS 100001A

**Proposed
Tax Parcel
AA 40400004**
1.801 Acres
78,434 Sq.Ft.
1.687 Acres
73,484 Sq.Ft.
Exclusive of R.O.W.

**Proposed
Tax Parcel
AA 40400001**
2.152 Acres
93,719 Sq.Ft.
2.038 Acres
88,770 Sq.Ft.
Exclusive of R.O.W.

House
W7301

Shed

recorded as(S1°28'17"W 1157.29')
N1°27'07"E 1157.91'

recorded as(E 150.00')
S1°28'17"W 1157.29'

Tax Parcel
EW 600003

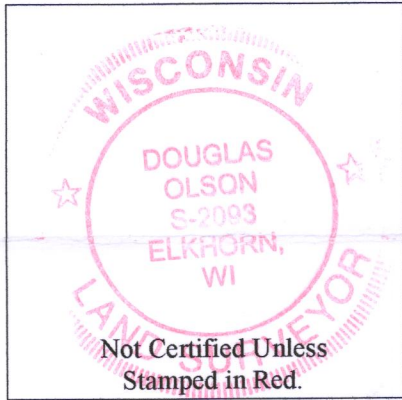

Notes:

- 1) This Plat of Survey is not certified unless signed and sealed in red ink.
- 2) This survey is subject to Wisconsin lien laws. This Plat of Survey is the notice of intent to file lien. Lien waiver required.
- 3) The Survey Date shown on this Plat of Survey is the completion date of the field work.

Copyright © 2017 by Olson Land Surveying, LLC.

All rights reserved. No part of this survey plat may be reproduced or transmitted in any form by any means - graphic, electronic, or mechanical, including photocopying, tracing, or information storage and retrieval systems - without permission in writing from Douglas G. Olson, Olson Land Surveying, LLC.

I hereby certify that I have surveyed the above described property in compliance with Chapter A-E 7 of the Wisconsin Administrative Code and that the map hereon is correct to the best of my knowledge and belief.

Douglas G. Olson
Wisconsin Professional Land Surveyor - 2093



S89°54'08"W 365.60'
recorded as(East 366.00')

Tax Parcel
AS 100002

AA 404-1
AA 404-2
AA 404-3

AA 404-4

115-451

2017.070

Sheet 1 of 1 Sheets

Drawing Name:

Job Reference Number

2017.070

Legend of Symbols & Abbreviations

- Found County Section Corner
- Found Iron Pipe
- Set Iron Pipe, 1" dia.
- Recorded Information
- Utility Pole
- Utility Pedestal
- Concrete Cover
- Septic Vent
- Asphalt Surface
- Concrete Surface
- Gravel Surface
- Brick Pavers

N North
S South
E East
W West
In Bearings
Degrees
Minutes
Seconds
in Distances
Feet
Inches
No. Number
NW Northwest
NE Northeast
SE Southeast
SW Southwest



45 South Wisconsin Street | P.O. Box 322
Elkhorn, Wisconsin 53121
Telephone: (262) 723-3434
Facsimile: (262) 723-8044
Email: doug@olsonsurveying.com
Website: www.olsonsurveying.com

Scale in Feet

1" = 40'



Survey date: June 7, 2017.

Revisions: No. 1 - Proposed Lot Line
Adjustments
No. 2 - Proposed New Layout
No. 2A - Zoning Line Added