

# Plat of Survey

of  
**Lot 1 of Certified Survey Map No. 4621,**

recorded in Vol. 30 of Certified Survey Maps of Walworth County on Page 210 and located in the Southeast 1/4 of Section 20 and the Southwest 1/4 of Section 21, Town 1 North, Range 15 East, Town of Sharon, Walworth County, Wisconsin.

ALSO

Lands described in a Quit Claim Deed recorded July 3, 1979 in Vol. 235 on Page 519 as Document No. 48537 as shown below:

Parcel II:

North one-half of the North one-half of the Southwest quarter of Section 21, Town 1 North, Range 15 East, excepting therefrom a portion of the land described as follows: Commencing at a point that is 33.0 feet West of and 1966.0 feet North of the Southeast corner of the Southwest 1/4 of Section 21, thence West 7.0 feet, thence North 674.0 feet to the North line of said quarter section, thence East 7.0 feet, thence South 674.0 feet to the place of beginning, all in Town 1 North, Range 15 East, Town of Sharon, Walworth County, Wisconsin.

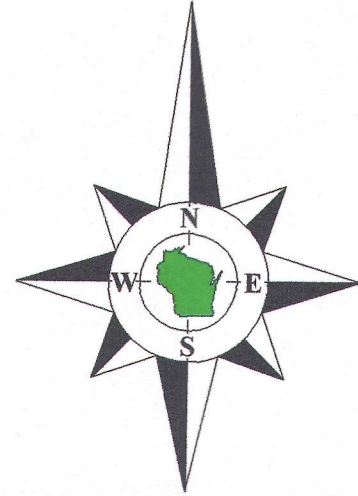

Bearings reference to the Wisconsin State Plane Coordinate System, South Zone.

Surveyed for: **Van Dell Farms, Inc.**  
 W8866 Cemetery Road  
 Sharon, Wisconsin, 53585

Tax Parcel  
 AS 2100004



Survey date: November 11, 2015.  
 REVISIONS:  
 No. 1 - Proposed Lot Line  
 No. 2 - Proposed Parcel  
 After Lot Line  
 No. 3 - Recorded CSM

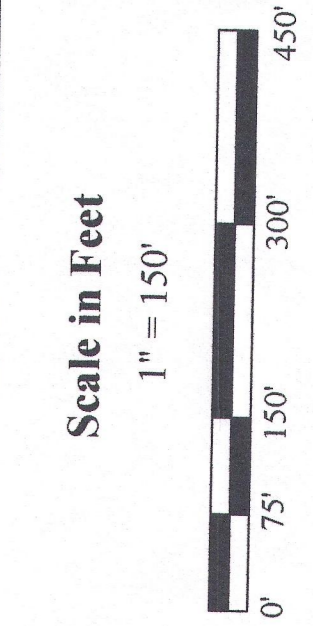

**Olson Land Surveying, LLC**  
 45 South Wisconsin Street \* P.O. Box 322 \* Elkhorn, Wisconsin, 53121  
 Telephone: (262) 723-3434 \* Facsimile: (262) 723-8044  
 Email: doug@olsonsurveying.com

- Legend**
- Found County Section Corner
  - Recorded Information
  - Utility Pole
  - Overhead Wires
  - Concrete Foundation
  - Concrete Footing
  - Concrete Slab
  - Concrete Wall
  - Concrete Surface
  - Gravel Surface
  - Fiber Optic Sign

Sheet 1 of 1 Sheets  
 Job Reference Number  
**2014.122**

**Lot 1  
 C.S.M. 4621  
 Tax Parcel  
 AA462100001**  
 87.504 Acres  
 3,811,672 Sq.Ft.  
 86.038 Acres  
 3,747,814 Sq.Ft.  
 Exclusive of R.O.W.  
 A-1 = 81.3 Acres  
 C-4 = 6.2 Acres

**Tax Parcel  
 AS 2100006**  
 39.552 Acres  
 1,722,866 Sq.Ft.  
 A-1 = 37.8 Acres  
 C-4 = 1.5 Acres  
 C-1 = 0.2 Acre

Tax Parcel  
 AS 2000004

Tax Parcel  
 AS 2100008

**Oakwood Cemetery**  
 Tax Parcel  
 AS 2100007

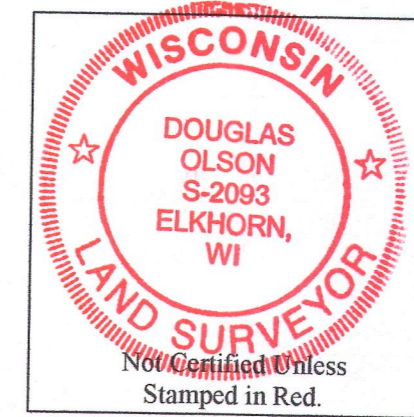
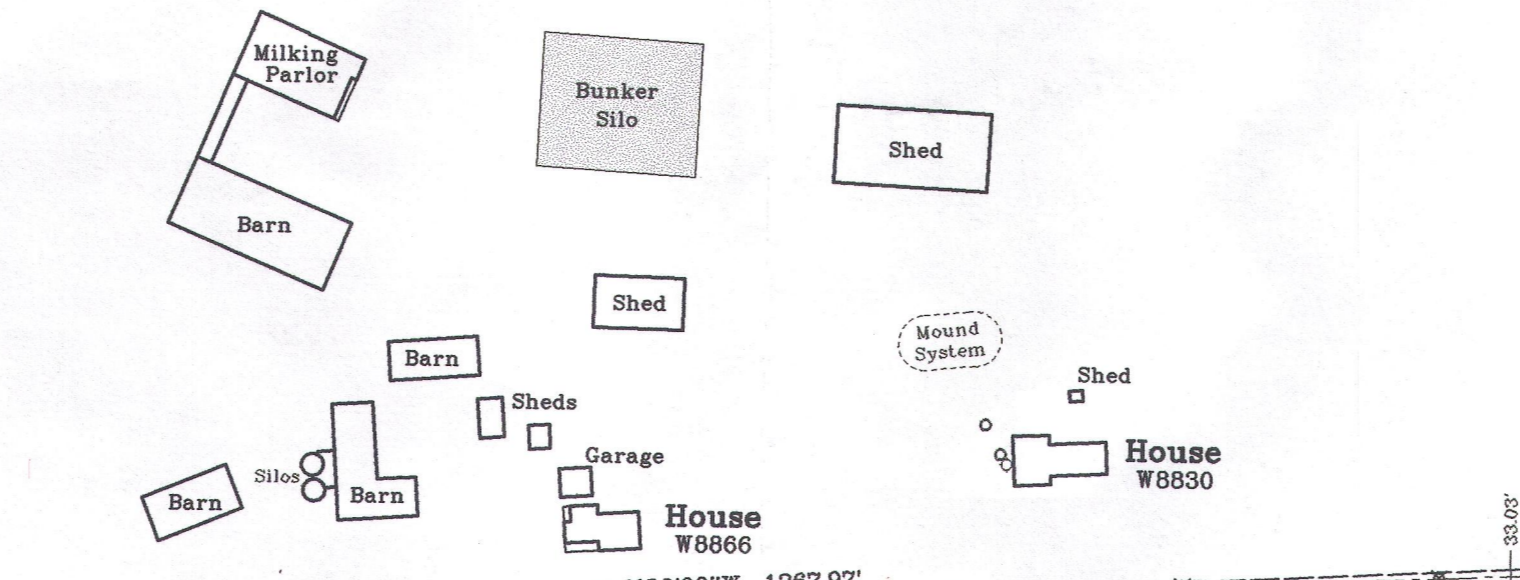

I, Douglas G. Olson, Wisconsin Professional Land Surveyor, do hereby certify that this survey was performed by me, or under my direction in full compliance with the owner's agent's instructions and Chapter A-E 7 of the Wisconsin Administrative Code "Minimum Standards for Property Surveys", and that this map is an accurate representation thereof to the best of my knowledge and belief.

Douglas G. Olson  
 Wisconsin Professional Land Surveyor - 2093

Copyright © 2015 by Olson Land Surveying, LLC.  
 All rights reserved. No part of this survey plat may be reproduced or transmitted in any form by any means - graphic, electronic, or mechanical, including photocopying, tracing, or information storage and retrieval systems - without permission in writing from Douglas G. Olson, Olson Land Surveying, LLC.

- Notes:**
- This survey plat is not certified unless signed and sealed in red ink.
  - This survey is subject to Wisconsin lien laws. This Plat of Survey is the notice of intent to file lien. Lien waiver required.