

LEGAL DESCRIPTION:
 LOT 1 OF CERTIFIED SURVEY MAP NO. 2284, BEING A PART OF THE NORTHWEST ¼ AND THE
 SOUTHWEST ¼ OF SECTION 1, TOWN 1 NORTH, RANGE 15 EAST, IN THE TOWN OF SHARON,
 COUNTY OF WALWORTH, STATE OF WISCONSIN.
 LOT AREA: 5.7517 ACRES PER CSM
 ADDRESS: N2311 USH "14"
 TAX KEY NO: AA228400001

STATE OF WISCONSIN
 COUNTY OF RACINE
 The above-described property has been surveyed under my direction and
 the above map is a correct representation thereof.
 DATED AT: NORTH CAPE, THIS 1ST DAY OF SEPTEMBER, 2013.
Pete L. Bailey
 AMERICAN SURVEYING COMPANY, INC.
 PETE L. BAILEY, RLS NO. 1398
 RECERTIFIED this _____ day of _____, 2013.

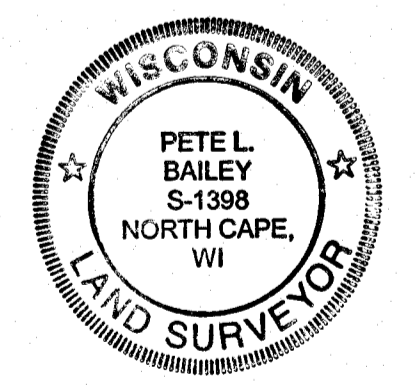

Pete L. Bailey



AMERICAN SURVEYING COMPANY, INC.
 12207 C.T.H. "K" FRANKSVILLE, WISCONSIN 53126
 TEL: (262) 835-4774 FAX: (262) 835-2379
 beaufordbailey@hotmail.com

DRAWN BY:	PLB	REVISIONS:	DATE
CHECKED BY:	PLB		
PLOT SCALE:	1 = 40		
DATE:	08/30/2013		
JOB NO.:	2013083		
DWG. FILE:	JN2013144	CLIENT NO.	04584

TOWN OF SHARON
 PROJECT:
PLAT OF SURVEY/STAKEOUT SURVEY
 PREPARED FOR: GREGORY KUHLEMEYER

Sheet
1
 of
1