

GEORGE T. DUNHAM
SURVEYING & SUBDIVIDING
DELAVER, WISCONSIN

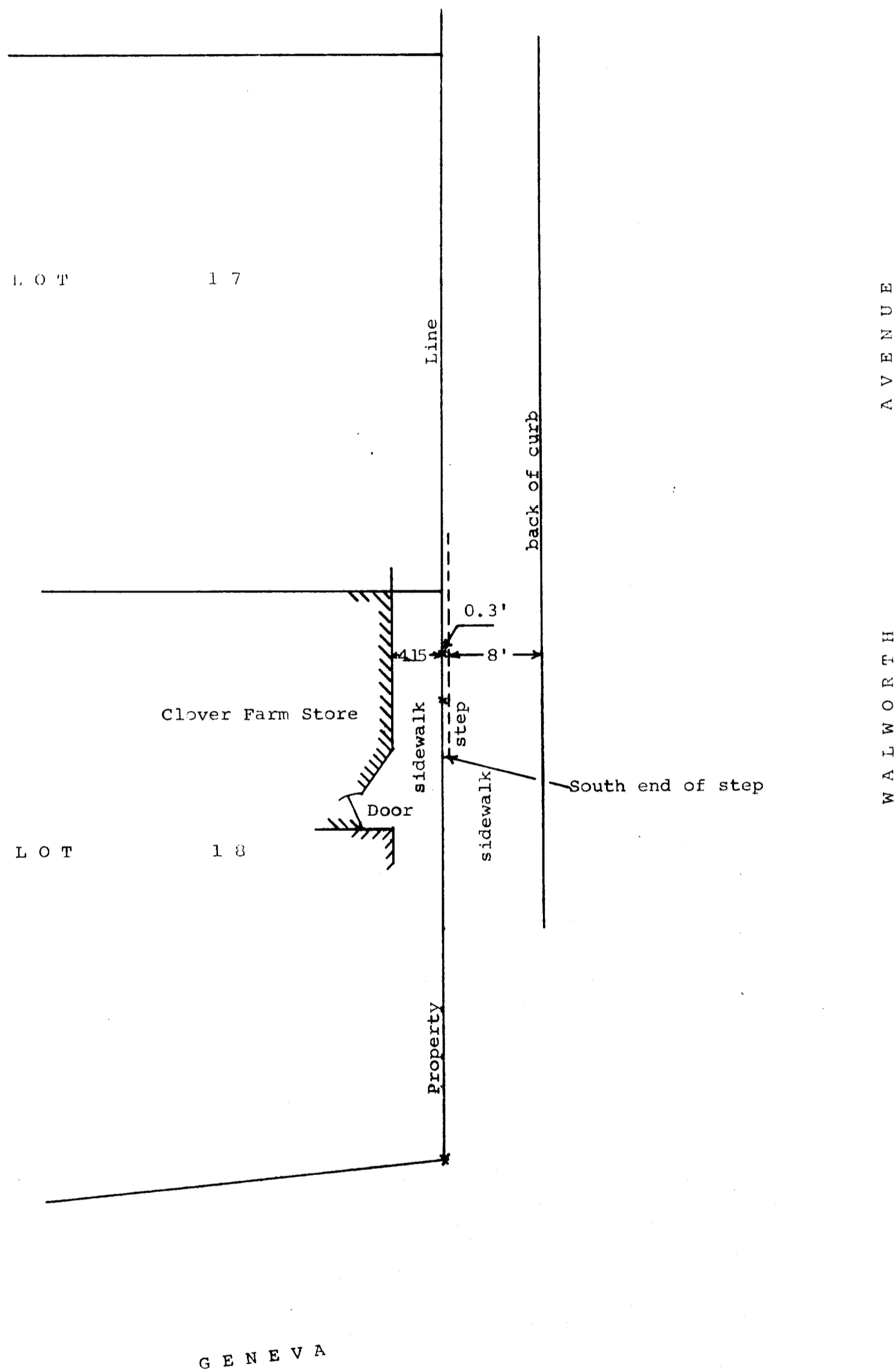

Scale - 1" = 10'
X = Cross in Concrete

STREET

GENEVA

Plat showing the front of Clover Farm Store, Sidewalk, Property line and Curb Line on Lot 18, Block 3 of the Original Plat of the Village of Williams Bay, Walworth County, Wisconsin.
January 13, 1966
Revised Feb. 9, 1967 *George T. Dunham*
George T. Dunham, Surveyor

