

LINE A-B ASSUMED N1°23'E
AS SHOWN ON SURVEYS OF RECORD

Plat of Survey of Tax Parcels WJA-00008 & WUUP-00038 WILLIAMS BAY, WALWORTH CO., WISCONSIN

FARRIS, HANSEN & ASSOCIATES, INC.
715 W. Walworth St. P.O. Box 487
Elkhorn, WI 53121

(xxx) = Record Dimension
O = Found Iron Pipe Survey Stake
MAP SCALE
1" = 20'

Spring St.
(66' WIDE)

Lot 6

Found Pipe 0.35' NW of
Fence Cor.

Found Pipe 0.65' NNE
OF FENCE COR. S.E.W.

Lot 11

Johnson's Addition
Lot 10

Lot 9

FOUND PIPE 0.2' SE.
OF FENCE COR.

Found Pipe
0.35' SE. OF
FENCE COR.

WIRE FENCE

N 88° 59' E
25.40'

5' STRIP

PART OF
LOT 11

TOTAL AREA 9,305 SQ. FT.

Bldg. Cor. 0.2' Clear
EAVES ENCROACH 0.45'

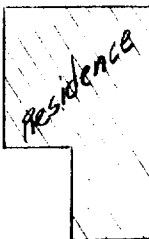
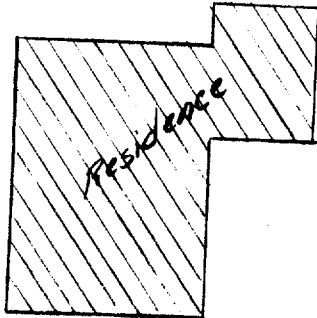

FENCE IN POOR CONDITION

N 88° 54' E 92.06'

Lot 11

Lot 12

STEEL FENCE COR. POST IS 1.33' N. & 0.20' E. OF PROPERTY COR.

Found Pipe 0.2' SW
of Fence Cor.

N 88° 54' E
65.82'

WORK ORDERED BY:
CRAIG CURRY

NOTE:

ALL FENCING APPEARS TO BE WITHIN 8 INCHES OF LOT
LINES EXCEPT WEST 1/2 OF SOUTH PROPERTY LINE AS SHOWN.

I HEREBY CERTIFY THAT THIS PLAT IS A TRUE AND
ACCURATE REPRESENTATION OF THE BOUNDARY
LINES OF THE ABOVE DESCRIBED PARCELS TO THE
BEST OF MY PROFESSIONAL KNOWLEDGE AND
BELIEF. 3 OCT. 1983

Robert A. Farris

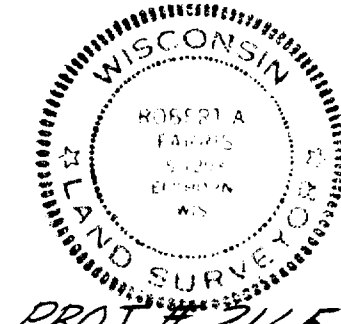

11-438