

WILLIAMS BAY VILLAGE LIMITS

PROPOSED ANNEXATION OF
A PARCEL OF LAND LOCATED IN THE SOUTHWEST $\frac{1}{4}$ AND THE SOUTHEAST $\frac{1}{4}$ OF SECTION 31, T 2 N, R 17 E, WALWORTH COUNTY, WISCONSIN, AND DESCRIBED AS FOLLOWS: BEGINNING AT THE SOUTH $\frac{1}{4}$ CORNER OF SAID SECTION 31, THENCE S89°28'05\"/>

OWNER: VEPACA ESTATES PARTNERS

NOTE: BEARINGS ASSUMED FROM EXISTING SURVEY RECORDS.

SCALE: 1"=200'

VILLAGE LIMITS

I, HAROLD H. KOLB, DO HEREBY CERTIFY THAT I HAVE SURVEYED THE PROPERTY HEREON DESCRIBED ACCORDING TO THE OFFICIAL RECORDS, AND THAT THE PLAT HEREON IS A CORRECT REPRESENTATION OF THE PROPERTY LINES TO THE BEST OF MY KNOWLEDGE AND BELIEF.

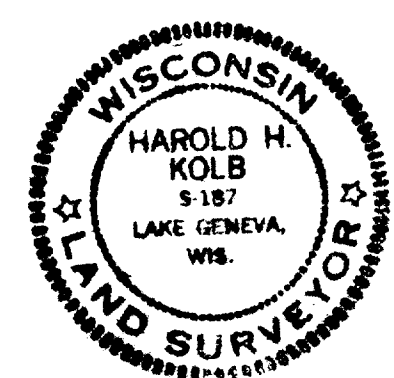

Harold H. Kolb
HAROLD H. KOLB
WISCONSIN REGISTERED LAND SURVEYOR, S-187
DATE JUNE 20, 1979
REVISED: JULY 2, 1979
REVISED: JULY 13, 1979
REVISED: JULY 1, 1980

ORDINANCE 9-80

ORDINANCE ANNEXING TERRITORY TO THE
VILLAGE OF WILLIAMS BAY, WISCONSIN

The Village Board of the Village of Williams Bay,
Wisconsin, do ordain as follows:

Section 1. Territory Annexed. In accordance with
the provisions of §66.021, Stats., and the Petition for direct
annexation filed with the Village Clerk on the 18th day of
February, 1980, said Petition being signed by all the owners
of record in the territory proposed to be annexed and signed
also by all of the electors in said territory being described
as a parcel of land located in the Town of Geneva in Walworth
County, Wisconsin, to-wit:

A parcel of land located in the Southwest 1/4
and the Southeast 1/4 of Section 31, T 2 N,
R 17 E, Walworth County, Wisconsin, and de-
scribed as follows: Beginning at the South
1/4 corner of said Section 31, thence S89°28'05"
E 680.50 feet; thence along the arc of a curve
to the right, the radius being 2072.41 feet and
the chord bearing N46°35'55"E 902.11 feet; thence
N51°33'30"W 724.11 feet; thence S75°53'50"W
864.91 feet; thence S0°20'25"W 220.94 feet;
thence N89°39'35"W 536.26 feet; thence N28°48'
10"W 148.86 feet; thence N22°12'00"W 331.61
feet; thence N0°56'50"W 329.72 feet; thence
N68°30'05"E 367.77 feet; thence S82°32'45"E
233.68 feet; thence N7°27'15"E 117.18 feet;
thence S82°32'45"E 239.62 feet; thence N12°14'
25"E 349.34 feet; thence N29°23'00"W 853.91
feet; thence N89°25'35"W 2047.72 feet; thence
S1°04'15"W 660.00 feet; thence N89°25'35"W
198.00 feet; thence S1°04'15"W 1984.37 feet;
thence S89°29'45"E 2581.50 feet to the place
of beginning. Containing 159.01 acres.

is hereby annexed to the Village of Williams Bay, Walworth
County, Wisconsin.

11-421

Section 2. From and after the date of this Ordinance
the territory described in the preceding Section shall be a
part of the Village of Williams Bay for any and all purposes
provided by law and all persons coming or residing within such

59411

VILLAGE OF WILLIAMS BAY

P.O. BOX 580
WILLIAMS BAY, WISCONSIN 53191



STATE OF WISCONSIN)
COUNTY OF WALWORTH) SS.

I, Virginia L. Stenus, Clerk of the Village of Williams Bay, do hereby certify that the attached is a true and correct copy of Ordinance No. 9-80, entitled "ORDINANCE ANNEXING TERRITORY TO THE VILLAGE OF WILLIAMS BAY, WISCONSIN," and I do hereby further certify that the attached plat and certificate is a true and correct copy as filed with said Village, said plat having been prepared by Harold H. Kolb and being dated June 20, 1979, revised July 2, 1979 and revised July 13, 1979.

I have hereunto set my hand and affixed the seal of the Village of Williams Bay, State of Wisconsin, this 25 day of June, A.D., 1980.

Virginia L. Stenus
Virginia L. Stenus
Clerk of the Village of Williams
Bay, Walworth County, Wisconsin.



10/15/80
R-106 11-78

State of Wisconsin / Department of Transportation

62697

DOCUMENT NO. VOL 258 PAGE 758

AWARD OF DAMAGES
BY STATE OF WISCONSIN
Section 84.09(2)

This award of damages is made pursuant to a relocation order of the State of Wisconsin Department of Transportation, dated February 7, 1980, and filed in the office of the County Clerk of Walworth County, for the improvement of State Trunk Highway 50, in Walworth County.

The State of Wisconsin has determined it necessary to acquire, for the purpose set forth in and in accordance with said relocation order, a parcel of real estate and/or rights therein as hereinafter set forth, in and to which the following persons have an interest: Paul Brandel A/K/A Paul W. Brandel; LaSalle National Bank; Equitable Life Assurance Society of the United States; Vepaca Estates Partners; Walworth County Treasurer

The interest acquired by this award is

Fee title in and to the following tract of land in Walworth County, State of Wisconsin, described as that part of the Southeast one-quarter of Section 31, Township 2 North, Range 17 East, described as follows: Commence at the southwest corner of said Southeast one-quarter; thence North 88° 31' 30" East along the south line of said Southeast one-quarter 2257.38 feet; thence North 53° 33' West along the tangent of the reference line of S.T.H. 50 and said reference line, 979.76 feet to the owner's southeasterly property line and the point of beginning; thence southwesterly along the curve of said southeasterly property line to a point which is 100.00 feet South 36° 27' West of the reference line of S.T.H. 50; thence North 53° 33' West 109.5 feet to the owner's northwesterly property line; thence northeasterly along the curve of said property line to the reference line of S.T.H. 50; thence South 53° 33' East along said line 109.5 feet to the point of beginning.

This parcel contains 0.17 acre, more or less, exclusive of lands previously conveyed or dedicated for highway purposes.

Said parcel of real estate and/or interests therein will be occupied by the State of Wisconsin or its agents on October 1, 1980. However, at the sole discretion of the State of Wisconsin, said parcel and/or interests therein may be reasonably occupied after the date of acquisition by utility companies for the purpose of adjusting their facilities to accommodate the proposed highway construction.

Said parcel of real estate and/or interests therein will be occupied by the State of Wisconsin or its agents on October 1, 1980.

The State of Wisconsin, having complied with all jurisdictional requirements pursuant to law, hereby makes this award of damages to the above persons having an interest in said parcel of real estate, in the sum of One Hundred Fifty and 00/100

Dollars (\$ 150.00), for the acquisition of said parcel of real estate and/or interests therein as hereinbefore set forth.

RECEIVED FOR RECORD

9th DAY OF October
A.D. 1980

State of Wisconsin / Department of Transportation

11-421