

**REGISTERED PROFESSIONAL LAND SURVEYOR
LAKE GENEVA, WISCONSIN**

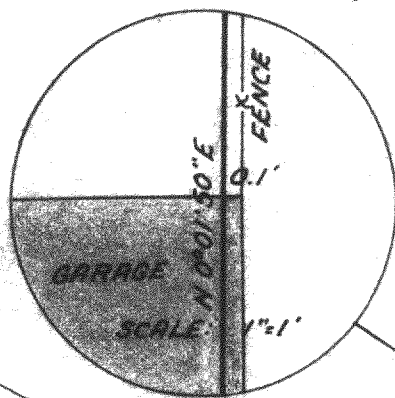
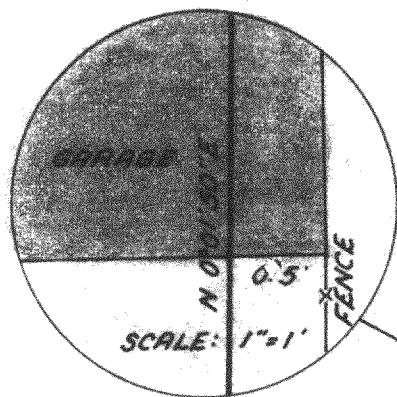

A PARCEL OF LAND LOCATED IN THE NORTHEAST 1/4 OF SECTION 1, T1N, R16E, VILLAGE OF WILLIAMS BAY, WALWORTH COUNTY, WISCONSIN, DESCRIBED AS FOLLOWS: COMMENCING AT THE SOUTHEAST CORNER OF DODGE SUBDIVISION LOCATED IN SAID NORTHEAST 1/4; THENCE NORTH 252.00 FEET ALONG THE EAST LINES OF LOT 4 AND LOT 1 OF SAID DODGE SUBDIVISION TO THE PLACE OF BEGINNING; THENCE CONTINUE NORTH 174.95 FEET ALONG THE EAST LINE OF SAID LOT 1 TO THE SOUTHERLY RIGHT-OF-WAY LINE OF GENEVA STREET; THENCE N 59°15'45" E 77.26 FEET ALONG SAID SOUTHERLY RIGHT-OF-WAY LINE; THENCE S 0°01'50" W 220.53 FEET ALONG THE WEST LINE OF BLOCK 5, ORIGINAL PLAT OF THE VILLAGE OF WILLIAMS BAY; THENCE N 84°44'50" W 66.57 FEET TO THE PLACE OF BEGINNING.
CONTAINING 0.30 ACRE.

NOTE: THE EAST LINE OF DODGE SUBDIVISION IS
ASSUMED "NORTH" AS DESCRIBED IN
VOLUME 338, PAGE 239 OF DEEDS.

OWNER: DENNIS RADERS

ORDERED BY: C. JEAN RAY REALTY
LAKE GENEVA, WI

I HAVE SURVEYED THE ABOVE-DESCRIBED PROPERTY AND THE ABOVE MAP IS A TRUE REPRESENTATION THEREOF AND SHOWS THE SIZE AND LOCATION OF THE PROPERTY, ITS EXTERIOR BOUNDARIES, THE LOCATION OF ALL APPARENT EASEMENTS AND ROADWAYS AND VISIBLE ENCROACHMENTS, IF ANY

THIS SURVEY IS MADE FOR THE USE OF THE PRESENT OWNERS OF THE PROPERTY, AND ALSO THOSE WHO PURCHASE, MORTGAGE, OR GUARANTEE THE TITLE THERETO WITHIN ONE (1) YEAR FROM DATE HEREOF.

HAROLD H. KOLB
WISCONSIN REGISTERED LAND SURVEYOR, S-187

DATE July 13, 1977



SCALE: 1"=30'

LEGEND

- φ — IRON PIPE FOUND
 ○ — IRON PIPE PLACED
 ▨ — IRON ROD FOUND
 () — DESCRIBED AS

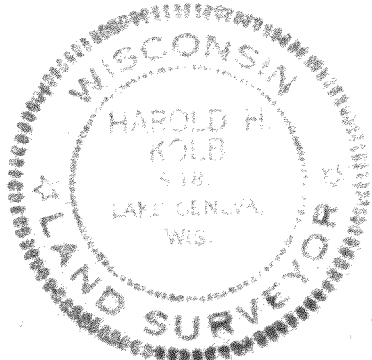

SOUTHEAST CORNER-
DODGE SUBDIVISION

WVVP 32

BRUNING 40-108 500-6-71

11-366