

PLAT OF SURVEY

PART OF LOT 6 OF OBSERVATORY SUBDIVISION, BEING A PART OF THE NW. 1/4 OF THE SW. 1/4 OF SECTION 1, T1N, RANGE 16E, VILLAGE OF WILLIAMS BAY, WALWORTH COUNTY, WISCONSIN.

SURVEYOR:
KEITH A. KINDRED, PLS S-2082
SEH, INC.
501 MAPLE AVE.
DELAFIELD, WI 53018
(414) 949-8919
KKINDRED@SEHINC.COM

SURVEY FOR:
DON CINKUS
1N782 FRANCIS ROAD
MAPLE PARK, IL 60151

LEGAL DESCRIPTION

PER COMMITMENT NO: WA-15723

A parcel located in Lot 6 of Observatory Subdivision, Village of Williams Bay, Walworth County, Wisconsin, described as follows: Commencing at a point 20 ft. W. 454 ft. N. of the S.E. corner of Lot No. 6 in the Observatory Subdivision, so called, in the SW $\frac{1}{4}$ of Sec 1 in T.1N. R.16E. Walworth County, Wisconsin, according to the plat of said subdivision on record in the Register's Office in and for said County aforesaid, thence running W. 60ft., thence N. on the highway, thence E. 60 ft., thence running S. to the place of beginning.
EXCEPTION THEREFROM a parcel located in Lot 6 of Observatory Subdivision, Village of Williams Bay, Walworth County, Wisconsin, described as follows: Commencing at the Southwest corner of Lot 6 of said Observatory Subdivision; thence N00°57'00"W 454.00 ft. along the West line of said Lot 6 to the place beginning; thence continue N00°57'00"W 15.11 ft. along said West line; thence N86°45'20"E 122.32 ft. to the West line of Parkhurst Place; thence S00°57'00"E 15.11 ft. along said West line of Parkhurst Place; thence S86°45'20"W 122.32 ft. to the place of beginning.

Tax Key No WOB 00012

EXCEPTIONS:

PER COMMITMENT NO: WA-15723

11. Encroachments as referenced in Quit Claim Deed dated April 12, 2019 and recorded April 15, 2019 as Doc No. #985267

SURVEYOR'S CERTIFICATE

I HEREBY CERTIFY THAT I HAVE SURVEYED THE ABOVE DESCRIBED PROPERTY AND THAT THE ABOVE MAP IS A TRUE REPRESENTATION THEREOF AND SHOWS THE SIZE AND LOCATION OF THE PROPERTY, ITS EXTERIOR BOUNDARIES, THE LOCATION OF ALL VISIBLE STRUCTURES AND DIMENSIONS OF ALL PRINCIPAL BUILDINGS THEREON, BOUNDARY FENCES, APPARENT EASEMENTS, ROADWAYS, AND VISIBLE ENCROACHMENTS, IF ANY.
THIS SURVEY IS MADE FOR THE USE OF THE PRESENT OWNERS OF THE PROPERTY, AND ALSO THOSE WHO PURCHASE, MORTGAGE, OR GUARANTEE THE TITLE THERETO WITHIN ONE (1) YEAR FROM DATE HEREOF.

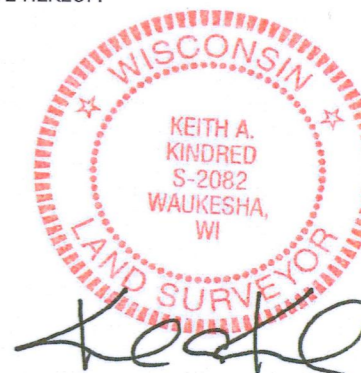
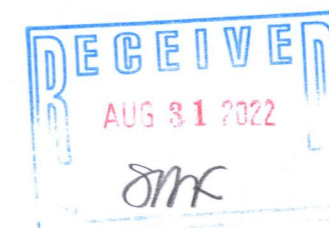

LEGEND

- - 1" IRON PIPE FOUND (UNLESS OTHERWISE STATED)
- - INLET
- - SIGN
- ⦿ - POWER POLE
- G — - UNDERGROUND GAS

DATED THIS 22ND DAY OF DECEMBER, 2020.



PHONE: 414.949.8962
501 MAPLE AVENUE
DELAFIELD, WI 53018-9351
www.sehinc.com

PROJECT CINKD #158449

WOB-12

011-3158