

PLAT OF SURVEY

A PARCEL OF LAND LOCATED IN THE SOUTHWEST 1/4 OF THE NORTHWEST 1/4 OF SECTION 1 IN TOWNSHIP 1 NORTH, RANGE 16 EAST, IN THE VILLAGE OF WILLIAMS BAY, WALWORTH COUNTY, WISCONSIN.

LEGEND

●

FOUND IRON ROD

○

SET 1" IRON PIPE

U

UTILITY PEDESTAL

T

TRANSFORMER

(XX)

RECORDED AS

EXISTING CONCRETE

EXISTING ASPHALT DRIVE

EXISTING BUILDING

EXISTING DECK

N

0

30

60

Feet

SCALE: 1"=30'

NOTE:
1. BASIS OF BEARING: THE WISCONSIN STATE PLANE COORDINATE SYSTEM, NAD-83, SOUTH ZONE.
2. FIELD WORK COMPLETED APRIL 12, 2021
3. BUILDING SURVEYED TO THE EXTERIOR OF SIDING.
4. FIELD CREW CHIEF: LOGAN RANDLE

LEGAL DESCRIPTION:

A PARCEL OF LAND LOCATED IN THE SOUTHWEST 1/4 OF THE NORTHWEST 1/4 OF SECTION 1 IN TOWNSHIP 1 NORTH, RANGE 16 EAST, IN THE VILLAGE OF WILLIAMS BAY, WALWORTH COUNTY, WISCONSIN, MORE PARTICULARLY DESCRIBED AS:

LOT 131 OF BAYWOOD HEIGHTS ADDITION NO.2 AS PER DOCUMENT NO. 197248 AS RECORDED IN THE WALWORTH COUNTY REGISTER OF DEEDS.

SURVEY ORDERED BY:

BRIAN POLLARD

PROPERTY ADDRESS:

380 FROST DR
WILLIAMS BAY, WI 53191

SURVEYOR:

PAUL H. VAN HENKELUM, PLS
CARDINAL ENGINEERING LLC

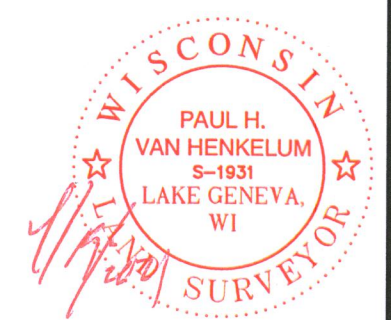

"I HEREBY CERTIFY THAT I HAVE SURVEYED THE ABOVE DESCRIBED PROPERTY AND THE MAP IS A TRUE AND CORRECT REPRESENTATION OF ITS EXTERIOR BOUNDARIES AND SHOWS THE SIZE AND LOCATION OF ALL VISIBLE STRUCTURES, APPARENT EASEMENTS AND ENCROACHMENTS, IF ANY."

Paul H. Van Henkelum
PAUL H. VAN HENKELUM, PLS #1931

4/19/2021
DATE

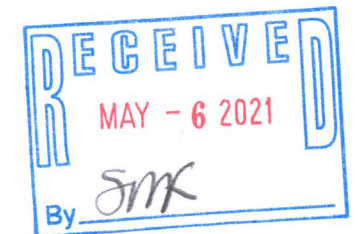

CARDINAL ENGINEERING LLC
DESIGNING IN TRUE DIRECTIONS

PO BOX 281 - 1200 LA SALLE ST.
LAKE GENEVA, WI 53147
262-757-8776
CARDINALENGINEERINGWI.COM

DATE: 04/14/2021 JOB No. 21374
SHEET 1 OF 1 EJO

WBWA-82

011-3010