

Witness Corner
East-West 1/4 Line
Section 6-1-17
N - 213.104.01
E - 2,398.221.06
Elev. 878.28

Birch

Grove

Park

Plat of Survey

of
Lot 24 of Cedar Point Park 1st Addition,
a subdivision located in the Southeast 1/4 of Section 6, Town 1 North, Range
17 East, Village of Williams Bay, Walworth County, Wisconsin.

Surveyed for: **Harry & Linda Hagy**
525 Blackstone Avenue
Lagrange, Illinois 60525
&
Hummel Construction
N1958 County Road O
Delavan, Wisconsin 53115

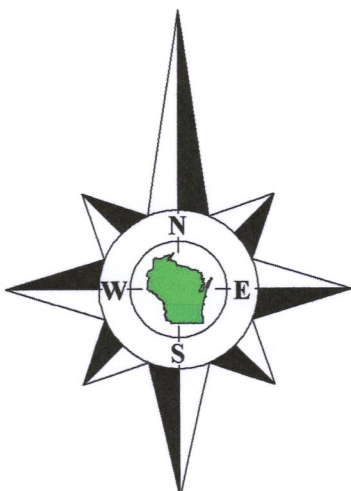

Bearings reference to the Wisconsin State
Plane Coordinate System, South Zone.

**Poured Concrete
Foundation**
Measured November 8, 2019.

**House
No. 76**

**House
No. 86**

**Lot 24
Tax Parcel
WCP1 00025**
0.213 Acre
9,293 Sq.Ft.

Lot 23

Lot 25

Garage

Birch Walnut Drive
(40' Wide)

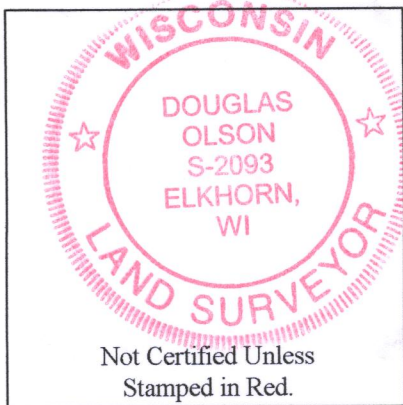

Notes:

- 1) This survey plat is not certified unless signed and sealed in red ink.
- 2) This survey is subject to Wisconsin lien laws. This Plat of Survey is the notice of intent to file lien. Lien waiver required.

Copyright 2015 by Olson Land Surveying, LLC.

All rights reserved. No part of this survey plat may be reproduced or transmitted in any form by any means - graphic, electronic, or mechanical, including photocopying, tracing, or information storage and retrieval systems - without permission in writing from Douglas G. Olson, Olson Land Surveying, LLC.

I, Douglas G. Olson, Wisconsin Professional Land Surveyor, do hereby certify that this survey was performed by me, or under my direction in full compliance with the owner's/agent's instructions and Chapter A-E 7 of the Wisconsin Administrative Code "Minimum Standards for Property Surveys", and that this map is an accurate representation thereof to the best of my knowledge and belief.

Douglas G. Olson
Wisconsin Professional Land Surveyor - 2093

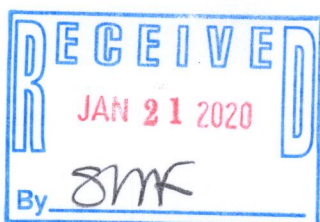

2019.098

Sheet 1 of 1 Sheets

Drawing Name:

Job Reference Number

2019.098

Legend

- Found County Section Corner
- Found Concrete Monument
- Found Iron Pipe
- Found Iron Rod
- Set Iron Pipe, 1" dia.
- Recorded Information
- Utility Pole
- Utility Pedestal
- Water Valve
- Drain
- Asphalt Surface
- Concrete Surface
- Deciduous Tree
- Brick Pavers



Olson Land Surveying, LLC

45 South Wisconsin Street * P.O. Box 322 * Elkhorn, Wisconsin. 53121
Telephone: (262) 723-3434 * Facsimile: (262) 723-8044
Email: doug@olsonsurveying.com

Scale in Feet

1" = 10'

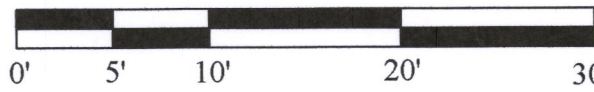

Survey date: August 3, 2015.

Revisions: No. 1 - Poured Concrete Foundation

WCP1-25

011-2936