

# Plat of Survey

of

## Lot 10, except the South 6 feet, and Lot 11 of Carlson's Addition to Williams Bay,

a subdivision located in the Northwest 1/4 of the Northeast 1/4 of Section 1, Town  
1 North, Range 16 East, Village of Williams Bay, Walworth County, Wisconsin.

Surveyed for: **Jeff Wolski**  
72 Stam Street  
Williams Bay, Wisconsin. 53191

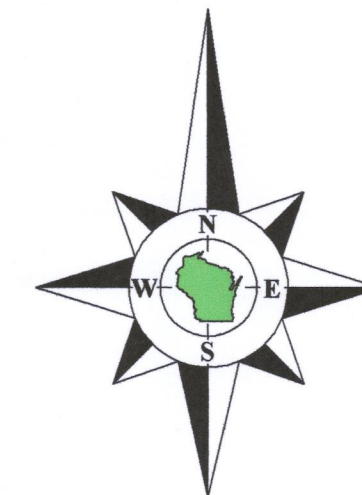

Bearings referenced to the West line of Vernon Street,  
recorded as South on the plat of Carlson's Addition to  
Williams Bay.

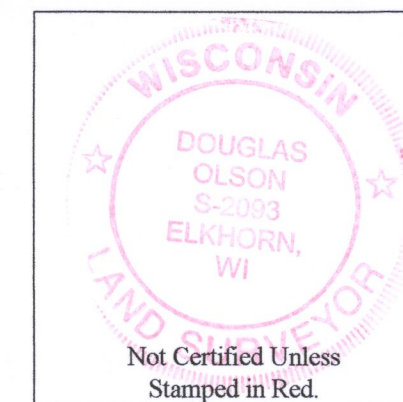

### Notes:

- 1) This Plat of Survey is not certified unless signed and sealed in red ink.
- 2) This survey is subject to Wisconsin lien laws. This Plat of Survey is the notice of intent to file lien. Lien waiver required.
- 3) The Survey Date shown on this Plat of Survey is the completion date of the field work.

Copyright ©2018 by Olson Land Surveying, LLC.

All rights reserved. No part of this survey plat may be reproduced or transmitted in any form by any means - graphic, electronic, or mechanical, including photocopying, tracing, or information storage and retrieval systems - without permission in writing from Douglas G. Olson, Olson Land Surveying, LLC.

I hereby certify that I have surveyed the above described property in compliance with Chapter A-E 7 of the Wisconsin Administrative Code and that the map hereon is correct to the best of my professional knowledge and belief and shows the size and location of the property, its exterior boundaries, the location and dimensions of all visible structures thereon, boundary fences, apparent easements and roadways and visible encroachments, if any.

This survey is made for the exclusive use of the present owners of the property, and also those who purchase, mortgage or guarantee title thereto, within one year from the date hereof.

Douglas G. Olson  
Wisconsin Professional Land Surveyor - 2093

Survey Date: August 28, 2018.  
Revisions:

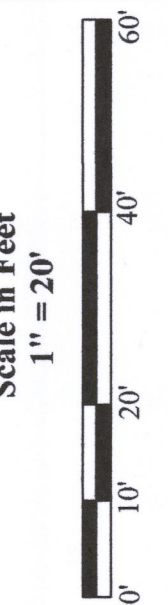

45 South Wisconsin Street | P.O. Box 322  
Elkhorn, Wisconsin. 53121  
Telephone: (262) 723-3434  
Facsimile: (262) 723-8044  
Email: doug@olsonsurveying.com  
Website: www.olsonsurveying.com

**OLSON**  
LAND SURVEYING, LLC  
Rural | Residential | Commercial

Legend: Symbols & Abbreviations	North
	North
Found Iron Pipe	N
Found Iron Rod	W
Recorded Information	E
Utility Pedestal	S
Asphalt Surface	in
Concrete Surface	ft
Brick Pavers	in

Sheet 1 of 1 Sheets  
Drawing Name  
Job Reference Number  
**2018.113**

**2018.113**



WCA-5 011-2873