

Northeast Corner of
Lot 6 in Block 1 of
University Heights.

recorded as(N0°46'W 1142.2')
N0°46'00"W 1141.85'

561.40'

recorded as(49.5')
N89°14'00"E 49.63'

recorded as(60')

119.78'

recorded as(60')

recorded as(60')
N0°43'58"W 60.02'

Stam Street
(49.5' Wide)

Overhead Wires

(49.5')
49.49'

Southeast Corner of
Lot 7 in Block 2 of
University Heights.

Lot 68

Lot 1
C.S.M. 4116

Lot 69

recorded as(S87°25'W 185')
N86°31'55"E 184.79'

55.40'

60.3'

61.4'

55.2'

59.99'
recorded as(60')

60.2'

60.6'

Lot 72
Tax Parcel
WBV 00041
0.254 Acre
11,056 Sq.Ft.

Proposed
House

Stone retaining
wall extends 2.7'
N. of line.
59.53'
S86°27'40"W 184.76'
recorded as(S87°25'W 185')

Covered
Deck

House
No. 73

Lot 73

S0°41'15"E 59.80'
recorded as(60')

Lot 74

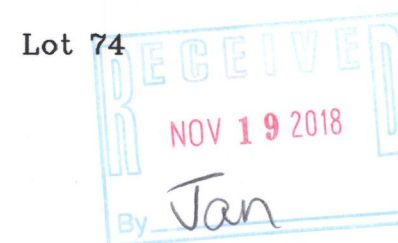

Copyright ©2017 by Olson Land Surveying, LLC.

All rights reserved. No part of this survey plat may be reproduced or transmitted in any form by any means - graphic, electronic, or mechanical, including photocopying, tracing, or information storage and retrieval systems - without permission in writing from Douglas G. Olson, Olson Land Surveying, LLC.

I hereby certify that I have surveyed the above described property in compliance with Chapter A-E 7 of the Wisconsin Administrative Code and that the map hereon is correct to the best of my professional knowledge and belief and shows the size and location of the property, its exterior boundaries, the location and dimensions of all visible structures thereon, boundary fences, apparent easements and roadways and visible encroachments, if any.

This survey is made for the exclusive use of the present owners of the property, and also those who purchase, mortgage or guarantee title thereto, within one year from the date hereof.

Douglas G. Olson
Wisconsin Professional Land Surveyor - 2093

Plat of Survey

of

Lot 72 of Bay View Subdivision,

located in the Northwest 1/4 of the Southeast 1/4 of Section 1, Town 1 North,
Range 16 East, Village of Williams Bay, Walworth County, Wisconsin.

Surveyed for: **GTS Contracting & Remodeling**
641 Shabbona Drive
Fontana, Wisconsin. 53125



Bearings referenced to the West line of Stam Street,
recorded as (N0°46'W) on the plat of University Heights.

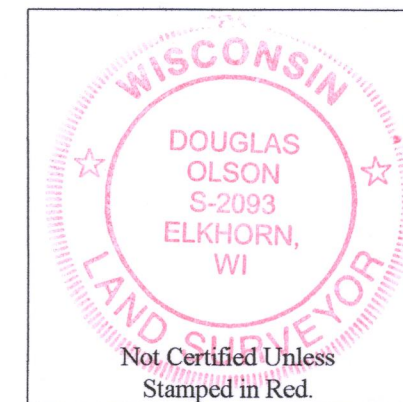

Notes:

- 1) This Plat of Survey is not certified unless signed and sealed in red ink.
- 2) This survey is subject to Wisconsin lien laws. This Plat of Survey is the notice of intent to file lien. Lien waiver required.
- 3) The Survey Date shown on this Plat of Survey is the completion date of the field work.

Survey Date: October 17, 2017.
Revisions: No. 1 - Proposed House
as Staked

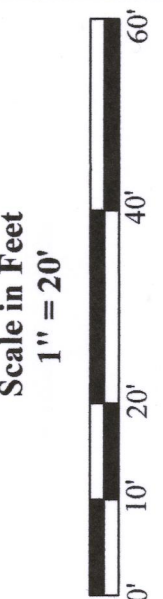

45 South Wisconsin Street | P.O. Box 322
Elkhorn, Wisconsin, 53121
Telephone: (262) 723-3434
Facsimile: (262) 723-8044
Email: doug@olsonsurveying.com
Website: www.olsonsurveying.com

OLSON
LAND SURVEYING, LLC
Rural | Residential | Commercial

Legend of Symbols & Abbreviations
North Arrow
Found Concrete Monument
Found Iron Pipe
Found Iron Rod
() Recorded Information
X Utility Pole
X Manhole
X Asphalt Surface
X Set Wood Stake
N North
S South
E East
W West
B Bearings
D Distances
M Minutes
S Seconds
F Feet
I Inches

Sheet 1 of 1 Sheets
Drawing Name
Job Reference Number
2018.097

2018.097

WBV-41 011-2863