

Plat of Survey

of

Lot 31 of Bay View Subdivision,

located in the Northwest 1/4 of the Southeast 1/4 of Section 1, Town 1 North,
Range 16 East, Village of Williams Bay, Walworth County, Wisconsin.

Surveyed for: **Keefe Real Estate, Inc.**

204 East Commerce Court
Elkhorn, Wisconsin. 53121

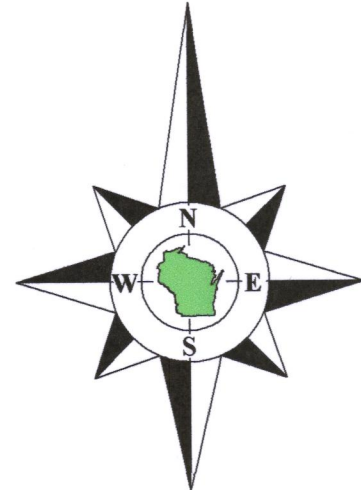

Bearings referenced to the North line of the Southeast 1/4 of Section 1-1-16,
recorded as N87°22'20"E in the Wisconsin State Plane Coordinate System,
South Zone, (NAD-27).

Coordinates are referenced to the Wisconsin State
Plane Coordinate System, South Zone, (NAD-27).

Alley (15' Wide)

Lot 32

Lot 33

Lot 4

Lot 5

Lot 6

Alley (15' Wide)

Lot 31
Tax Parcel
WBV 00007
0.220 Acre
9,570 Sq.Ft.

Garage

House
No. 18

S87°18'18"W 159.71'
recorded as(160')

N87°18'35"E 159.70'
recorded as(160')

S0°04'48"E 704.76'
recorded as(705')

S0°04'48"E 59.98'
recorded as(60')

Highland Street
(50' Wide)

S86°19'58"W 1768.67'

East 1/4 Corner
Section 1-1-16
N. 213,030.88
E. 2,393,062.28

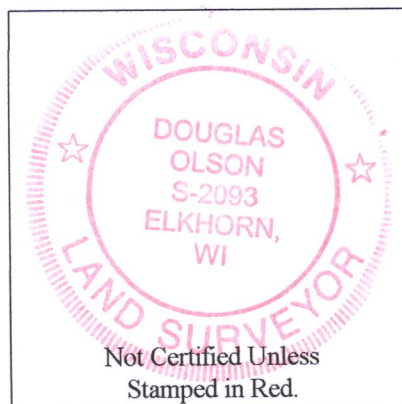

Notes:

- 1) This Plat of Survey is not certified unless signed and sealed in red ink.
- 2) This survey is subject to Wisconsin lien laws. This Plat of Survey is the notice of intent to file lien. Lien waiver required.
- 3) The Survey Date shown on this Plat of Survey is the completion date of the field work.

Copyright ©2018 by Olson Land Surveying, LLC.

All rights reserved. No part of this survey plat may be reproduced or transmitted in any form by any means - graphic, electronic, or mechanical, including photocopying, tracing, or information storage and retrieval systems - without permission in writing from Douglas G. Olson, Olson Land Surveying, LLC.

I hereby certify that I have surveyed the above described property in compliance with Chapter A-E 7 of the Wisconsin Administrative Code and that the map hereon is correct to the best of my professional knowledge and belief and shows the size and location of the property, its exterior boundaries, the location and dimensions of all visible structures thereon, boundary fences, apparent easements and roadways and visible encroachments, if any.

This survey is made for the exclusive use of the present owners of the property, and also those who purchase, mortgage or guarantee title thereto, within one year from the date hereof.

Douglas G. Olson
Wisconsin Professional Land Surveyor - 2093

Survey Date: May 8, 2018.
Revisions:

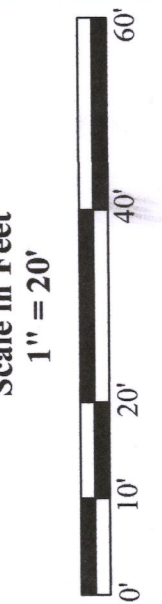

45 South Wisconsin Street | P.O. Box 322
Elkhorn, Wisconsin. 53121
Telephone: (262) 723-3434
Facsimile: (262) 723-8044
Email: doug@olsonsurveying.com
Website: www.olsonsurveying.com

OLSON
LAND SURVEYING, LLC
Rural | Residential | Commercial

Legend of Symbols & Abbreviations
N North
S South
E East
W West
In Bearings
In Minutes
In Seconds
In Feet
In Inches
Found County Section Corner
Found Iron Pipe
Found Iron Rod
Found Cut Cross
Found Information
Found Pole
Found Utility Pedestal
Found Asphalt Surface
Found Concrete Surface
Found Brick Pavers
Set Mag Nail
Water Valve
Manhole

Sheet 1 of 1 Sheets
Drawing Name:
Job Reference Number
2018.052
2018.052

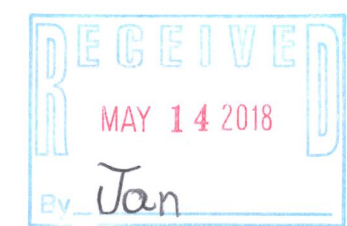

WBV-7

011-2831