

Plat of Survey

of
**Lots 2 & 3 and the West 66 feet of
Lot 1 in Block 4 of the Original Plat
of the Village of Williams Bay,**

located in the Southeast 1/4 of the Northeast 1/4 of Section 1,
Town 1 North, Range 16 East, Village of Williams Bay,
Walworth County, Wisconsin.

Surveyed for: **Village of Williams Bay**
250 Williams Street * P.O. Box 580
Williams Bay, Wisconsin. 53191



Bearings referenced to the South line of the Northeast 1/4 of Section 1-1-16,
recorded as N1°50'18\"/>

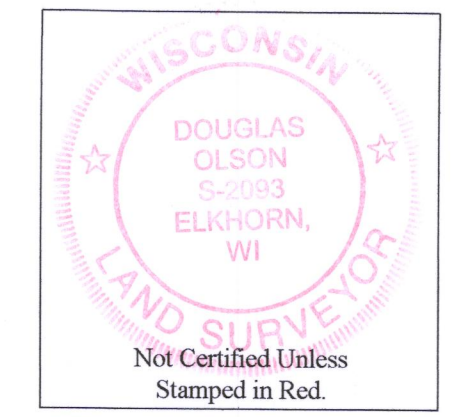
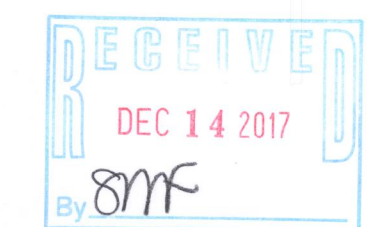

- Notes:**
- 1) This Plat of Survey is not certified unless signed and sealed in red ink.
 - 2) This survey is subject to Wisconsin lien laws. This Plat of Survey is the notice of intent to file lien. Lien waiver required.
 - 3) The Survey Date shown on this Plat of Survey is the completion date of the field work.

I hereby certify that I have surveyed the above described property in compliance
with Chapter A-E 7 of the Wisconsin Administrative Code and that the map hereon is
correct to the best of my knowledge and belief.

Douglas G. Olson
Wisconsin Professional Land Surveyor - 2093

Copyright ©2017 by Olson Land Surveying, LLC.

All rights reserved. No part of this survey plat may be reproduced or transmitted in
any form by any means - graphic, electronic, or mechanical, including photocopying,
tracing, or information storage and retrieval systems - without permission in writing
from Douglas G. Olson, Olson Land Surveying, LLC.

Survey Date: September 20, 2017
Revisions: No. 1 - Misc. Information

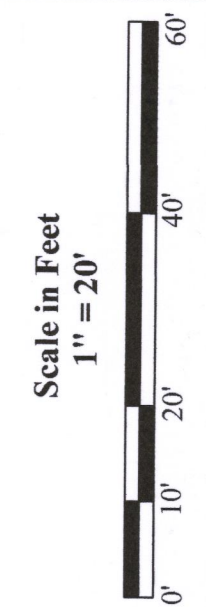

45 South Wisconsin Street | P.O. Box 322
Elkhorn, Wisconsin, 53121
Telephone: (262) 723-3434
Facsimile: (262) 723-8044
Email: doug@olsonsurveying.com
Website: www.olsonsurveying.com



Legend of Symbols & Abbreviations

Found Iron Pipe	North Arrow
Found Iron Rod	South Arrow
Set Chiseled Cross	East Arrow
Recorded Information	West Arrow
Utility Pole	Inches
Manhole	Feet
Concrete Surface	Minutes
Stone Surface	Seconds
Brick Pavers	

Sheet 1 of 1 Sheets
Drawing Name:
Job Reference Number
2017.102
2017.102