

Tax Parcel
JG 3100004

Property Exhibit

of

A Portion of Tax Parcel WWUP 00100,

located in the Southwest 1/4 of Section 31, Town 2 North, Range
17 East, Village of Williams Bay, Walworth County, Wisconsin.

Surveyed for:

Kishwaukee Nature Conservancy

P.O. Box 580
Williams Bay, Wisconsin. 53191



Bearings reference to the Wisconsin State
Plane Coordinate System, South Zone.

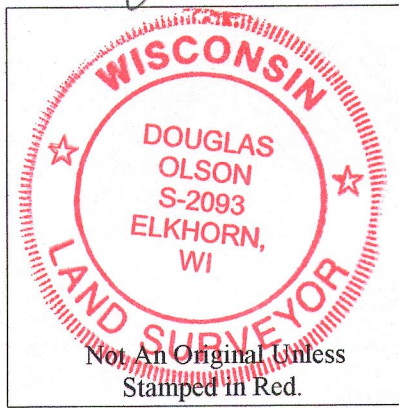

Notes:

- 1) This Property Exhibit is not an original unless signed and sealed in red ink.
- 2) This exhibit is subject to Wisconsin lien laws. This Property Exhibit is the notice of intent to file lien. Lien waiver required.

Copyright 2016 by Olson Land Surveying, LLC.

All rights reserved. No part of this survey plat may be reproduced or transmitted in any form by any means - graphic, electronic, or mechanical, including photocopying, tracing, or information storage and retrieval systems - without permission in writing from Douglas G. Olson, Olson Land Surveying, LLC.

I, Douglas G. Olson, Wisconsin Professional Land Surveyor, do hereby certify that this survey was performed by me, or under my direction in full compliance with the owner's/agent's instructions and Chapter A-E 7 of the Wisconsin Administrative Code "Minimum Standards for Property Surveys"; and that this map is an accurate representation thereof to the best of my knowledge and belief.

Douglas G. Olson
Wisconsin Professional Land Surveyor - 2093

State Trunk Highway 67
(130' Wide)

(N0°29'55"W 2644.32') State Plane
N0°29'55"W 2644.22'
West line of the Southwest 1/4 of Section 31-2-17.

Southwest Corner
Section 31-2-17
N. 215,899.11
E. 2,392,981.92

West 1/4 Corner
Section 31-2-17
N. 218,543.30
E. 2,392,958.91

N89°00'07"E 198.07'
(198.00')

Tax Parcel
JG 3100005

Tax Parcel
JG 3100005A

(198.00')
N89°05'09"E 197.86'
66.43' 132.86' 66.43'

(660.00')
Town of Geneva N0°28'50"W 680.11'

Village of Williams Bay

310.11'
(310.00')

Play
Structure

Kishwaukee Nature Conservancy

Tax Parcel
WWUP 00100

2016.037

Sheet 1 of 1 Sheets

Drawing Name:

Job Reference Number

2016.037

Legend

- Found County Section Corner
- Found Concrete Monument
- Found Iron Pipe
- Set Iron Pipe, 1" dia.
- Set Wood Lath
- () Recorded Information
- Manhole



Olson Land Surveying, LLC

45 South Wisconsin Street * P.O. Box 322 * Elkhorn, Wisconsin. 53121

Telephone: (262) 723-3434 * Facsimile: (262) 723-8044

Email: doug@olsonsurveying.com

Scale in Feet
1" = 40'



Survey Date: May 3, 2016.

Revisions:

WWUP-100

011-2645