

WORK ORDERED BY:  
LOWELL MANAGEMENT  
PO BOX 926  
LAKE GENEVA, WI. 53147

FARRIS, HANSEN & ASSOCIATES, INC.  
ENGINEERING - ARCHITECTURE - SURVEYING  
7 RIDGWAY COURT P.O. BOX 437  
ELKHORN, WISCONSIN 53121  
OFFICE: (262) 723-2098 FAX: (262) 723-5886

PROJECT NO.	9446
DATE	01-18-2016
SHEET NO.	1 OF 1

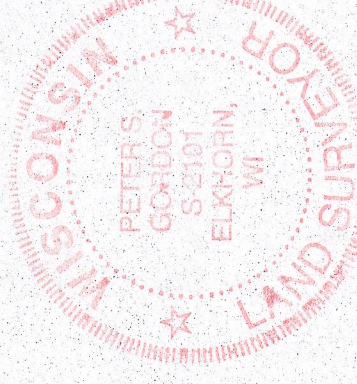
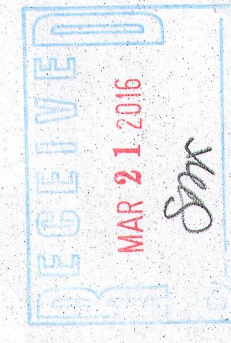

NOTE: COPIES OF THIS MAP TO WHICH THE FOLLOWING CERTIFICATE WILL APPLY SHOW THE SURVEYOR'S ORIGINAL SIGNATURE AND SIGNATURE WHICH DO NOT REPRESENT THE SURVEYOR'S WORK PRODUCT.  
I HEREBY CERTIFY THAT THE ABOVE DESCRIBED PROPERTY HAS BEEN SURVEYED UNDER MY DIRECTION AND THAT THE ABOVE MAP IS A TRUE AND ACCURATE REPRESENTATION OF THE PROPERTY AND ITS EXISTING BOUNDARIES. THIS SURVEY IS ALSO THOSE WHO PURCHASE, MORTGAGE OR GUARANTEE THE TITLE HEREIN WITHIN ONE YEAR FROM THE DATE HEREOF.  
DATED: JANUARY 18, 2016  
PETER S. GORDON P.L.S. 201

**BOUNDARY & TOPOGRAPHIC MAPPING**  
LOT 1 OF CERTIFIED SURVEY MAP NO. 3134  
PART OF THE SE 1/4 OF THE SE 1/4 SECTION 1  
TOWN 1 NORTH, RANGE 16 EAST &  
PART OF THE SW 1/4 OF THE SW 1/4 SECTION 6  
TOWN 1 NORTH, RANGE 17 EAST  
VILLAGE OF WILLIAMS BAY,  
WALWORTH COUNTY, WISCONSIN

ASSIGNED NW LINE LOT 1  
N 90°00'00" E



WMP 00078  
EXISTING RESIDENCE

WMP 00079  
EXISTING RESIDENCE

WMP 00080  
EXISTING RESIDENCE

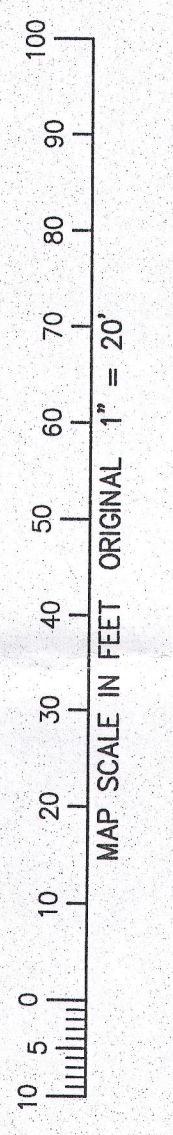
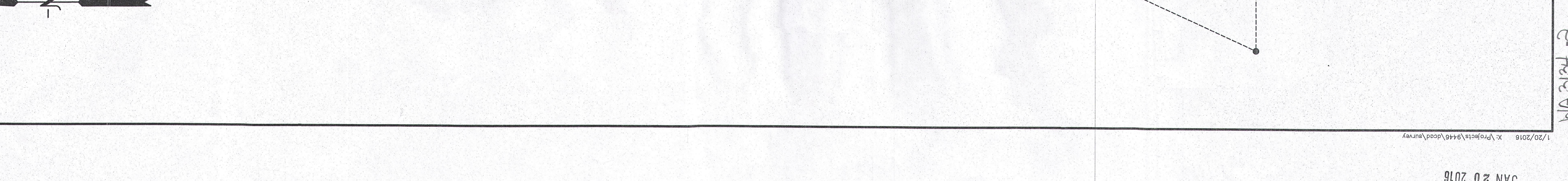

- LEGEND**
- = FOUND IRON PIPE STAKE
  - = FOUND IRON REBAR STAKE
  - ⊙ = SET IRON REBAR STAKE
  - ⊕ = FOUND IRON REBAR STAKE
  - ⊖ = FOUND CONCRETE MONUMENT
  - (XXX) = RECORDED AS

NA 3134

JAN 20 2016

1/20/2016 X:\Projects\9446\0001\map3134