

# PLAT OF SURVEY

## LOT 96 OF BAILEY ESTATES, A SUBDIVISION

LOCATED IN PART OF THE NW 1/4, NE 1/4, SE 1/4, AND  
SW 1/4 OF THE NW 1/4 OF SECTION 36, TOWN 2 NORTH,  
RANGE 16 EAST, VILLAGE OF WILLIAMS BAY,  
WALWORTH COUNTY, WISCONSIN

LEGEND  
● = SET IRON REBAR STAKE  
(XXX) = RECORDED AS

EXISTING EDGE OF  
PAVEMENT  
EXISTING EDGE OF  
GRAVEL

BENCH MARK  
CHISELED "X" ON  
RIM SANITARY  
MANHOLE  
ELEV.=1013.64'

ASHLEY DRIVE  
66' WIDE R.O.W.

EXTG. 8" SANITARY SEWER  
EXTG. 8" WATERMAIN

AS-BUILT  
FOUNDATION  
(FIELD LOCATED  
11/22/2005)  
T.F.=1019.43'

LOT 96  
51,246 S.F.

LOT 97

LOT 95

N 72°20'49" E  
264.18'

30' SIDE YARD

50' REAR YARD

30' DRAINAGE EASEMENT

10' UTILITY EASEMENT

S 01°13'31" E  
139.38'

C.S.M. 102

WORK ORDERED BY -  
RITA PARTSCH  
462 ASHLEY DRIVE  
WILLIAMS BAY, WI. 53191

FARRIS, HANSEN & ASSOCIATES, INC.  
ENGINEERING - ARCHITECTURE - SURVEYING  
7 RIDGWAY COURT P.O. BOX 437  
ELKHORN, WISCONSIN 53121  
OFFICE: (262) 723-2098 FAX: (262) 723-5886

REVISIONS

PROJECT NO.  
3249.96  
DATE:  
10/28/05  
SHEET NO.  
1 OF 1

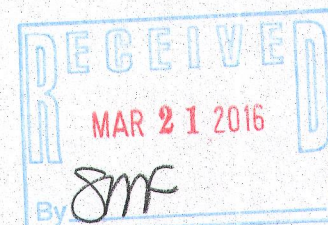
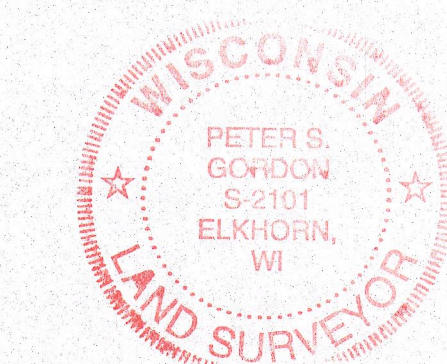

NOTE: COPIES OF THIS MAP TO WHICH THE FOLLOWING CERTIFICATE WILL APPLY SHOW  
THE SURVEYOR'S ORIGINAL SEAL AND SIGNATURE IN RED INK. COPIES BY ANY OTHER  
MEANS MAY HAVE ALTERATIONS WHICH DO NOT REPRESENT THE SURVEYOR'S WORK  
PRODUCT.

I HEREBY CERTIFY THAT THE ABOVE DESCRIBED PROPERTY HAS BEEN SURVEYED UNDER  
MY DIRECTION AND THAT THE ABOVE MAP IS A TRUE REPRESENTATION THEREOF AND  
SHOWS THE SIZE AND LOCATION OF THE PROPERTY, ITS EXTERIOR BOUNDARIES, THE  
LOCATION OF ALL VISIBLE STRUCTURES, AND DIMENSIONS OF ALL PRINCIPLE  
BUILDINGS THEREON, BOUNDARY FENCES, APPARENT EASEMENTS, ROADWAYS, AND  
VISIBLE ENCROACHMENTS, IF ANY. THIS SURVEY IS MADE FOR THE USE OF THE  
PRESENT OWNERS OF THE PROPERTY, AND ALSO THOSE WHO PURCHASE, MORTGAGE, OR  
GUARANTEE THE TITLE THERETO WITHIN ONE YEAR FROM THE DATE HEREOF.

DATED: OCTOBER 28, 2005

PETER S. GORDON

REVISED 11/23/2005  
TO SHOW SIZE AND LOCATION OF  
AS-BUILT FOUNDATION

REVISED 02/14/2006  
TO UPDATE TO TITLE  
SPECIFICATIONS

REVISED & RESURVEYED  
12-30-2015

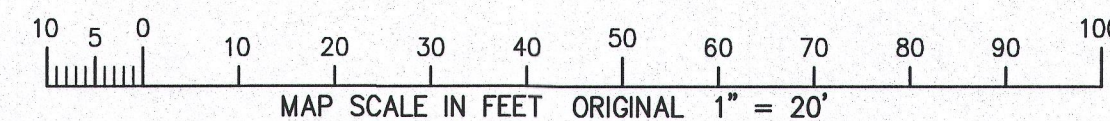

12/30/2015 X:\Projects\3249\INDIV.LOTS\Lot\_96\TITLESUR

WBAIL-96

011-2630