

SITE PLAN FOR PROPOSED SIGN LOCATION

LOCATED IN THE SOUTHWEST 1/4 OF SECTION 1, TOWN 1 NORTH, RANGE 16 EAST OF THE
FOURTH PRINCIPAL MERIDIAN, TOWN OF WALWORTH, WALWORTH COUNTY, WISCONSIN.

PREPARED FOR: SCHERRER CONSTRUCTION

WEST 1/4 CORNER
SEC. 1-1-16

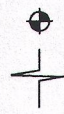

N.—LAKE—SHORE—DR.—



SOUTHWEST CORNER
SEC. 1-1-16

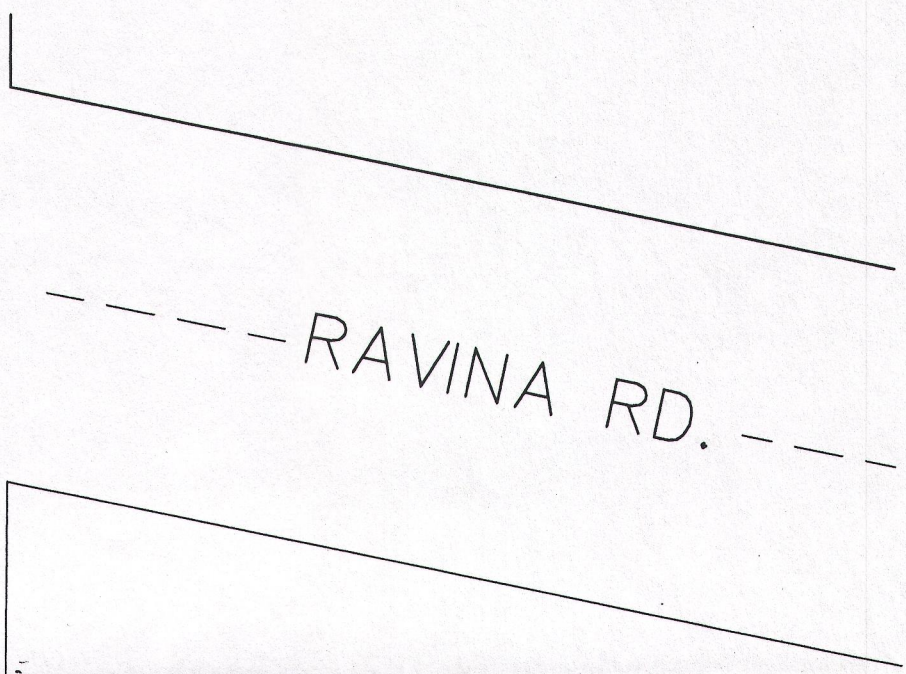

PROPOSED
SIGN

25'

40.5'

9.67'

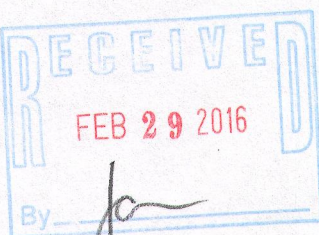

LEGEND

- FOUND IRON ROD
- SET NAIL
- ⊕ FOUND WALWORTH COUNTY
STANDARD MONUMENT

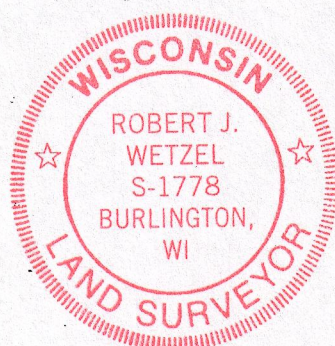

THIS IS NOT AN ORIGINAL PRINT
UNLESS THIS SEAL IS RED.

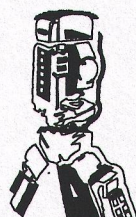

B.W. SURVEYING, INC.

412 N. PINE STREET
BURLINGTON, WI 53105
(262)-767-0225

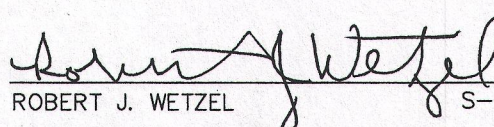
ROBERT J. WETZEL S-1778

MARCH 26, 2015
DATE

8929B
JOB NUMBER

WWUP-11

011-2629