

Plat of Survey

of

Lot 207 of Cedar Point Park,

a subdivision located in the Southeast 1/4 of Section 6, Town 1 North,
Range 17 East, Village of Williams Bay, Walworth County, Wisconsin.

Surveyed for: **John Bohm**
P.O. Box 125
Williams Bay, Wisconsin. 53191

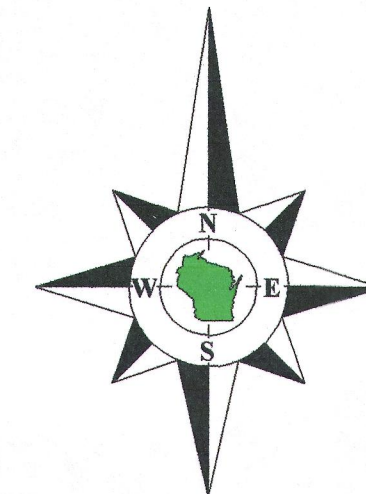

Bearings reference to the Wisconsin State
Plane Coordinate System, South Zone.

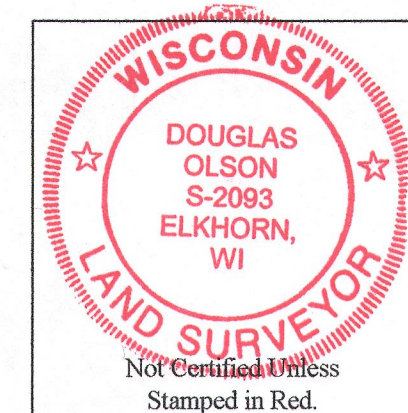

Notes:

- 1) This survey plat is not certified unless signed and sealed in red ink.
- 2) This survey is subject to Wisconsin lien laws. This Plat of Survey is the notice of intent to file lien. Lien waiver required.

Copyright 2011 by Jensen & Olson Land Surveying, LLC.

All rights reserved. No part of this survey plat may be reproduced or transmitted in any form by any means - graphic, electronic, or mechanical, including photocopying, tracing, or information storage and retrieval systems - without permission in writing from Douglas G. Olson, Jensen & Olson Land Surveying, LLC.

I, Douglas G. Olson, Wisconsin Registered Land Surveyor, do hereby certify that this survey was performed by me, or under my direction in full compliance with the owner's/agent's instructions and Chapter A-E 7 of the Wisconsin Administrative Code "Minimum Standards for Property Surveys", and that this map is an accurate representation thereof to the best of my knowledge and belief.

Douglas G. Olson
Wisconsin Registered Land Surveyor - 2093

Survey Date: April 21, 2011.
Revisions: No. 1 - As-built

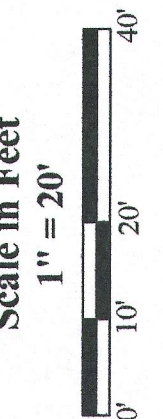

Jensen & Olson Land Surveying, LLC

45 South Wisconsin Street * P.O. Box 322 * Elkhorn, Wisconsin. 53121
Telephone: (262) 723-3434 * Facsimile: (262) 723-8044
Email: jensen.olson@elknet.net

Legend	
Found Concrete Monument	Tree & Tree Diameter
Found Iron Rod	Found Chiseled Cross
Found Chiseled Cross	Recorded Information
Recorded Information	Utility Pole
Utility Pole	Water Valve
Water Valve	Asphalt Surface
Asphalt Surface	Concrete Surface
Concrete Surface	Manhole
Manhole	Gravel

Sheet 1 of 1 Sheets
Drawing Name: Plat 12-201095-2012095PlatREV1.dwg
Job Reference Number
2012.095

2012.095

WCP-182

011-2582