

a subdivision located in the Northeast 1/4 of Section 1, Town 1 North,  
Range 16 East, Village of Williams Bay, Walworth County, Wisconsin.

Bearings reference to previous surveys of record.

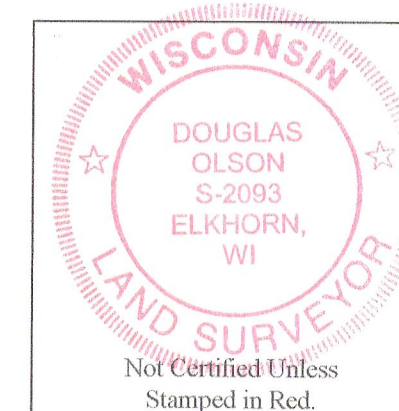

- 1) This survey plat is not certified unless signed and sealed in red ink.
- 2) This survey is subject to Wisconsin lien laws. This Plat of Survey is the notice of intent to file lien. Lien waiver required.

All rights reserved. No part of this survey plat may be reproduced or transmitted in any form by any means - graphic, electronic, or mechanical, including photocopying, tracing, or information storage and retrieval systems - without permission in writing from Douglas G. Olson, Jensen & Olson Land Surveying, LLC.

I hereby certify that I have surveyed the above described property and the map hereon is correct to the best of my professional knowledge and belief and shows the size and location of the property, its exterior boundaries, the location and dimensions of all visible structures thereon, boundary fences, apparent easements and roadways and visible encroachments, if any.









This survey is made for the exclusive use of the present owners of the property, and also those who purchase, mortgage or guarantee title thereto, within one year from the date hereof.

Douglas G. Olson  
Wisconsin Registered Land Surveyor - 2093

**Scale in Feet**  
**1" = 20'**

 **Jensen & Olson Land Surveying, LLC**  
45 South Wisconsin Street \* P.O. Box 322 \* Elkhorn, Wisconsin, 53121  
Telephone: (262) 723-3434 \* Facsimile: (262) 723-8044  
Email: [jensen.olson@elknet.net](mailto:jensen.olson@elknet.net)

**Legend**

	Found Concrete Monument
	Found Iron Pipe
	Found Wood Lath
	Recorded Information
	Utility Pole
	PVC Pipe
	Asphalt Surface
	Concrete Surface

Sheet 1 of 1 Sheets

2011.111

WOP-240

011-2404