

LOCATED IN THE NE 1/4 AND THE NW 1/4  
OF THE NW 1/4 OF SECTION 1, TOWN 1 NORTH,  
RANGE 16 EAST, VILLAGE OF WILLIAMS BAY,  
WALWORTH COUNTY, WISCONSIN

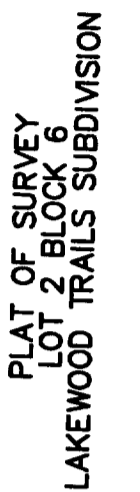

WORK ORDERED BY: WOODCRAFTERS  
JIM SHAFER  
717 MARA WOOD DRIVE  
WOODSTOCK, IL. 60098

**FARRIS, HANSEN & ASSOCIATES, INC.**  
Engineering, Architecture, Surveying  
7 Ridgway Court P.O. Box 437  
ELKHORN, WISCONSIN 53121  
Office: (262) 723-2098  
Fax: (262) 723-5886

## REVISIONS

PROJECT NO.	3836.06.02
DATE:	06/03/02
SHEET NO.	1 OF 1

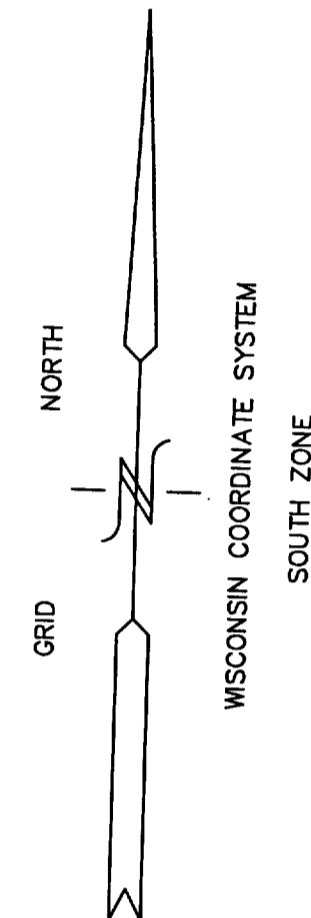

- = FOUND IRON PIPE STAKE 1" DIA.  
● = FOUND IRON REBAR STAKE 3/4"  
▣ = FOUND CONCRETE COUNTY MONUMENT  
⚡ = FOUND SOLID ROUND IRON BAR STAKE 1 5/16"  
( XXX ) = RECORDED AS

NOTE: GENERAL EASEMENT IS A COMBINATION  
OF UTILITY, DRAINAGE, AND WALKWAY EASEMENTS.

NOTE: COPIES OF THIS MAP TO WHICH THE FOLLOWING CERTIFICATE  
WILL APPLY SHOW SURVEYOR'S ORIGINAL  
SEAL AND SIGNATURE IN RED INK. COPIES BY ANY OTHER MEANS  
MAY HAVE ALTERATIONS WHICH DO NOT REPRESENT THE SURVEYOR'S  
WORK PRODUCT.

I HEREBY CERTIFY THAT THE ABOVE DESCRIBED PROPERTY HAS BEEN SURVEYED UNDER MY DIRECTION AND THAT THE ABOVE MAP IS A TRUE REPRESENTATION THEREOF AND SHOWS THE SIZE AND LOCATION OF THE PROPERTY AND ITS EXTERIOR BOUNDARIES. THIS SURVEY IS MADE FOR THE USE OF THE PRESENT OWNERS OF THE PROPERTY, AND ALSO THOSE WHO PURCHASE, MORTGAGE, OR GUARANTEE THE TITLE THERETO WITHIN ONE YEAR FROM THE DATE HEREOF.

DATED: 08/09/02 \_\_\_\_\_

REVISED 02-03-2003  
TO SHOW SIZE & LOCATION OF  
FOUNDATION AS BUILT

PETER S. GORDON R.L.S. 2101

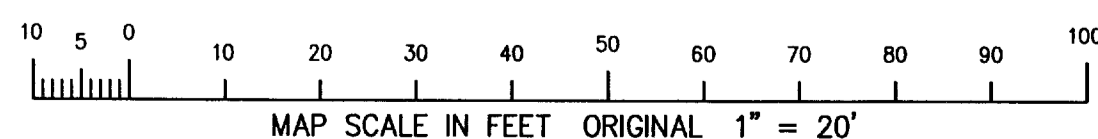

LOT 211 OF LAKEWOOD TRAILS NORTH

LOT 210 OF LAKEWOOD TRAILS NORTH

LOT 201 OF LAKEWOOD TRAILS NORTH

N 68-  
R=1033.00  
MAPLE LANE  
66' WIDE R.O.W.

MAR 28 2003

WLA K-92

011-1723