

ABELL SURVEYING & MAPPING

EDGE OF LANDSCAPE AREA
EXTENDS UP TO 2.7' NORTH
OF LINE

1140 SEQUOIA STREET • DELAVAN, WISCONSIN 53115

262-728-6737

S 89°04'32" E

(S 88°54'47" E 126.00')

125.59'

WOOD

FENCE

12 FOOT WIDE UTILITY EASEMENT

LOT 84

0.52 ACRES

FOREST

66 FEET WIDE

DRIVE

N 2°59'17" W

(N 3°07'26" W 174.91')

174.45'

S 4°30'58" E

LOT 83

161.91' (161.84')

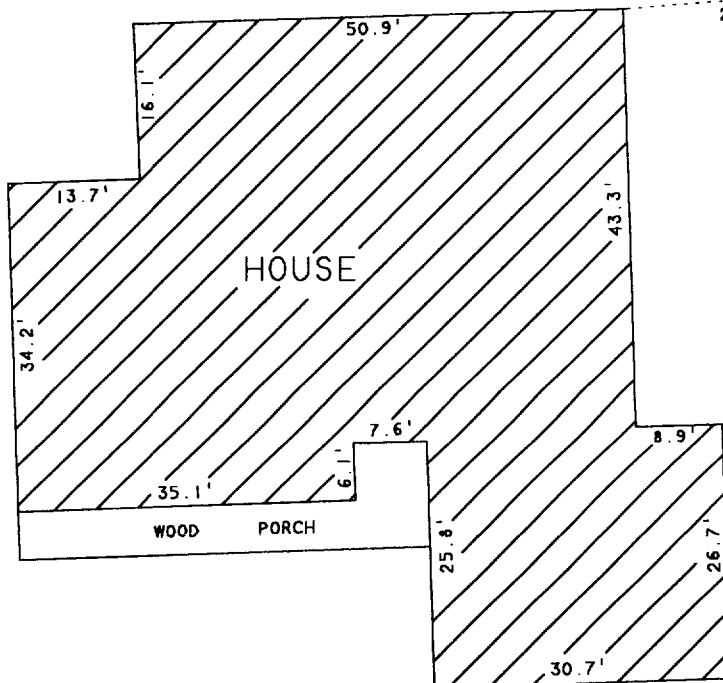

CH=N 52°01'11" W 22.64'
(CH=N 52°12'39" W 22.67')

A=25.66' (25.70')
R=15.00'
A=59.12' (59.11')
R=967.00'
CH=S 76°54'41" W 59.11'
(CH=S 76°57'04" W 59.10')

CH=S 78°07'00" W 54.98'
(CH=S 77°56'47" W 54.91')

PLAT OF SURVEY OF

LOT 84, BAYWOOD ESTATES ADDITION NO. 2,
LOCATED IN THE VILLAGE OF WILLIAMS BAY,
WALWORTH COUNTY, WISCONSIN.

ORDERED BY: CENTURY 21-SKANDIA REALTY
822 E. GENEVA STREET
DELAVAN, WI 53115

NOTE: BEARINGS ARE REFERENCED TO THE
RECORDED SUBDIVISION PLAT.

N



SCALE 1"=20'

LEGEND

- - IRON ROD FOUND
- - IRON BAR FOUND
- - UTILITY PEDS
- () - RECORDED AS

I HEREBY CERTIFY THAT I HAVE SURVEYED THE ABOVE DESCRIBED PROPERTY AND THAT THE ABOVE MAP IS A TRUE REPRESENTATION THEREOF AND SHOWS THE SIZE AND LOCATION OF THE PROPERTY, ITS EXTERIOR BOUNDARIES, THE LOCATION OF ALL VISIBLE STRUCTURES AND DIMENSIONS OF ALL PRINCIPAL BUILDINGS THEREON, BOUNDARY FENCES, APPARENT EASEMENTS, ROADWAYS AND VISIBLE ENCROACHMENTS, IF ANY, TO THE BEST OF MY KNOWLEDGE AND BELIEF.

THIS SURVEY IS MADE FOR THE USE OF THE PRESENT OWNERS OF THE PROPERTY, AND ALSO THOSE WHO PURCHASE, MORTGAGE, OR GUARANTEE THE TITLE THERETO WITHIN ONE (1) YEAR FROM DATE HEREON.

David F. Abell

DAVID F. ABELL
WISCONSIN REGISTERED LAND SURVEYOR, S-1596

September 24, 2002

DATE: JOB NUMBER - 02139
NOTE: THIS IS NOT A CERTIFIED COPY UNLESS SEALED.

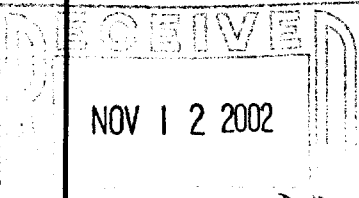

WBW2-35

011-1694