

ABERNATHY and ASSOCIATES

Kenneth B. Abernathy Jr.

Wisconsin Registered Land Surveyor S-1594

Rt. 3, Box 273
Elkhorn, Wisconsin 53121
Phone: (414) 723-4260 (office)
(414) 723-7209 (FAX)

PLAT OF SURVEY

LOT 2 OF BLOCK 7
LAKEWOOD TRAILS SUBDIVISION

LOCATED IN THE NE 1/4 AND THE NW 1/4 OF THE NW 1/4 OF SECTION 1,
TOWN 1 NORTH, RANGE 16 EAST,
VILLAGE OF WILLIAMS BAY, WALWORTH
COUNTY, WISCONSIN.

Ordered by: Christopher Hummel
Hummel Construction
N1958 County Road "O"
Delavan, Wisconsin

53184

Owners: Jim and Dawn Colquhoun
47 Johnson Terrace
Williams Bay, WI. 53191

B L O C K

7

2

15,857 SQ. FT.

EXISTING
RESIDENCE
FOUNDATION LOCATED 8/13/01

HAWTHORNE DRIVE
66' WIDE

PLATTED NORTH

SCALE 1" = 20 FEET

Legend

- FOUND IRON PIPE
- FOUND IRON ROD
- FOUND BRASS CAPPED MONUMENT
- FOUND CONCRETE MONUMENT
- CHISEL CUT IN CONCRETE
- SET IRON ROD, 24" LONG, WEIGHING 1.5 LBS. LINEAL FT. 1 1/4" DIA
- SET IRON ROD, 30" LONG, WEIGHING 4.5 LBS. LINEAL FT. 1 1/4" DIA
- (X) RECORDED AS DIMENSION
- X---X--- EXISTING FENCE

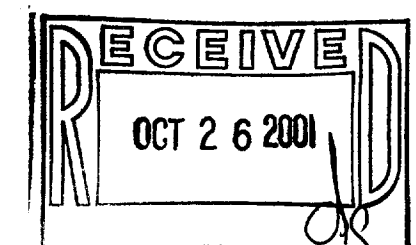

SCALE: 1" = 20 FEET

REVISED 8/29/01 TO SHOW NEW
STREET TIE
BUILDER TO CUT 4" OFF FRONT WALL TO MEET
SETBACK

Kenneth B. Abernathy, Jr.
WISCONSIN REGISTERED LAND SURVEYOR,
S-1594

Date: Aug. 14, 2001 Job No. 01605

WLAK-109 011-1581

ABERNATHY and ASSOCIATES

Kenneth B. Abernathy Jr.

Wisconsin Registered Land Surveyor S-1594

Rt. 3, Box 273
Elkhorn, Wisconsin 53121
Phone: (414) 723-4260 (office)
(414) 723-7209 (FAX)

PLAT OF SURVEY

LOT 2 OF BLOCK 7
LAKEWOOD TRAILS SUBDIVISION

LOCATED IN THE NE 1/4 AND THE NW 1/4 OF THE NW 1/4 OF SECTION 1,
TOWN 1 NORTH, RANGE 16 EAST,
VILLAGE OF WILLIAMS BAY, WALWORTH COUNTY, WISCONSIN.

Ordered by: Christopher Hummel
Hummel Construction
N1958 County Road "O"
Delavan, Wisconsin

53184

Owners: Jim and Dawn Colquhoun
47 Johnson Terrace
Williams Bay, WI. 53191

B L O C K

7

2
15,857 SQ. FT.

EXISTING
RESIDENCE
FOUNDATION LOCATED 8/13/01

HAWTHORNE DRIVE
66' WIDE

PLATTED NORTH

SCALE 1" = 20 FEET

Legend

- FOUND IRON PIPE
- FOUND IRON ROD
- FOUND BRASS CAPPED MONUMENT
- FOUND CONCRETE MONUMENT
- CHISEL CUT IN CONCRETE
- SET IRON ROD, 24" LONG, WEIGHING 1.5 LBS., LINEAL FT., 3/4" DIA.
- SET IRON ROD, 30" LONG, WEIGHING 4.5 LBS., LINEAL FT., 1-11/16" DIA.
- (XX) RECORDED AS DIMENSION
- - - - - EXISTING FENCE

SCALE: 1" = 20 FEET

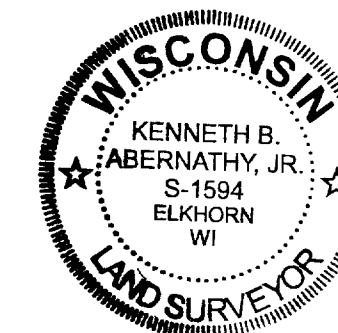

"I hereby certify that the above described property has been surveyed by me in under my direction and that the above map is a true representation thereof and shows the size and location of the property, its external boundaries, the location of all visible structures and dimensions of all principal buildings thereon, boundary fences, apparent easements, roadways and visible encroachments, if any."

"This survey is made for the use of the present owners of the property, and also those who purchase, mortgage, or guarantee the title thereto within one year from date hereof."

Kenneth B. Abernathy, Jr.
WISCONSIN REGISTERED LAND SURVEYOR,
S-1594

Date: Aug. 14, 2001 Job No. 01.605

WLAK-109