

PLAT OF SURVEY

R I P A R I A N Z O N E S U R V E Y

THE WESTERLY 75 FEET OF LOT 8 OF GRAND TERRACE SUBDIVISION, LOCATED IN SECTION 1, TOWN 1 NORTH, RANGE 16 EAST, VILLAGE OF WILLIAMS BAY, WALWORTH COUNTY, WISCONSIN.

ORDERED BY: THOMAS NEWMAN ET. AL.
P.O. BOX 564
WHEATON, IL. 60189-0564

SURVEYOR'S SUMMARY:

13 field observations were taken on Oct. 20, 1999 to locate the shoreline of Geneva Lake from the Southwest corner of Lot 1 of Williams's Subdivision to the southeast corner of the Easterly 25 feet of Lot 8 of the Grand Terrace Subdivision. The property lines for the subject properties were computed and extended to the Ordinary High Water Mark (OHWM) for Geneva Lake. Chords were then computed from these shoreline points which inturn created an angle $\triangle ABC$ with a value of $188^{\circ}29'48''$, the vertex of which is the shoreline point "B" common to Lot 1 to the west and the westerly 75 feet of Lot 8. This angle was then bisected creating a value of $94^{\circ}14'54''$ and this bearing $S 28^{\circ}30'49'' E$ was extended into the lake to graphically show its relationship to the existing piers for these 2 properties. The Alternate method of extending the property line which results in the bearing $S 31^{\circ}00'00'' E$ is also shown.

Also chords were computed from these shoreline points which inturn created an angle $\triangle BCD$ with a value of $184^{\circ}54'50''$, the vertex of which is the shoreline point "C" common to the Westerly 75 feet of Lot 8 and the Easterly 25 feet of Lot 8. This angle was then bisected creating a value of $92^{\circ}27'25''$ and this bearing $S 35^{\circ}13'08'' E$ was extended into the lake to graphically show its relationship to the existing piers for these 2 properties. The Alternate method of extending the property line which results in the bearing $S 31^{\circ}00'32'' E$ is also shown. Ties were then computed to show the extent of pier encroachment based on the "Knitter Method".

WESTERLY 75 FEET
LOT 8
GRAND TERRACE SUBDIVISION
W G T - 6

EASTERLY 25 FEET
LOT 8
GRAND TERRACE
SUBDIVISION
W G T - 7

LOT 1
Wm. G. WILLIAMSON'S
SUBDIVISION
W W - 1

GENEVA LAKE

SCALE 1" = 10 FEET

BASIS FOR BEARINGS

BEARINGS ARE BASED ON A PREVIOUS PLAT OF SURVEY PREPARED BY HAROLD H. KOLB DATED FEBRUARY 28, 1969 AND ASSUMES THE WEST LINE OF THE SUBJECT PROPERTY TO BEAR N $31^{\circ}00'00''$ W.

Legend

- FOUND IRON PIPE
- FOUND IRON ROD
- FOUND BRASS CAPPED MONUMENT
- FOUND CONCRETE MONUMENT
- CHISEL CUT IN CONCRETE
- SET IRON ROD, 24" LONG, WEIGHING 1.5 LBS./LINEAL FT., 3/4" DIA.
- SET IRON ROD, 30" LONG, WEIGHING 4.5 LBS./LINEAL FT., 1-1/8" DIA.
- RECORDED AS DIMENSION
- EXISTING FENCE

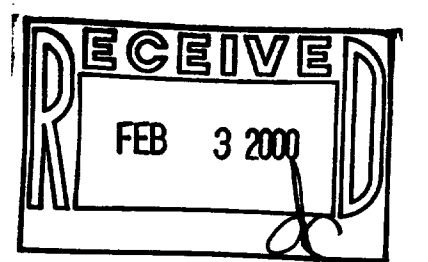

SCALE: 1" = 10 FEET

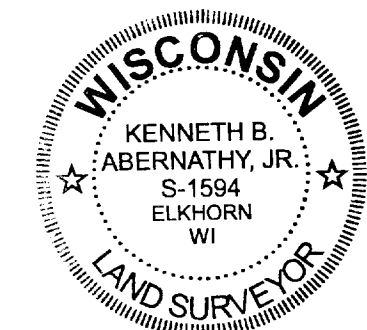

KENNETH B. ABERNATHY, JR.
WISCONSIN REGISTERED LAND SURVEYOR,
S-1594

Date: DECEMBER 13, 1999 Job No. 79-1006

WW-1
WGT-6
WGT-7
011-1420