

FARRIS, HANSEN & ASSOCIATES, INC.  
 ENGINEERING, ARCHITECTURE, SURVEYING  
 7 RIDGWAY COURT - P.O. BOX 437, ELKHORN, WISCONSIN 53121  
 PHONE: (414) 723-2098 FAX: (414) 723-5886

PLAT OF SURVEY

LOCATION AND LEGAL DESCRIPTION

LOT 1 OF CERTIFIED SURVEY MAP NO. 2186, RECORDED IN VOL. 10 ON PG. 268, AS DOCUMENT NO. 238771; LOCATED IN THE SE 1/4 OF THE NW 1/4 OF SECTION 1, TOWN 1 NORTH, RANGE 16 EAST, VILLAGE OF WILLIAMS BAY, WALWORTH COUNTY, WISCONSIN

WORK ORDERED BY: MAUREEN ANDRICH  
 RAULAND AGENCY  
 P.O. BOX 159  
 WALWORTH, WI. 53184

LOT 75

BAYWOOD HEIGHTS SUBDIVISION

ADD. NO. 2

20' DRAINAGE EASEMENT

N 89° 58' 21" E 125.15'  
 (EAST 125.00')

15' SIDE YARD

LOT 1

30' REAR YARD

30' STREET YARD

SMYTHE DRIVE

N 00° 05' 18" W 100.00'

S 00° 00' E 100.00'

S 89° 58' 21" W 125.00'

LOT 2

15' SIDE YARD

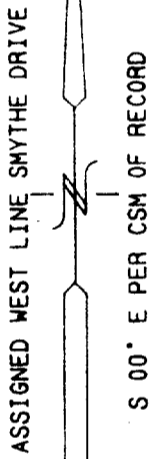

LOT 72

LEGEND

- = FOUND IRON REBAR STAKE
- RECORDED AS

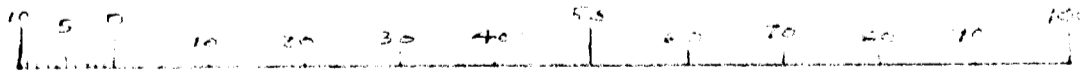

MAP SCALE IN FEET ORIGINAL 1" = 20'

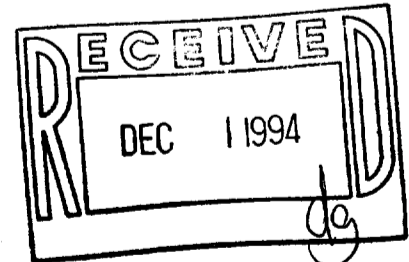

NOTE: COPIES OF THIS MAP TO WHICH THE FOLLOWING CERTIFICATE WILL APPLY ARE BLUE LINE PRINTS SHOWING SURVEYOR'S ORIGINAL SEAL AND SIGNATURE IN BLACK INK. COPIES BY ANY OTHER MEANS MAY HAVE ALTERATIONS WHICH DO NOT REPRESENT THE SURVEYOR'S WORK PRODUCT.

I HEREBY CERTIFY THAT THE ABOVE DESCRIBED PROPERTY HAS BEEN SURVEYED UNDER MY DIRECTION AND THAT THE ABOVE MAP IS A TRUE REPRESENTATION THEREOF AND SHOWS THE SIZE AND LOCATION OF THE PROPERTY AND ITS EXTERIOR BOUNDARIES. THIS SURVEY IS MADE FOR THE USE OF THE PRESENT OWNERS OF THE PROPERTY AND SO THOSE WHO PURCHASE, MORTGAGE, OR GUARANTEE THE TITLE THERETO WITHIN ONE YEAR FROM THE DATE HEREOF.

DATED: 10/13/1994

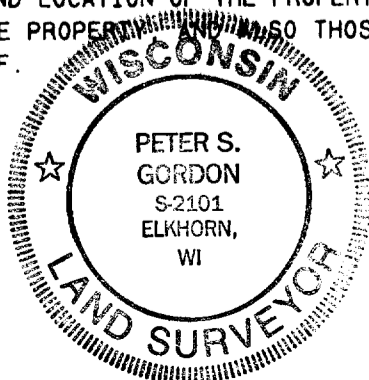

*Peter S. Gordon*

PROJ 3542.93.94

SHEET 1 OF 1

WA-2186-1

11-1076