

LAND-MARK SURVEYING

Mark L. Miritz

Wisconsin Professional Land Surveyor S-2582

N9330 Knuteson Drive
Whitewater, WI 53190

Phone: (262) 495-3284

MARKMIRITZ@

LAND-MARKSURVEYING.COM

PLAT OF SURVEY

LOT 2, BLOCK 1, CORYDON PRATT'S ADDITION
TO THE VILLAGE (NOW CITY) OF WHITEWATER,
LOCATED IN THE SOUTHWEST 1/4 OF THE
NORTHWEST 1/4 OF SECTION 3, TOWN 4 NORTH,
RANGE 15 EAST, CITY OF WHITEWATER,
WALWORTH COUNTY, WISCONSIN.

OWNERS:
MICHAEL J. SINA
ELIZABETH A. SINA
327 N. NEWCOMB ST.
WHITEWATER, WI 53190

LOT 1

LOT 2

34,770 SQ. FT. LESS
RIGHT-OF-WAY

IMPROVEMENTS NOT LOCATED

LOT 3

EAST CRAVATH STREET
(49.5' WIDE)

VACATED

UNIMPROVED

N. QUEEN ST.
(49.5' WIDE)

NORTHWEST CORNER
SECTION 3-4-15

1932.54'

5.30'

24.75'

2.95'

125.02'

5.23'

24.75'

3.02'

N 00°28'53" W 2707.77'

650.21'

WEST 1/4 CORNER
SECTION 3-4-15

(66' WIDE)
NORTH NEWCOMB ST.

CENTER LINE N 00°30'48" W

THE EAST LINE OF N. NEWCOMB ST. WAS PLATTED 24.75' FROM THE SECTION LINE. THE RECONSTRUCTION
OF N. NEWCOMB (STATE HWY PLANS 3113-00-70 & 71) EXPANDED THE RIGHT-OF-WAY TO 33' FROM THE
CENTERLINE (NOT THE SAME AS SECTION LINE).

N 88°24'44" E 278.21'
(281.16')

N 00°30'48" W 125.02'

N 00°30'48" W 125.02'

FOUND ADDITIONAL ROD
N 58°25'04" E 2.43'

114.15'

113.33'

S 88°24'44" W 278.14'
(281.16')

89.00'

N 88°24'44" E

89.00'

S 00°28'53" E 125.02'
123.02'

FENCE 1.9' N. OF LINE

FENCE 1.5' N. OF LINE

74.99'

S 00°08'29" E 125.02'

75.73'

Horizontal Datum is based on the
Wisconsin State Plane Coordinate
System Grid, South Zone, North
American Datum of 1927, all
bearings are referred to Grid
North.

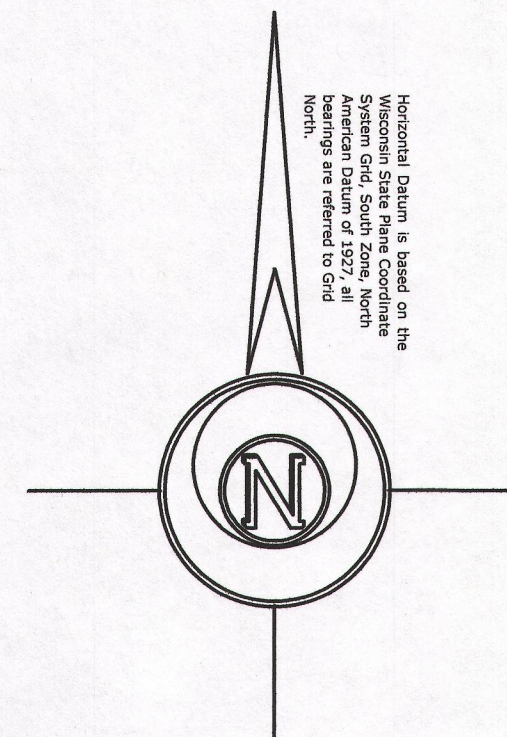

LEGEND

- FOUND CUT CROSS
- FOUND IRON ROD
- FOUND COUNTY MONUMENT
- SET IRON ROD, 18" LONG, WEIGHING
1.5 LBS./LINEAL FT., 3/4" DIA.
- (x x) RECORDED AS DIMENSION
- x - EXISTING FENCE

SCALE: 1 INCH = 40 FEET

"I hereby certify that the above described property
has been surveyed by me or under my direction in
full compliance with the owner's/agent's instructions
and Chapter A-E 7 of the Wisconsin Administrative Code
"Minimum Standards for property surveys"; that the above
map is correct to the best of my knowledge and belief."

Mark L. Miritz
MARK L. MIRITZ
WISCONSIN PROFESSIONAL
LAND SURVEYOR S-2582

DATE: DEC. 3, 2014 JOB NO. 14.1105

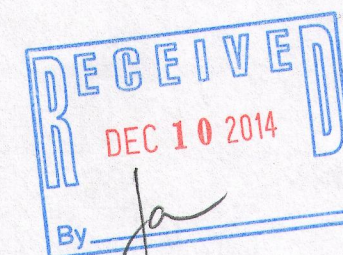

1pc -2

010-962