

Plat of Survey

of Lot 7 in Block 11 of Tripp's Second Addition,

a subdivision located in the Southeast 1/4 of Section 4, Town 4 North, Range 15 East,
City of Whitewater, Walworth County, Wisconsin.

Tax Parcel /TRA 00067

A parcel of land described in a Warranty Deed recorded December 7, 2010 as Document No. 804542 as shown below:

Lot Seven (7) in Block Eleven (11) of Tripp's Second Addition to the Village, now City of Whitewater, excepting that portion thereof conveyed to Joseph Channing by Deed dated April 10, 1940, and recorded April 12, 1940 in Volume 264, Page 307 of Deeds, Walworth County, Wisconsin, records; and described as follows: Beginning at a point on the West line of Lot 7 Block 11 of Tripp's Second Addition to the Village, now City of Whitewater, 200 feet South of the Northwest corner of said lot, running thence East parallel with the North line of said lot 41-1/4 feet, thence South parallel with the West line of said lot to the South line thereof, thence westerly along the South line of said lot to the Southwest corner thereof, thence North along the West line of said lot to the place of beginning; together with a right of way 12 feet in width over and along the West side of said Lot 7 from the South side of Clay Street in said City of Whitewater to the North line of the land above described and conveyed.

Tax Parcel /TRA 00067A

A parcel of land described in a Warranty Deed recorded April 23, 2010 as Document No. 787319 as shown below:

Part of Lot 7, Block 11 of Tripp's Second Addition to the Village, now City of Whitewater, Walworth County, Wisconsin being more fully described as: Beginning at a point on the West line of Lot 7 Block 11 of Tripp's Second Addition to the Village, now City of Whitewater, 200 feet South of the Northwest corner of said lot, running thence East parallel with the North line of said lot 41-1/4 feet, thence South parallel with the West line of said lot to the South line thereof, thence westerly along the South line of said lot to the Southwest corner thereof, thence North along the West line of said lot to the place of beginning; together with a right of way 12 feet in width over and along the West side of said Lot 7 from the South side of Clay Street in said City of Whitewater to the North line of the land above described and conveyed.

Surveyed for: **Phillip Roden**
2111 Noyes
Evanston, Illinois. 60201

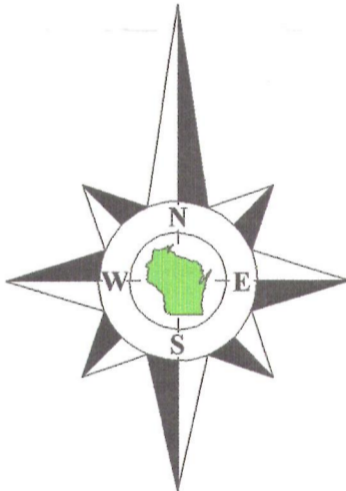

Bearings reference to previous
surveys of record.

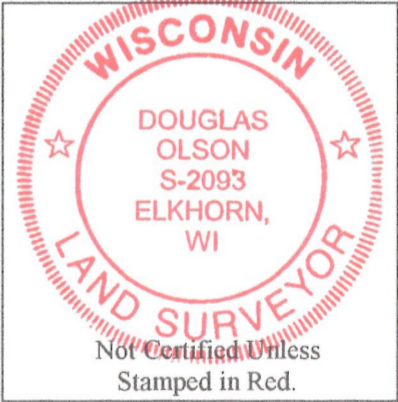

Notes:

- 1) This survey plat is not certified unless signed and sealed in red ink.
- 2) This survey is subject to Wisconsin lien laws. This Plat of Survey is the notice of intent to file lien. Lien waiver required.

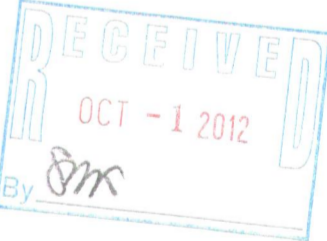

Copyright 2012 by Jensen & Olson Land Surveying, LLC.

All rights reserved. No part of this survey plat may be reproduced or transmitted in any form by any means - graphic, electronic, or mechanical, including photocopying, tracing, or information storage and retrieval systems - without permission in writing from Douglas G. Olson, Jensen & Olson Land Surveying, LLC.

I, Douglas G. Olson, Wisconsin Registered Land Surveyor, do hereby certify that this survey was performed by me, or under my direction in full compliance with the owner's/agent's instructions and Chapter A-E 7 of the Wisconsin Administrative Code "Minimum Standards for Property Surveys"; and that this map is an accurate representation thereof to the best of my knowledge and belief.

Douglas G. Olson
Wisconsin Registered Land Surveyor - 2093