

WHITENA

WEST 1/4 SECTION CORNER
SECTION 5, T4N R15E

EAST - WEST 1/4 LINE SEC 5

U.S. HWY No. 12

N 87-42° E 1024.40

MAIN STREET

991.37

AREA = 8.05 ACRES

CORPORATE LIMITS NORTH
WEST LINE SECTION 5, T4N R15E
3424.6
3094.3

178.96

254.63

273.98

263.80

N 87-42° E 1024.40

3074.3

NORTH 342.46

330.9

ELIZABETH STREET

66'

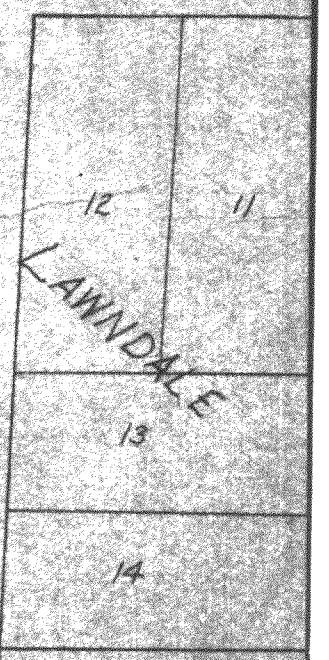

N

o - IRON PIPE

PLAT OF SURVEY

OF
PART OF NW 1/4 SW 1/4
SECTION 5, T4N R15E
LOCATED IN THE
CITY OF WHITWATER
WALWORTH COUNTY, WISCONSIN

Lloyd L. Jensen
SURVEYOR

UP-219

10-87-J

SCALE 1" = 80'

DATE MARCH 1954