

Plat of Survey

of

A parcel of land described in a Warranty Deed recorded December 28, 2005 as Document No. 663976 as shown below:

Lots 4 and 5 in Block 4 of Tripp's Second Addition to the Village, now City of Whitewater, Walworth County, Wisconsin, excepting however from Lot 4 a parcel of land beginning at the NE corner of said Lot 4. Thence S. 79°35'W. along the N. line of said Lot 86 feet, thence S. to a point which is 10 feet South of the North line of said Lot 4; thence E. parallel to the N. line of said Lot 4 to the E. line thereof, thence N. 14°15'W. along the E. line of said lot to the place of beginning.

Surveyed for: **Lucille Shroble**
238 South Wisconsin Street
Whitewater, Wisconsin. 53190

Lot 3

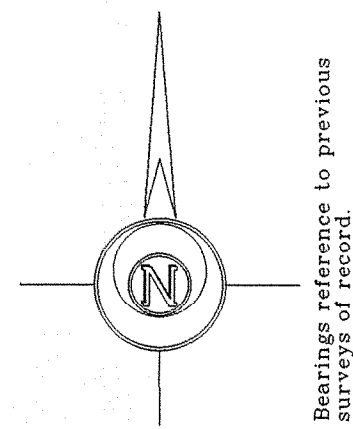

Cravath

Lake

East Milwaukee Street

Wisconsin Street
(66' Wide)

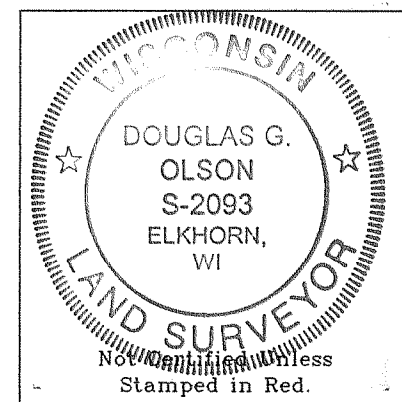
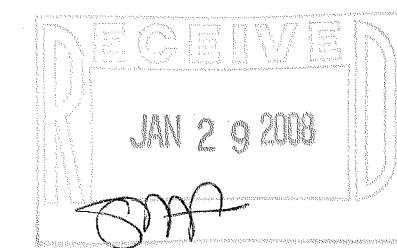

Notes: 1) This survey plat is not certified unless signed and sealed in red ink.

2) This survey is subject to Wisconsin lien laws. This Plat of Survey is the notice of intent to file lien. Lien waiver required.

Copyright © 2007 by Jensen & Olson Land Surveying, LLC.

All rights reserved. No part of this survey plat may be reproduced or transmitted in any form by any means - graphic, electronic, or mechanical, including photocopying, tracing, or information storage and retrieval systems - without permission in writing from Douglas G. Olson, Jensen & Olson Land Surveying, LLC.

I, Douglas G. Olson, Wisconsin Registered Land Surveyor, do hereby certify that this survey was performed by me or under my direction in full compliance with the owner's/agent's instructions and Chapter A-E 7 of the Wisconsin Administrative Code "Minimum Standards for Property Surveys"; and that this map is an accurate representation thereof to the best of my knowledge and belief.

Douglas G. Olson
Wisconsin Registered Land Surveyor - 2093

Survey Date: October 5, 2007.
Revisions:

Scale in Feet
1" = 20'



Jensen & Olson Land Surveying, LLC
45 South Wisconsin Street P.O. Box 322
Elkhorn, Wisconsin. 53121
Telephone (262) 723-3434
Facsimile (262) 723-8044

Legend
Found Iron Pipe
Found Iron Rod
Set Iron Rod 3/4" dia.
Recorded Information
Utility Pole
Light Pole
Manhole
Concrete Surface
Gravel Surface

Sheet 1 of 1 Sheets
Job Reference Number
2007.131

2007.131

TRA-39

010-845