

- LEGEND**
- These standard symbols will be found in the drawing:
- LIGHT POLE
 - POWER POLE
 - GUY
 - TELEPHONE PEDESTAL
 - ELECTRICAL BOX
 - TELEPHONE MANHOLE
 - SANITARY MANHOLE
 - STORM MANHOLE
 - UTILITY MANHOLE
 - CATCH BASIN
 - WATER VALVE
 - HYDRANT
 - IRON PIPE FOUND
 - IRON BAR FOUND
 - COMPUTED PROPERTY CORNER
 - FENCE
 - SANITARY SEWER
 - STORM SEWER
 - POWER OVERHEAD
 - BURIED ELECTRIC
 - BURIED GAS
 - BURIED TELEPHONE
 - WATERMAIN
 - FIBER OPTIC'S
 - EDGE OF BIUMINOUS
 - FLAG POLE
 - TREE
 - PINE TREE
 - BUSH/SHRUB
 - ELECTRIC METER
 - GAS METER
 - GAS VALVE
 - SPIT ELEVATION
 - URN
 - SPIKE/PK. NAIL
 - HEDGE
 - FLAG, FLAG/P.
 - FLAG EQUIPMENT
 - GUARD POST
 - BENCH
 - TRASH CAN
 - BASKETBALL HOOP
 - SOL. BARRIC.
 - CATCH BASIN

UNDERGROUND UTILITIES

THESE RECORD DRAWINGS HAVE BEEN PREPARED, IN PART, ON THE BASIS OF INFORMATION OBTAINED AND FURNISHED BY OTHERS. THE SURVEYOR AND ARCHITECT WILL NOT BE RESPONSIBLE FOR ANY ERRORS OR OMISSIONS WHICH HAVE BEEN INCORPORATED INTO THIS DOCUMENT AS A RESULT. SOME UTILITIES HAVE BEEN LOCATED BY MAPS FURNISHED BY OTHERS - LOCATIONS ARE APPROXIMATE.

FORMER UTILITIES MAY EXIST BUT ARE NOT SHOWN ON MAP. CONTACT DIGGERS HOTLINE FOR LOCATIONS.

FIELD VERIFY SANITARY AND STORM SEWER PIPE SIZE AND PIPE LOCATION.

UNDERGROUND UTILITIES SHOWN ON THIS MAP ARE BASED IN PART ON MARKINGS BY DIGGERS' HOTLINE (TICKET #1869950).

DESCRIPTION

LOCATED IN PART OF THE SOUTHWEST 1/4 OF SECTION 5, TOWNSHIP 4 NORTH, RANGE 115 EAST, CITY OF WHITEWATER, WASHINGTON COUNTY, WISCONSIN.

SURVEYOR'S CERTIFICATE

I, SCOTT GROHOLSKI, REGISTERED LAND SURVEYOR DO HEREBY CERTIFY THAT THIS IS A TRUE AND CORRECT COPY OF A TRIMMED/REPRODUCTION AS MADE BY ME ON 7/26/99.

DATED THIS _____ DAY OF _____

SCOTT GROHOLSKI # 22813
REGISTERED LAND SURVEYOR

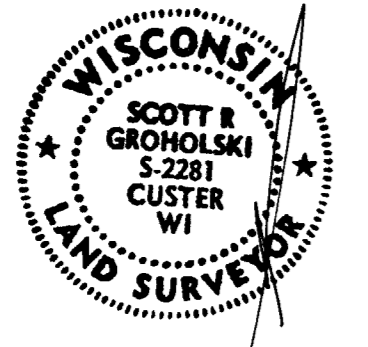

BENCH MARK

ELEVATIONS BASED ON DATUM RECEIVED FROM CITY OF WHITEWATER (ELEVATION 541.1) CITY OF WHITEWATER, WI.

TIP OF HIGH POINT, LOCATED AT THE INTERSECTION OF ELIZABETH STREET AND CONIST STREET, ON THE EAST SIDE OF ELIZABETH STREET. ELEVATION = 578.23.

SOUTH CORNER OF FLAGPOLE BASE, LOCATED AT THE SOUTH SIDE OF WHITEWATER MIDDLE SCHOOL. ELEVATION = 571.33.

SURVEYORS NOTE

FEATURES THAT MAY EXIST IN COURTYARD AREA OF LINCOLN ELEMENTARY SCHOOL MUST BE VERIFIED BY OWNER. SURVEYOR WAS UNABLE TO LOCATE ANY FEATURES THAT MAY EXIST DUE TO THICK BRUSH AND SHRUBBERY.

DEED LINE AND POSSESSION LINE DO NOT MATCH. CALL SCOTT GROHOLSKI AT RETTLER CORPORATION WITH ANY QUESTIONS.

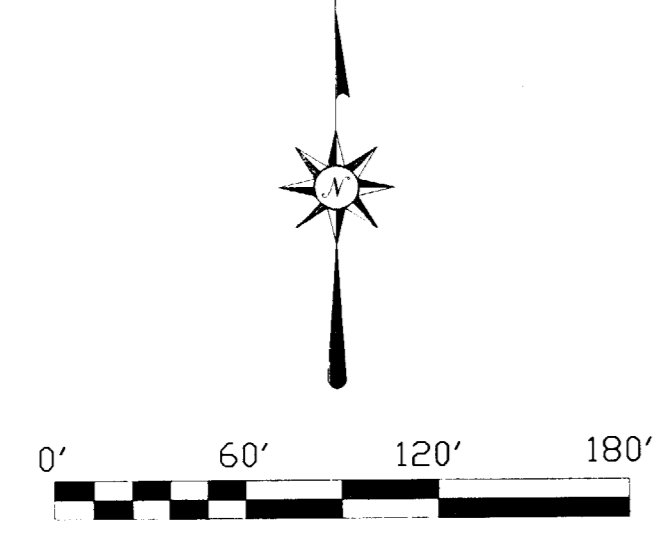

RECEIVED
FEB 2 8 2001

REVISIONS

DATE	BY	DESCRIPTION
8/30/99		
9/29/99		
10/20/99		

DATE: 8/17/99
 DRAWN: BRAD PLATKO
 CHECKED: SCOTT GROHOLSKI
 DOCUMENT NO: 99555

LANDSCAPE ARCHITECTURE: PAUL RING
 PLANNING: PAUL RING
 LAND SURVEYING: SCOTT GROHOLSKI
 SEE MAIN DRAWING
 SEE CONCRETE WORK
 SEE MAINTENANCE

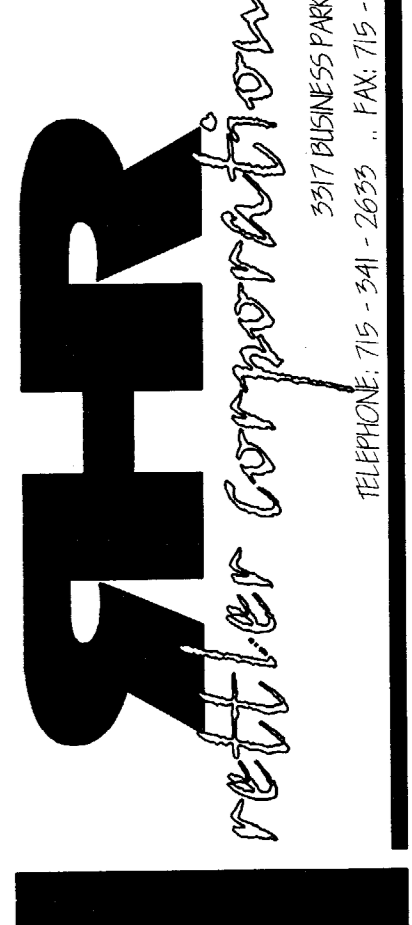

TOPOGRAPHIC MAP

WHITEWATER SCHOOL DISTRICT
 WHITEWATER MIDDLE SCHOOL,
 LINCOLN ELEMENTARY SCHOOL,
 DISTRICT OFFICE

TOPO

Wup-206A 010-663