

KOLB LAND CONSULTING, INC.
LAND SURVEYING • SUBDIVIDING • LAND PLANNING

LAKE GENEVA, WISCONSIN 53147

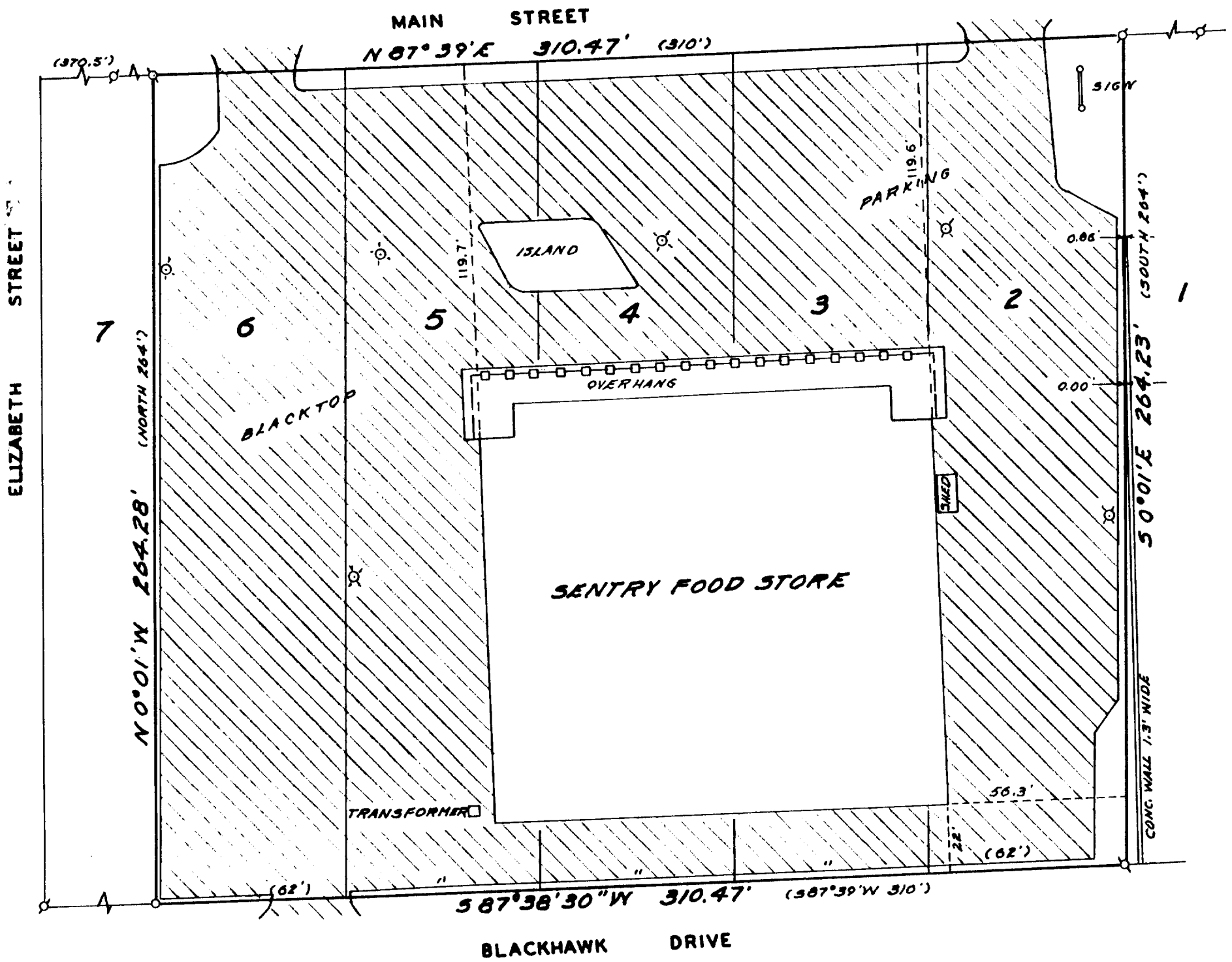

SCALE: 1" = 40'

LEGEND

- ⊕ IRON PIPE FOUND
- ⊙ 1-1/4" X 24" IRON PIPE SET
- ⊙ LIGHT POLE

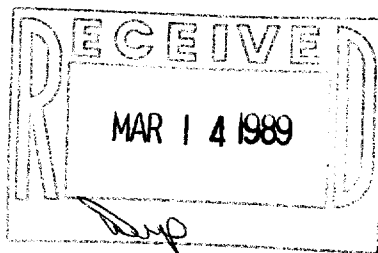

ORDERED BY: MICHEAL TOBIN
9135 W. LISBON
MILWAUKEE, WI. 53222

NOTE: BEARINGS ARE ASSUMED AS SHOWN ON
RECORDED SUBDIVISION PLAT.

I HEREBY CERTIFY THAT I HAVE SURVEYED THE ABOVE DESCRIBED PROPERTY AND THAT THE ABOVE MAP IS A TRUE REPRESENTATION THEREOF AND SHOWS THE SIZE AND LOCATION OF THE PROPERTY, ITS EXTERIOR BOUNDARIES, THE LOCATION OF ALL VISIBLE STRUCTURES AND DIMENSIONS OF ALL PRINCIPAL BUILDINGS THEREON, BOUNDARY FENCES, APPARENT EASEMENTS, ROADWAYS AND VISIBLE ENCROACHMENTS, IF ANY, TO THE BEST OF MY KNOWLEDGE AND BELIEF.

THIS SURVEY IS MADE FOR THE USE OF THE PRESENT OWNERS OF THE PROPERTY, AND ALSO THOSE WHO PURCHASE, MORTGAGE, OR GUARANTEE THE TITLE THERETO WITHIN ONE (1) YEAR FROM THE DATE HEREOF.

SURVEY IS NOT VALID UNLESS SURVEYOR'S SIGNATURE IS IN RED.

HAROLD H. KOLB
WISCONSIN REGISTERED LAND SURVEYOR, S-187
DATE JUNE 3, 1988