

PLAT OF SURVEY

OF A PARCEL OF LAND LOCATED IN THE S.E. 1/4 OF
THE N.W. 1/4 OF SECTION 5 T4N, R15E, CITY OF WHITEWATER,
WALWORTH COUNTY WISCONSIN.

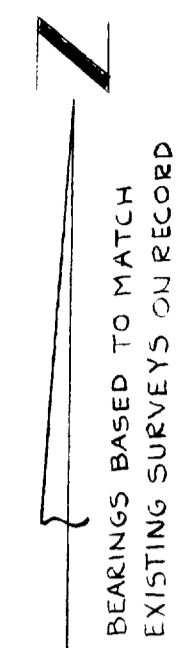

SCALE - 1" = 20'

LEGEND

- IRON PIPE FOUND
- CONCRETE MON. FOUND
- ⊙ IRON ROD FOUND
- ⊙ IRON ROD 3/4" DIA. SET
- ⊕ T BAR FOUND
- ▭ CONCRETE
- ▭ BITUMINOUS CONCRETE
- () RECORDED AS
- F.L. FLOW LINE
- DIRECTION OF FLOW
- ⊕ POINT OF ELEVATION

NOTE 1: IRON PIPE IS FOUND 2.0 WEST AND 0.20 SOUTH OF LINE

NOTE 2: ALL ELEVATIONS BASED ON INFORMATION OBTAINED FROM THE CITY OF WHITEWATER, BRASS PLATE AT THE S.W. CORNER OF CONCRETE TOP OF LIFT STATION AT MAIN ST. AND ELIZABETH ST. = 149.95"

I HEREBY CERTIFY THAT I HAVE SURVEYED THE ABOVE DESCRIBED PARCEL OF LAND AND THAT THE PLAT HEREON DRAWN IS AN ACCURATE SURVEY AND A TRUE REPRESENTATION THEREOF AND CORRECTLY SHOWS THE BOUNDARY LINES OF SAID PROPERTY AND IMPROVEMENTS THEREON.

SURVEYED FOR: PIONEER SAVINGS AND LOAN
SURVEYED BY: THOMAS R. JENSEN S-1084
DRAFTED BY: R.L. MEADOWS APRIL 26, 1981
REVISED 7-2-81
REVISED 7-27-81

JENSEN SURVEYING & MAPPING

P.O. BOX 322
ELKHORN WISC 53121

(414) 723-3434

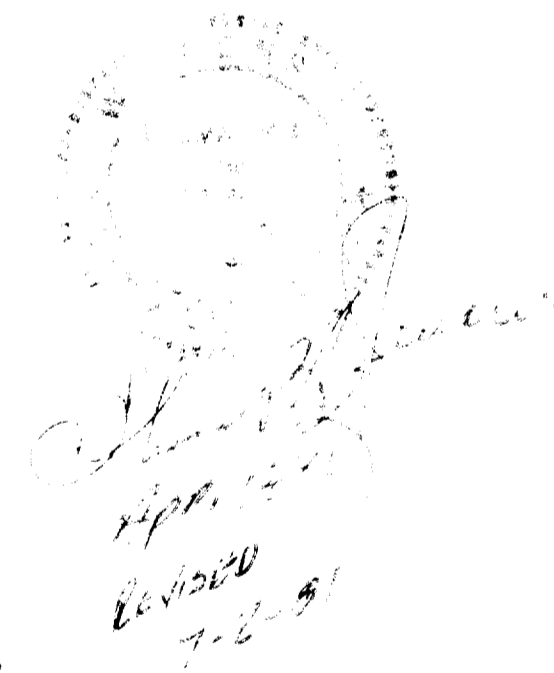

NOTE:
ALL NEW SEWER AND WATER LATERALS MUST BE BUILT FROM THE SEWER LINE IN THE ROAD BACK TO PROPOSED BUILDING, TO CHECK GRADE.

